



INSTALLATION INSTRUCTIONS

Accessory

AUDIO SYSTEM
0SS22-HL6-A00

Application

SXS1000S2R
SXS1000S2X

Publication No.

MII 16561

Issue Date

March 2019

Honda Dealer: Please give a copy of these instructions to your customer.

PARTS LIST

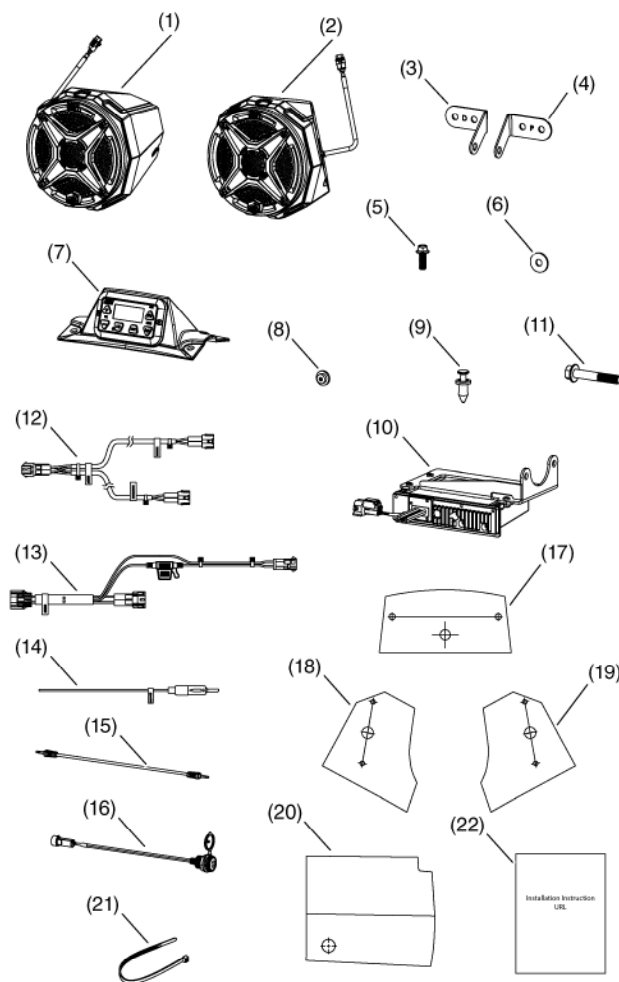

No.	Description	Qty
(1)	Driver Side Speaker Pod	1
(2)	Passenger Side Speaker Pod	1
(3)	Driver Side Speaker Pod Bracket	1
(4)	Passenger Side Speaker Pod Bracket	1
(5)	8 mm Flange Bolt	8
(6)	Washer	8
(7)	Radio Controller w/ Dash Kit	1
(8)	1/8 in Drill guide	4
(9)	Trim Clips	4
(10)	Radio MCU w/ Mounting Bracket	1
(11)	12 mm Flange Bolt	2

No.	Description	Qty
(12)	Speaker Harness	1
(13)	Radio Power Harness	1
(14)	Antenna Cable	1
(15)	3.5 mm Aux Cable	1
(16)	Auxiliary Socket	1
(17)	Radio Controller Cable Drill Template	1
(18)	Driver Speaker Enclosure Drill Template	1
(19)	Passenger Speaker Enclosure Drill Template	1
(20)	Auxiliary Socket Drill Template	1
(21)	8 in Zip Ties	10
(22)	Installation Instructions URL	1

TOOLS REQUIRED

Drill

Torque wrench

Socket (12 mm)

Socket (8 mm)

Drill bit (1/4 in)

Drill bit (1/8 in)

Drill bit (5/16 in)

Drill bit (13/16 in)

Drill bit (9/16 in)

Trim clip removal tool

Pencil

Tape

TORQUE CHART

Tighten all screws, bolts, and nuts to their specified torque values. Refer to the Service Manual for the torque values of the removed parts.

Item	N-m	kgf-m	lbf-ft
8 mm flange bolt	7.8	0.8	5.8
12 mm flange bolt	27	2.8	20

INSTALLATION

⚠ CAUTION

To prevent burns, allow the engine, exhaust system, radiator, etc., to cool before installing the accessory.

1. Remove the hood by first lifting and turning the two hood latches, then lift the hood to remove.

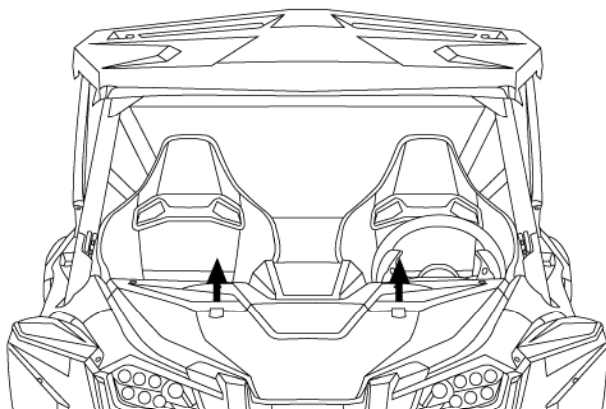

2. Remove the dash trim panel by first removing the five hex head screws (as shown).

<TOP DASH VIEW>

HEX HEAD SCREWS

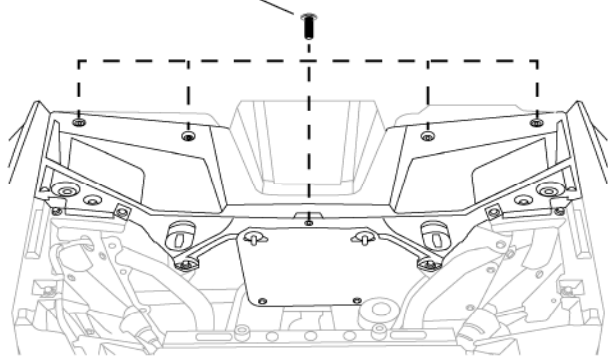

3. Remove the four 10 mm flange bolts (as shown).

10 mm BOLTS

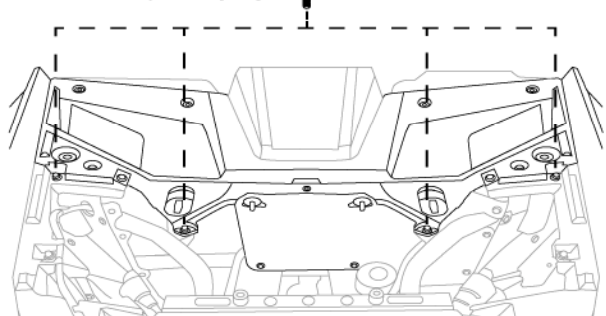

4. Remove the two trim clips (as shown).

TRIM CLIPS

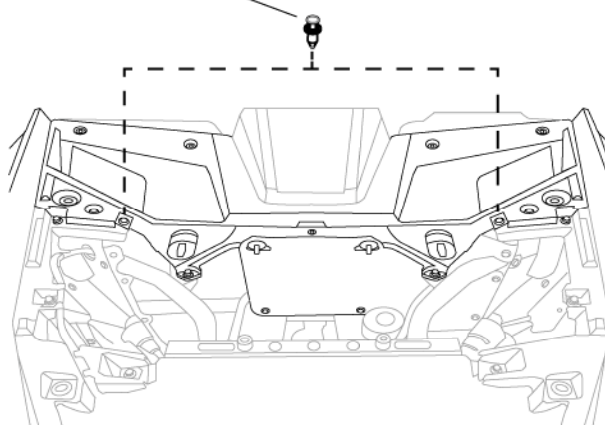

5. Detach the top portion of the rubber splash guard by unhooking it from the two points as shown below.

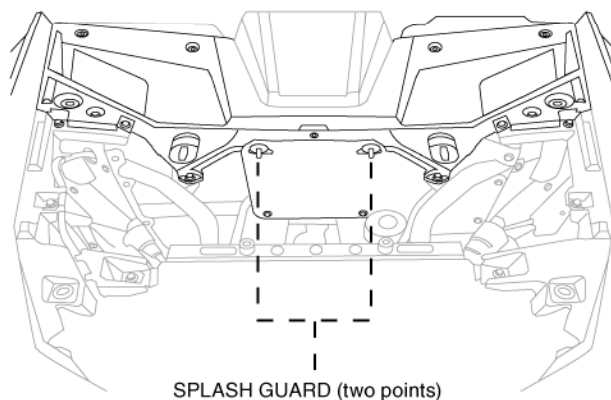

6. Fold down the top portion of the rubber splash guard then remove the dash trim panel.

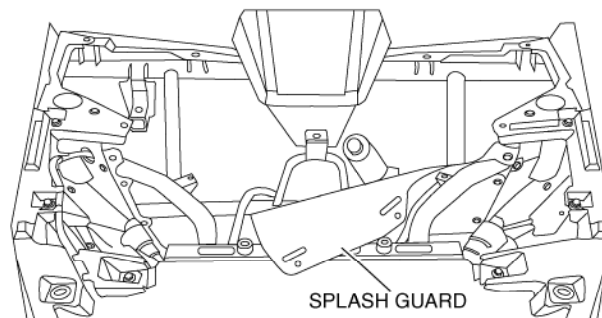

7. Remove the three trim clips from the glovebox.

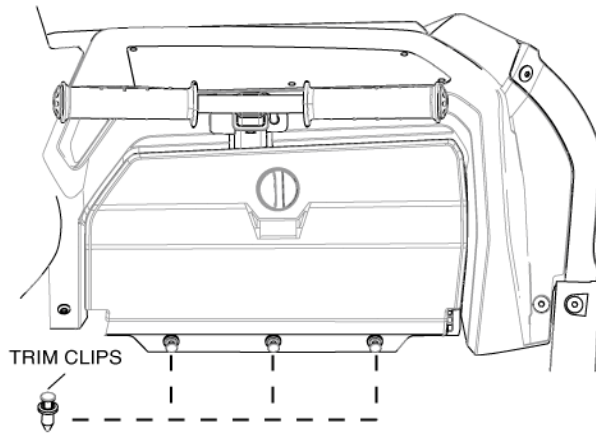

8. Slide the grab handle forward to full extension, open the glovebox and remove two 5 mm hex head screws and one trim clip then remove the glovebox. After the hardware has been removed, pull the glovebox out and away.

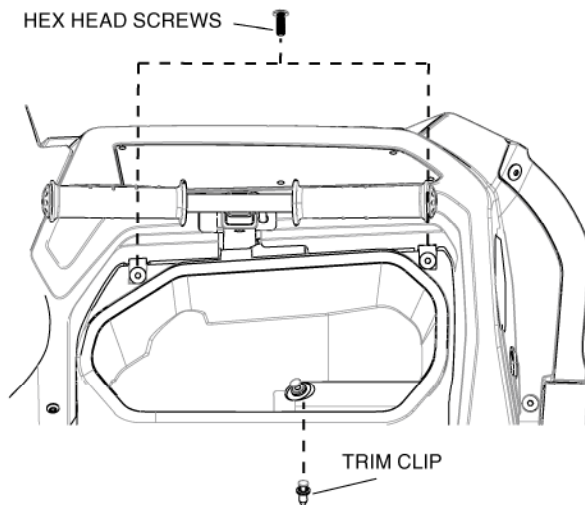

9. Place the auxiliary socket template on the outside of the removed glovebox. Align the template so its edge is flush with the panel nearest the glovebox door (as shown).

- Using a pencil, mark the location of the hole to be drilled for the auxiliary socket.
- Drill a 13/16 in hole at the center of your mark.

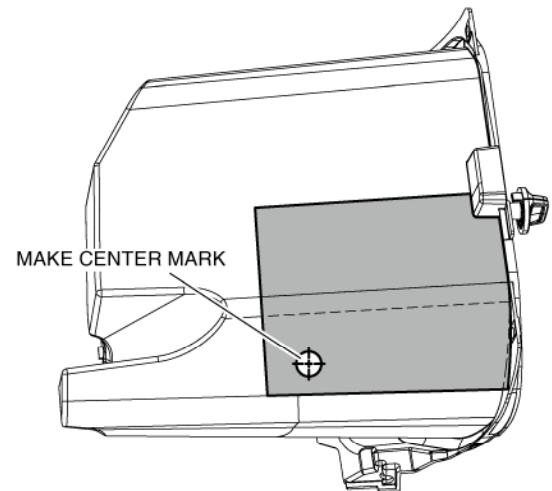

10. Unthread the plastic nut from the auxiliary socket.

From inside the glovebox, route the cable and the threaded end of the auxiliary socket through the drilled hole.

Reinstall the plastic nut onto the auxiliary socket securing it to the glovebox.

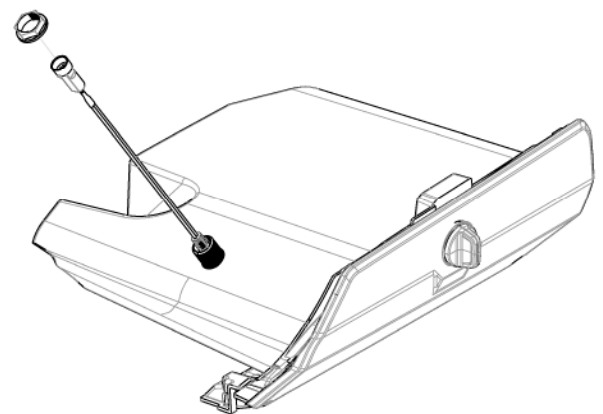

11. Remove the two 12 mm flange bolts from the grab handle (as shown).

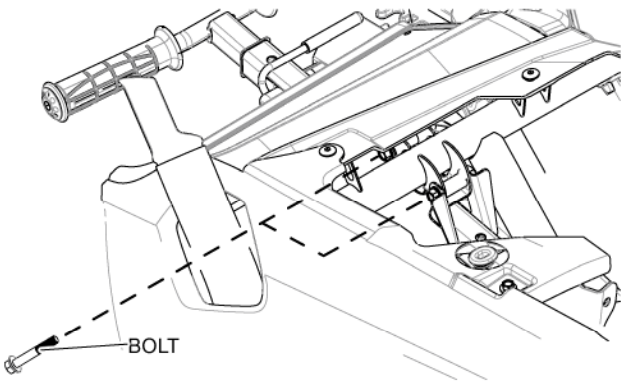

12. Place the radio mcu into the glovebox area. Line up the holes in the radio bracket with the holes in the grab handle bracket. Use the supplied 12 mm flange bolts to attach the radio mcu to the grab handle bracket. Tighten bolts to the specification supplied in the Torque Chart then reinstall the glovebox in the reverse order of removal.

Item	N-m	kgf-m	lbf-ft
12 mm flange bolt	27	2.8	20

NOTE: Be sure to use the new supplied bolts as they are longer than the factory bolts.

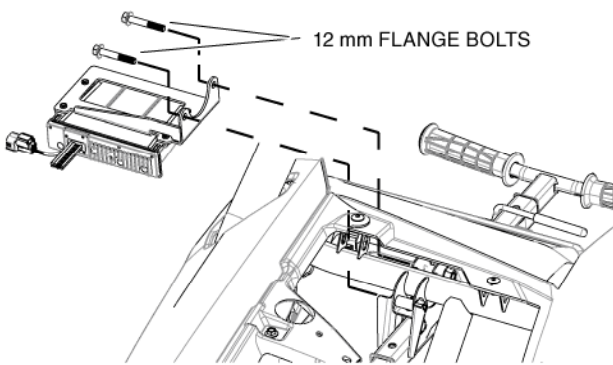

13. Prepare for the following steps by wrapping some tape around the 1/8, 5/16, and 9/16 in drill bits about 1/2 in from the tips (as shown).

NOTICE: The tape is to be used as a depth guide to help avoid damaging parts underneath the drilling area. Do not drill deeper than 1/2 in or past the tape.

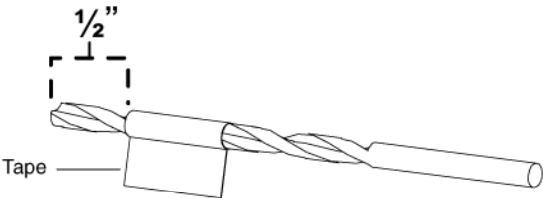

14. Place the radio controller with dash kit on the top of the instrument panel. Make sure the dash kit is resting flush with the face of the instrument panel. Place a 1/8 in drill guide in each hole of the dash kit.

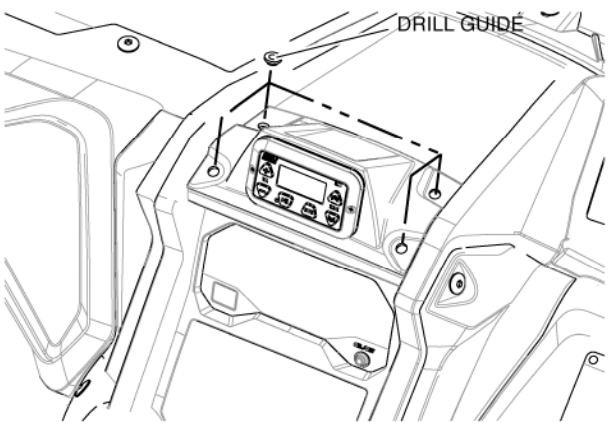

15. Use the drill guides to drill a 1/8 in pilot hole into the instrument panel at the four locations shown.

Next, remove the drill guides along with the radio controller and dash kit, then enlarge the pilot holes using a 5/16 in drill bit.

- Remove any burrs from the edge of the hole using a file.

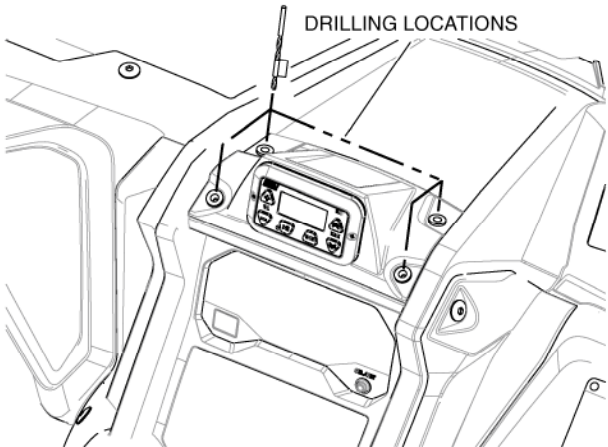

16. Place the radio controller cable drill template on the top of the instrument panel.
 - Make sure the arrow on the template points toward the rear of the vehicle.
 - Line up the two drilled holes nearest the front of the vehicle to the template marks (as shown).
 - Using a pencil, mark the instrument panel where the center mark of the template indicates.

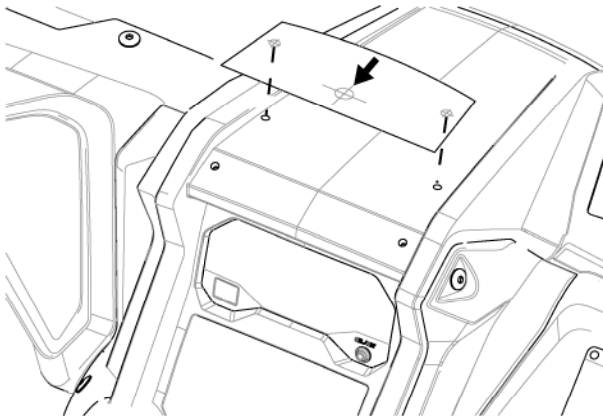

17. Using the 9/16 in drill bit with added tape depth guide prepared previously, drill a hole at the center of your mark.
 - Remove any burrs from the edge of the hole using a file.

<TOP VIEW OF INSTRUMENT PANEL>

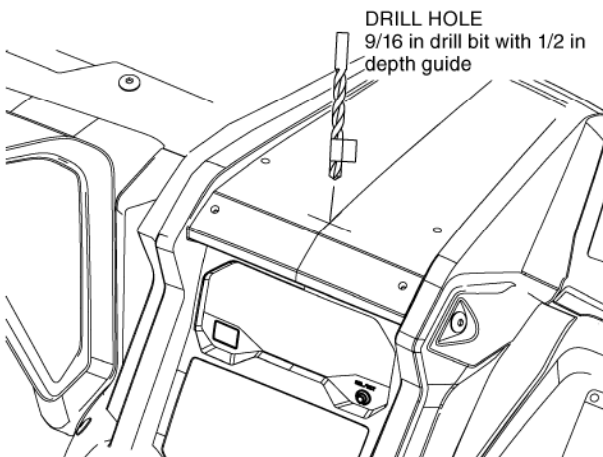

18. Pass the radio controller cable through the 9/16 in hole made in the previous step.
 - Using four trim clips, secure the dash kit to the instrument panel.

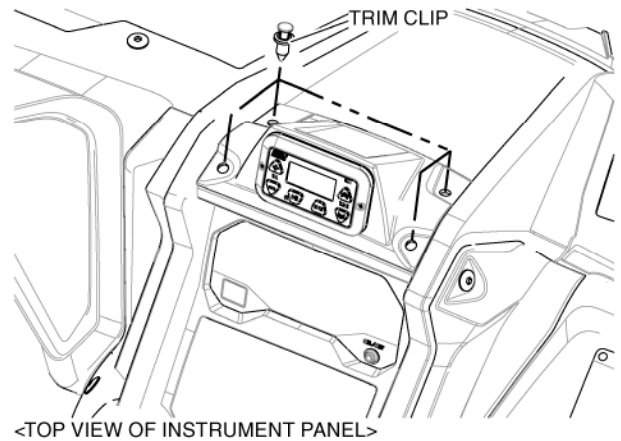

19. Using the trim clip removal tool, remove the five trim clips as shown below.

<DRIVERS SIDE OUTER FENDER>

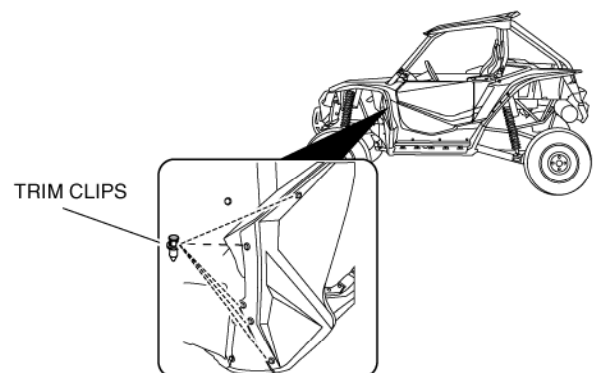

20. Using a trim clip removal tool remove 11 trim clips along the lower side cover. Remove the two hex head screws (as shown).

<DRIVERS SIDE OUTER FENDER>

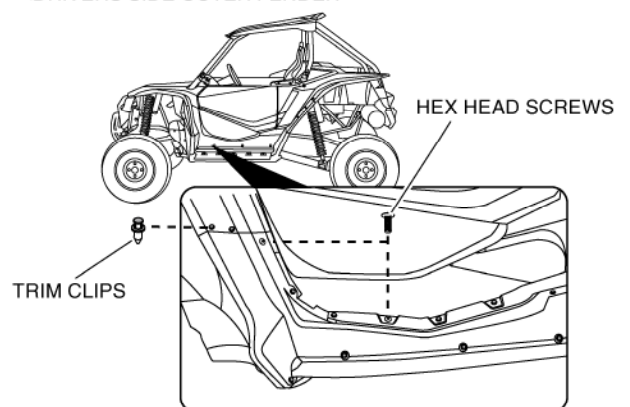

21. Open the driver side door, then use a trim clip removal tool to extract one trim clip located between the door and rear panel of the vehicle. Remove the driver side lower side cover.

<DRIVERS SIDE DOOR JAM>

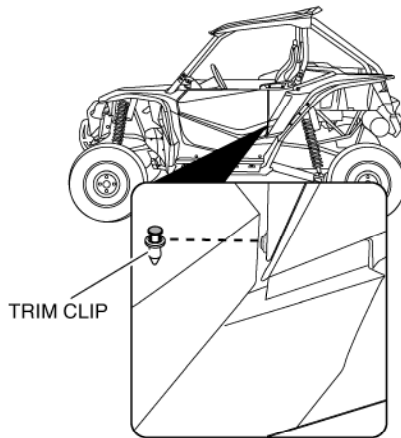

22. Remove the passenger side lower side cover by repeating steps 19 - 20.
Remove one 5 mm hex head screw from the rear panel (as shown).

<PASSENGER SIDE>

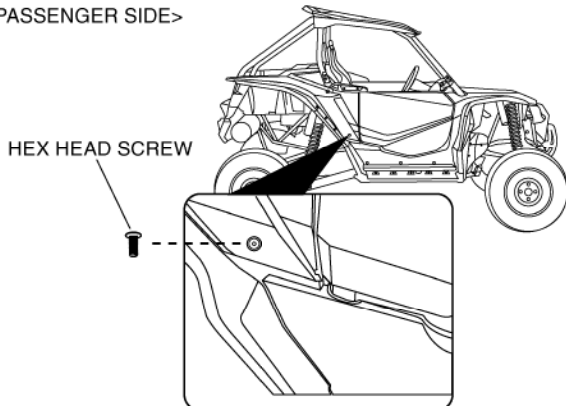

23. Lift the rear panel and remove one trim clip.

<PASSENGER SIDE>

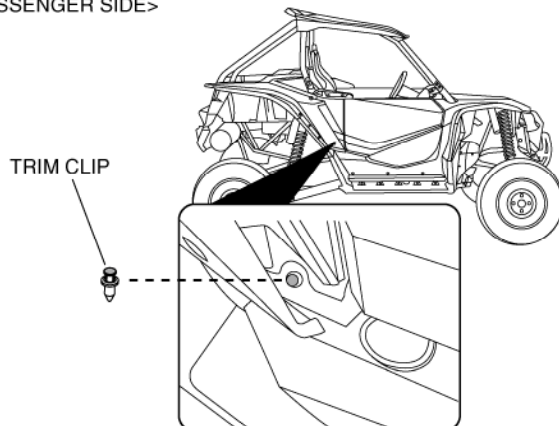

24. Assemble the driver side speaker pod bracket to the driver side speaker pod using the two 8 mm flange bolt and two washers.

- Tighten bolts to the specification supplied in the Torque Chart.
- Repeat this step for passenger speaker pod using passenger side speaker pod bracket.

Item	N·m	kgf·m	lbf·ft
8 mm flange bolt	7.8	0.8	5.8

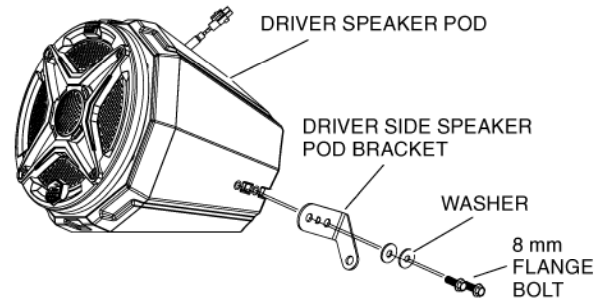

25. Remove the trim clip shown below. Set aside to be reused.

<DRIVERS SIDE FLOOR PANEL>

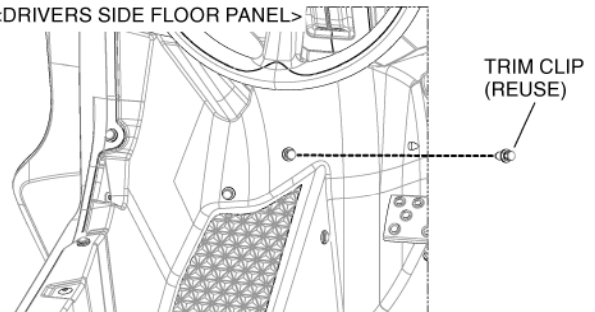

26. Place the driver side speaker pod template on the driver side floor panel then align the template so top, bottom and curved edges are flush with the vehicle panels.

Using the template as a guide, mark the center of each hole with a pencil. Drill three holes in the floor panel (as shown). Use a 9/16 in drill bit for the center hole and a 1/4 in drill bit for the two outside holes.

<DRIVER SIDE>

View is outside vehicle with fender removed

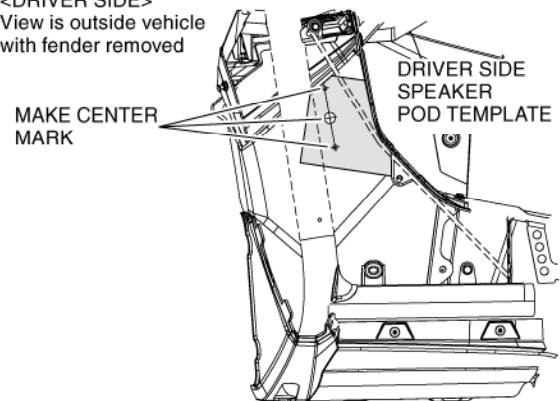

27. Pass the driver side speaker pod cable through the center hole in the floor panel.

- Use two 8 mm flange bolts and washers to secure the speaker pod in to place.
- Tighten bolts to the specification supplied in the Torque Chart.
- Reinstall the trim clip removed in step 25 into the speaker pod lower bracket.
- Repeat steps 25-27 on passenger side.

Item	N-m	kgf-m	lbf-ft
8 mm flange bolt	7.8	0.8	5.8

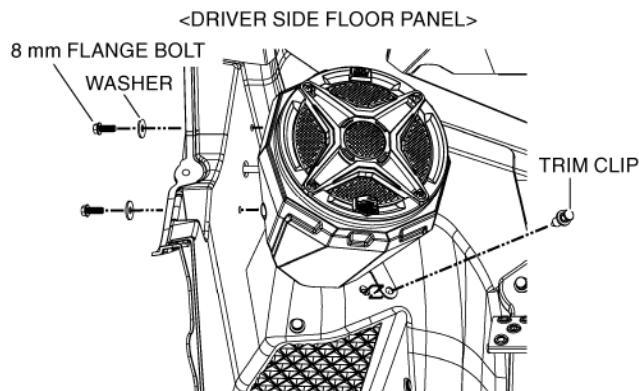

28. Connect the 2-pin connectors to the speaker pods.

- Connect the 4-pin speaker harness connector to the radio mcu front output.

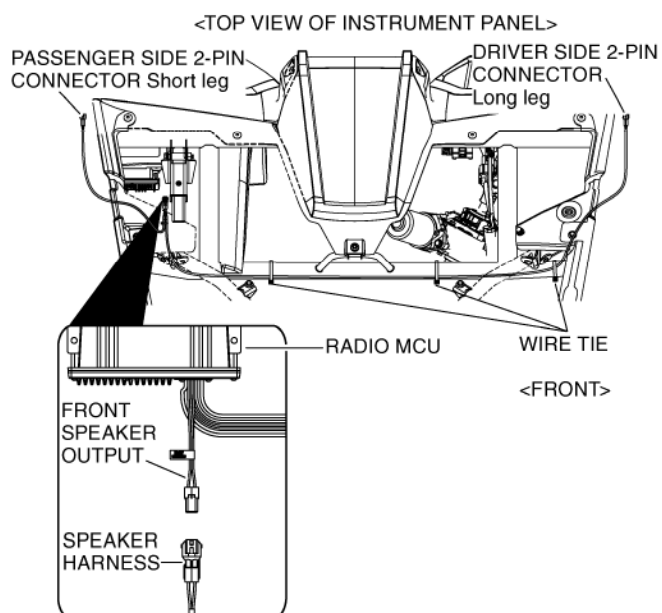

29. Disconnect the factory accessory socket connector.

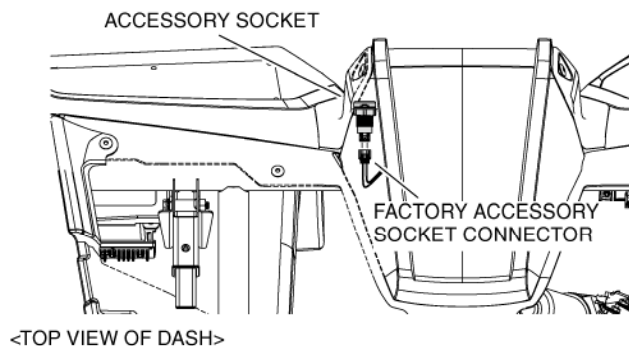

30. Connect the radio power harness to the accessory socket.

- Connect the opposite end of the radio power harness to the factory accessory socket connector.
- Connect the 2-pin radio power harness to the radio mcu.

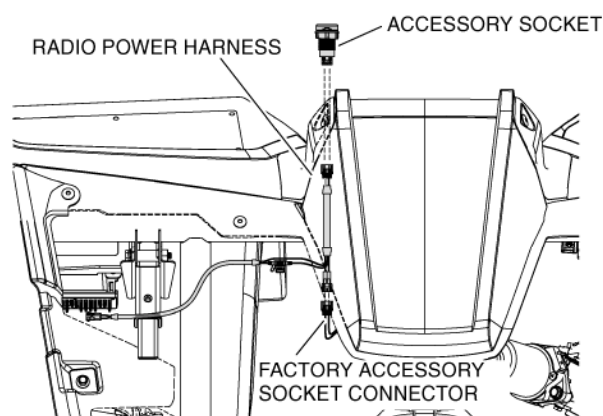

31. Connect the aux in socket harness (previously installed into the glovebox) to the 3-pin connector on the radio mcu. Route the harness under the grab handle mount.

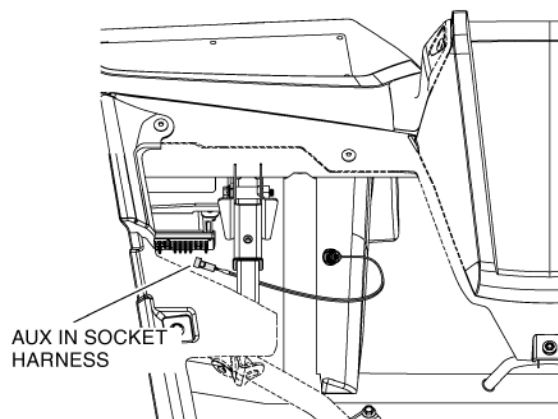

32. Connect the antenna cable to the radio mcu. For best reception, route the antenna cable so it loops back on itself then secure the cable with wire ties (as shown).

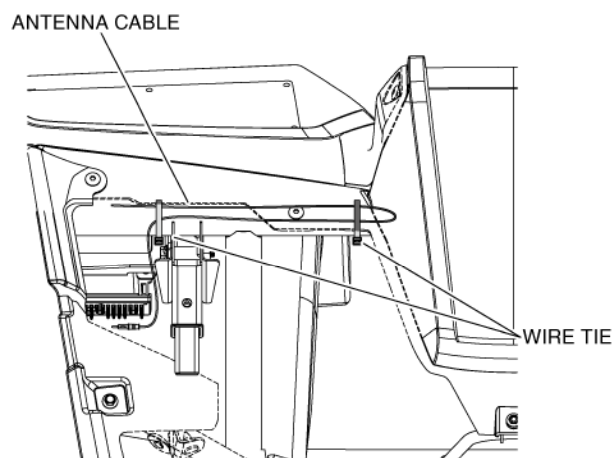

33. Reinstall the original parts in the reverse order of removal. Tighten all accessory supplied hardware to the specifications provided in this installation instruction.

Tighten all original hardware to the specifications provided in the Service Manual for this vehicle.