



# INSTALLATION INSTRUCTIONS

Accessory

FRONT A-ARM GUARDS  
P/N 0SK10-HL6-A00

Application

SXS1000S2X

Publication No.

MII 16561

Issue Date

February 2019

Honda Dealer: Please give a copy of these instructions to your customer.

## PARTS LIST

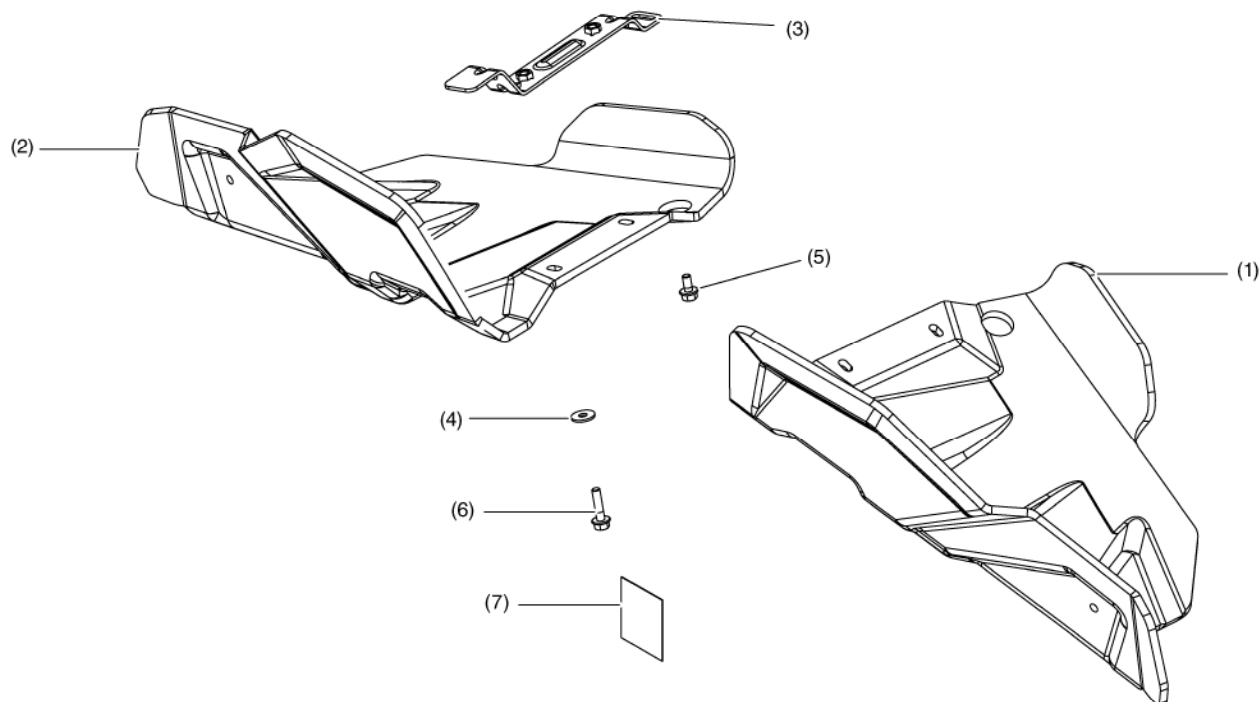

No.	Description	Qty
(1)	Left A-arm guard	1
(2)	Right A-arm guard	1
(3)	Mounting bracket	2
(4)	Fender washer	6
(5)	10 × 12 mm flange bolt	2
(6)	10 × 25 mm flange bolt	8
(7)	Installation Instructions URL	1

## TOOLS REQUIRED

Socket (10 mm)  
Ratchet  
Torque wrench  
Box-end wrench (10 mm)

## TORQUE CHART

Tighten all screws, bolts, and nuts to their specified torque values. Refer to the Service Manual for the torque values of the removed parts.

Item	N-m	kgf-m	lbf-ft
10 mm flange bolt	9	0.92	6.5

## INSTALLATION

### ⚠ CAUTION

To prevent burns, allow the engine, exhaust system, radiator, etc., to cool before installing the accessory.

1. Remove the original A-arm guard and hardware as shown.

<Left side>

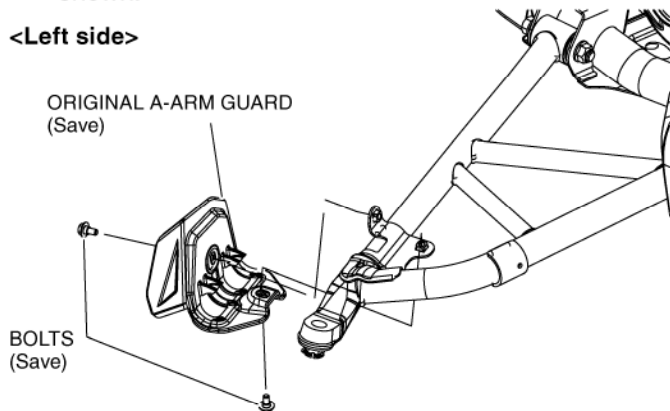

2. Loosely install the mounting bracket with the 10 × 12 mm flange bolt as shown.

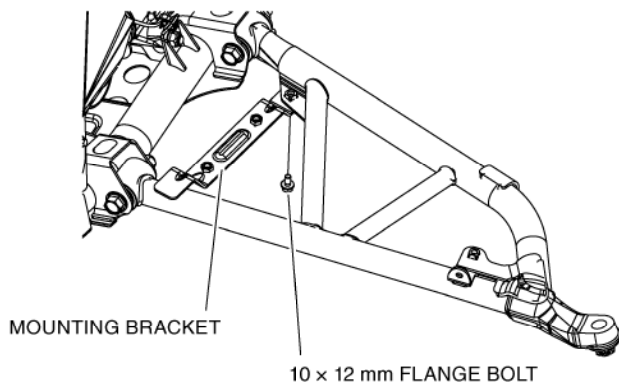

3. Hold the left A-arm guard against the left A-arm as shown. Loosely install the 10 × 25 mm bolt on front of the A-arm guard.

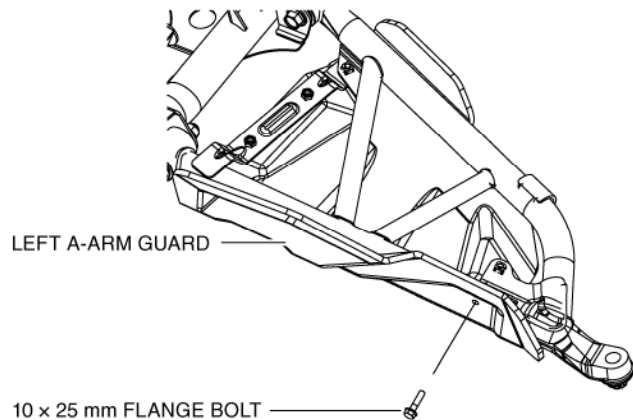

4. Loosely install the fender washers and the 10 × 25 mm flange bolts starting with the closest to the wheel.

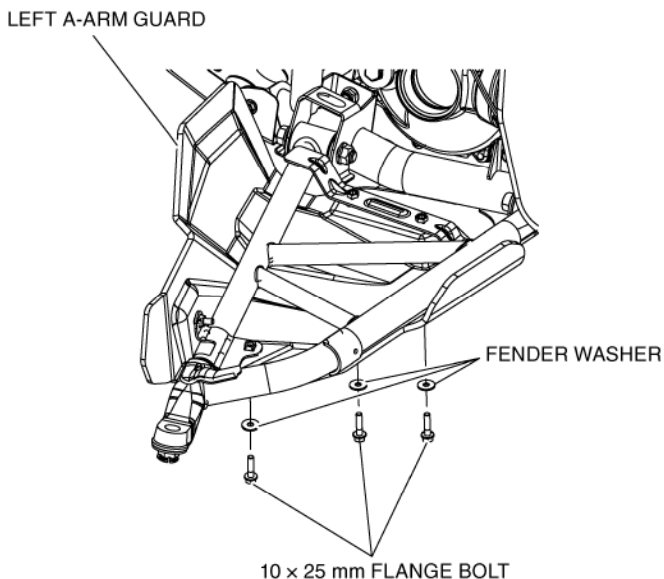

5. Tighten all the bolts the value specified in the TORQUE CHART starting with the one facing forward.

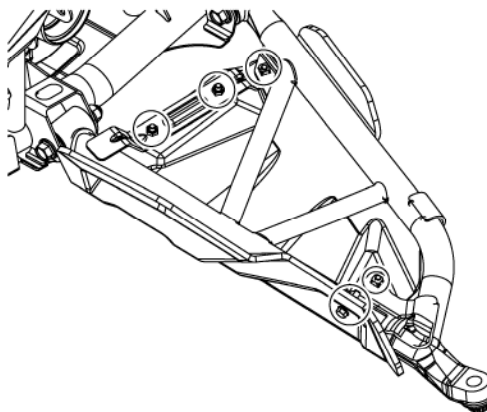

6. Repeat steps 1 through 5 on the right side.