



INSTALLATION INSTRUCTIONS

Accessory

**FULL POLY VENTED
WINDSCREEN**
P/N 0SR73-HL6-A00

Application

**SXS1000S2R
SXS1000S2X**

Publication No.

MII 16561

Issue Date

March 2019

Honda Dealer: Please give a copy of these instructions to your customer.

PARTS LIST

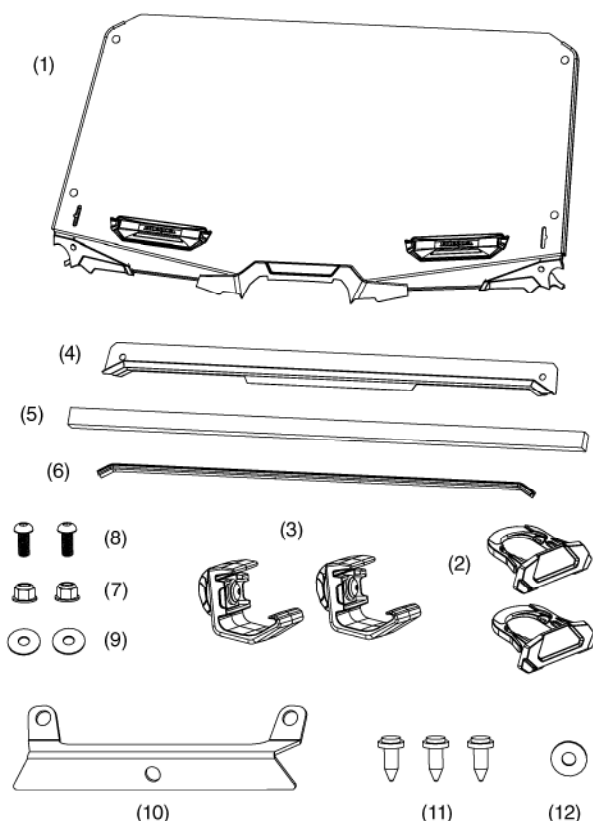

TOOLS REQUIRED

Ratchet
5 mm socket
13 mm socket
Power drill
8 mm or 5/16 in drill bit
Scissors
Pencil

USE AND CARE INFORMATION

- Check the accessory mounts frequently and retighten if necessary.
- Replace this accessory with a new one if it is damaged or discolored excessively.
- When this accessory becomes dirty, rinse it thoroughly with cool water to remove loose dirt and then wash with a clean cloth or sponge.
- Do not use a brush to clean this accessory as it may scratch the surface.
- Never use petroleum solvents such as gasoline, thinner, benzene, acid, or alkaline cleaners.

No.	Description	Qty
(1)	Vented windscreen	1
(2)	Mounting clip	2
(3)	Clamp	2
(4)	Visor	1
(5)	Foam seal	1
(6)	Rubber gasket	1
(7)	Nylock nut	2
(8)	20 mm hex head bolt	2
(9)	Flat washer	2
(10)	Center bracket	1
(11)	Trim clip	3
(12)	Rubber washer	1
(13)	Installation Instruction URL (not shown)	1

INSTALLATION

1. Remove the four corner bolts and washers from the original roof of the vehicle. Set aside hardware to be reinstalled.

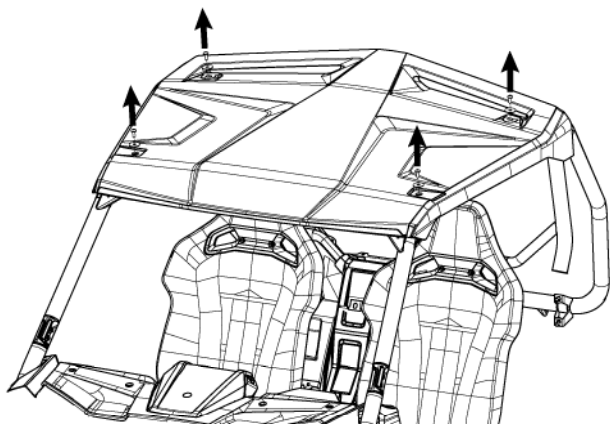

2. Remove the two bolts securing the roof from the inside of the vehicle. Remove the roof and set aside.

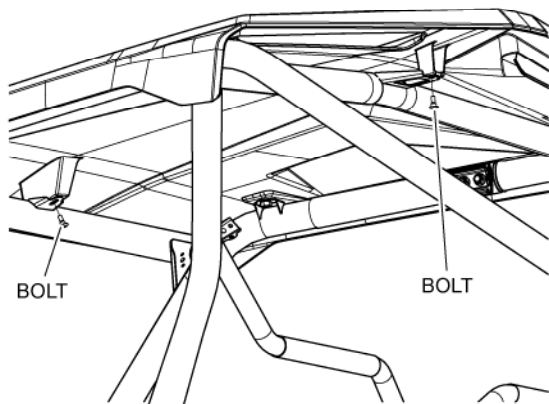

3. Loosely install the visor along the front edge of the OPS crossbar using two 20 mm hex head bolts, flat washers, and nuts. Do not fully tighten the hardware at this time.

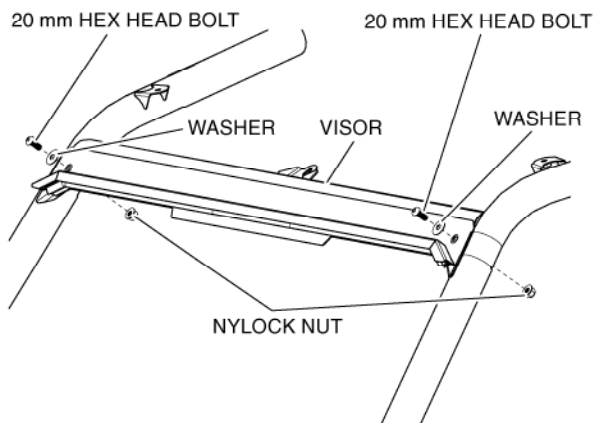

4. Press the rubber gasket into the channel on the visor as shown.

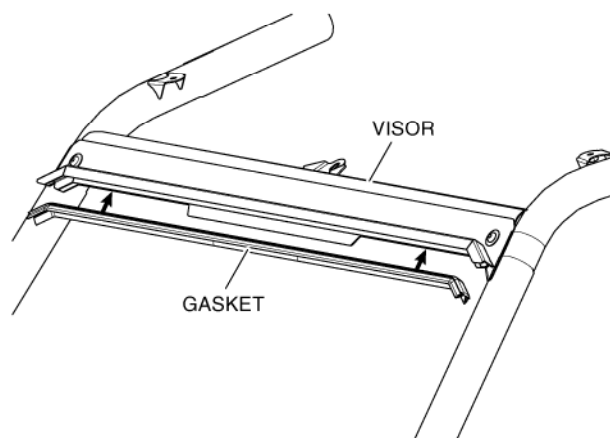

5. Locate the upper ends of the side gaskets on the windscreen. Lift the ends, then remove the paper backing from the adhesive strip. Firmly press the ends back down onto the edges of the windshield as shown.

NOTE: The ends of the gasket may need to be trimmed if they extend past the notch in the windshield.

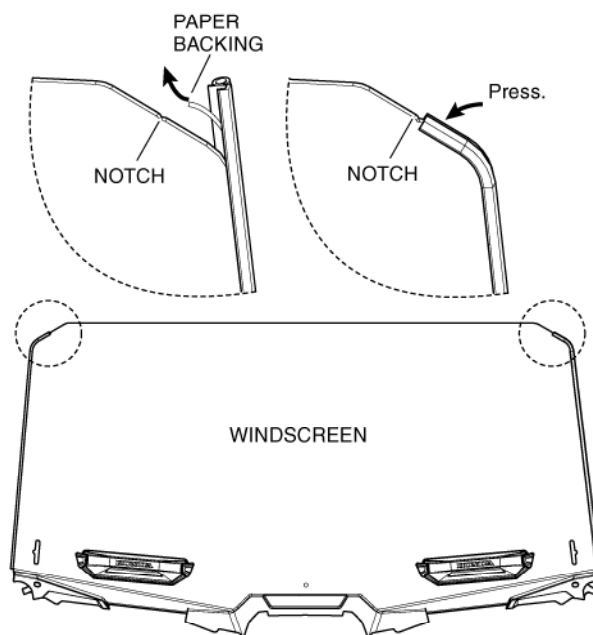

6. Insert the hook end of the clamps into the recessed areas in the base of both front vertical A-pillar OPS tubes, then wrap each clamp around the tube until it snaps into place. The knob on each clamp will be positioned toward the rear of the OPS bar.

NOTE: Clamp position can be adjusted vertically to allow the windshield to make a better seal against the top of the instrument panel.

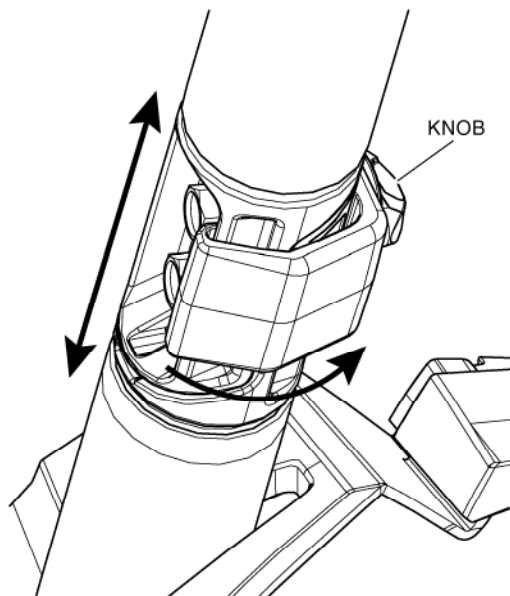

7. Insert the mounting clips through the slots in the wind deflector until they click into place. The feature on the outside of the clip will only fit through the recessed area on the outside of the slot.

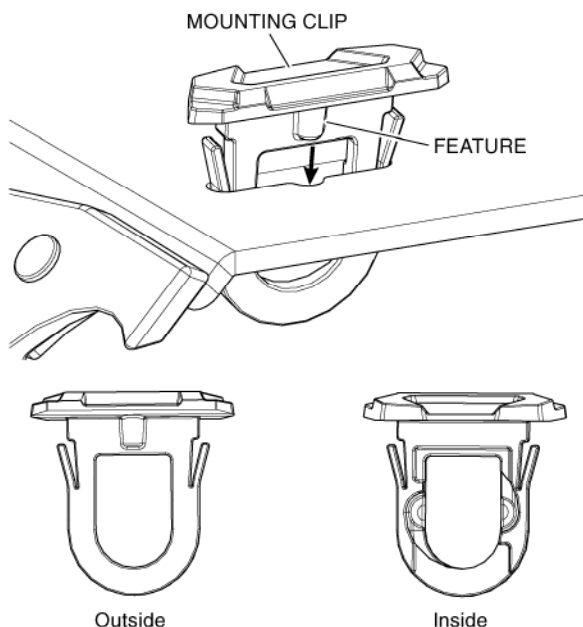

8. Attach the center bracket to the inside of the windshield using one rubber washer and one trim clip.

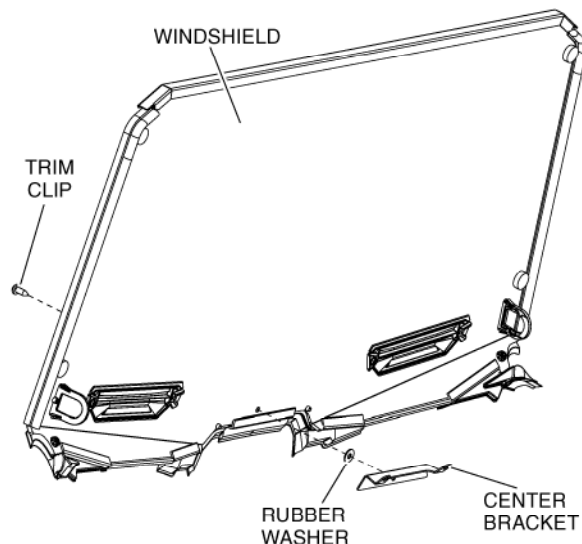

9. Cut out the template and place it in the recessed area on the top of the dash panel. Mark the locations of the holes onto the dash panel using a pencil, then remove the template. Drill two holes at the marked locations using an 8 mm or 5/16 in drill bit.

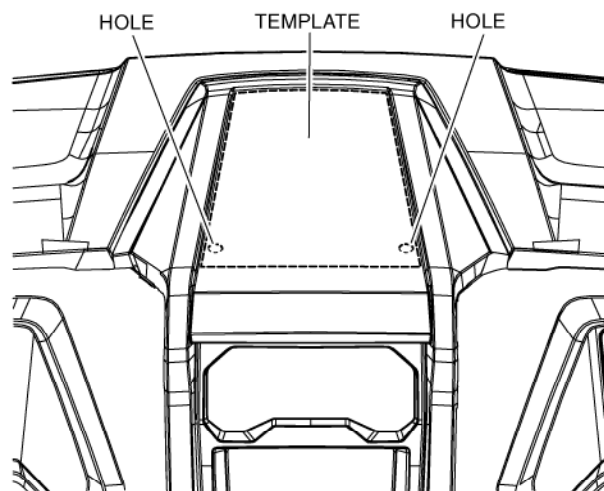

10. Place the top edge of the windshield into the channel in the visor and the bottom edge onto the instrument panel as shown. Carefully guide the knobs on the clamps through the openings in the mounting clips. Press the windshield down to make sure the gasket is making contact with the top of the dash panel.

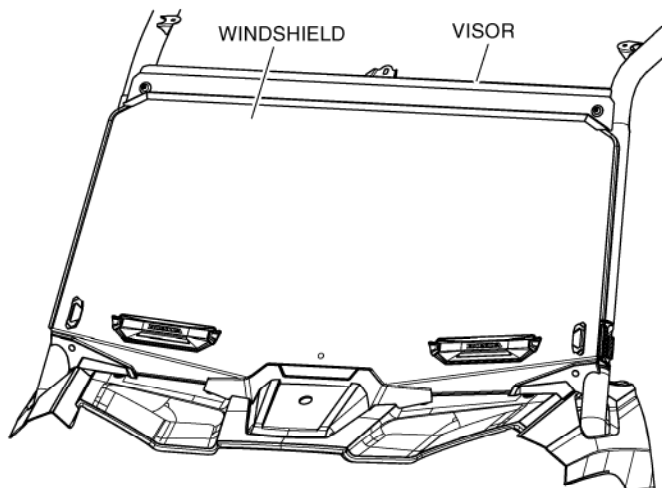

11. Make sure the knobs are fully inserted into the mounting clips, then turn the knobs 90 degrees clockwise to the position shown to secure the windscreen.

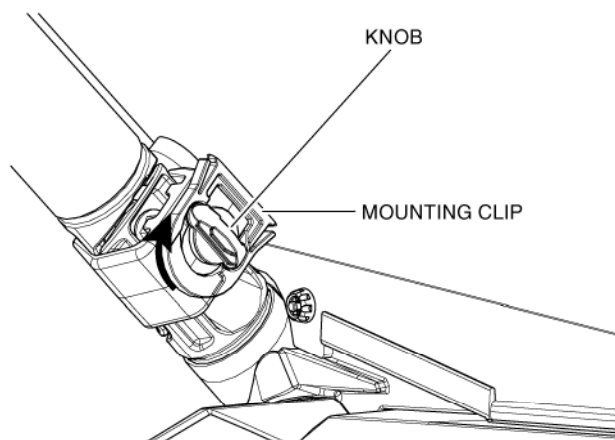

12. Remove the paper backing from the adhesive strip on the foam seal and adhere it to the topside of the upper OPS crossbar. Make sure the foam is covering the top edge of the mounting bracket and is centered side-to-side on the vehicle.
13. Fully tighten the visor hardware (A).

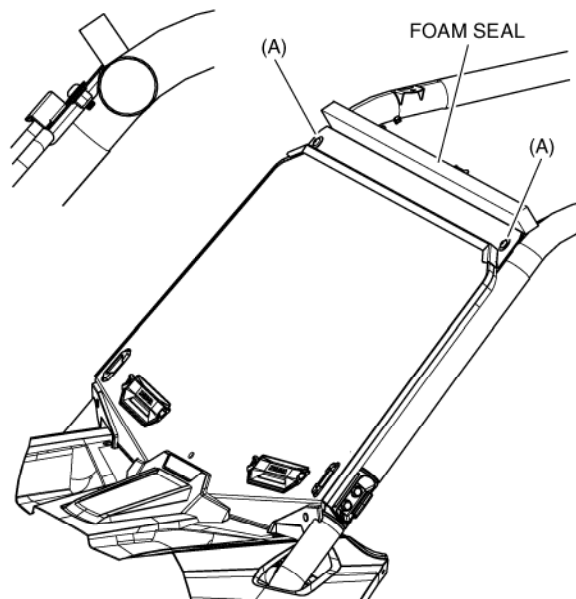

14. Attach the center bracket to the dash panel using two trim clips. Apply pressure to the outside of the windshield to allow the holes in the center bracket to line up with the holes in the dash panel.

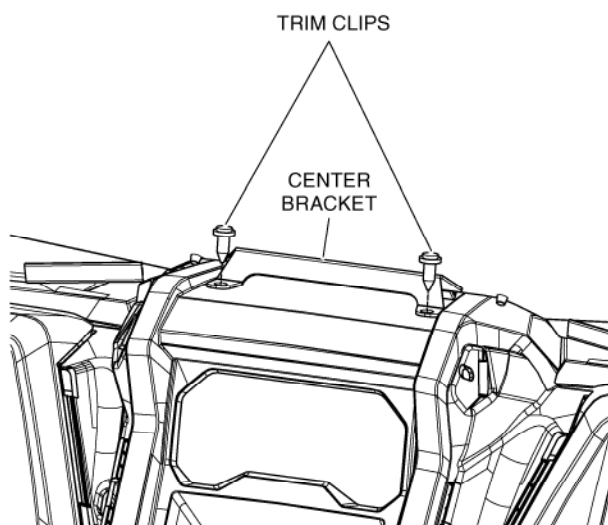

15. Reinstall the roof removed in Step 1. Make sure the front edge of the roof compresses the foam seal along the entire width of the vehicle. Be sure to tighten all hardware securely.