



INSTALLATION INSTRUCTIONS

Accessory

HALF WIND DEFLECTOR
P/N 0SR71-HL6-A00

Application

SXS1000S2R
SXS1000S2X

Publication No.

MII 16561

Issue Date

March 2019

Honda Dealer: Please give a copy of these instructions to your customer.

PARTS LIST

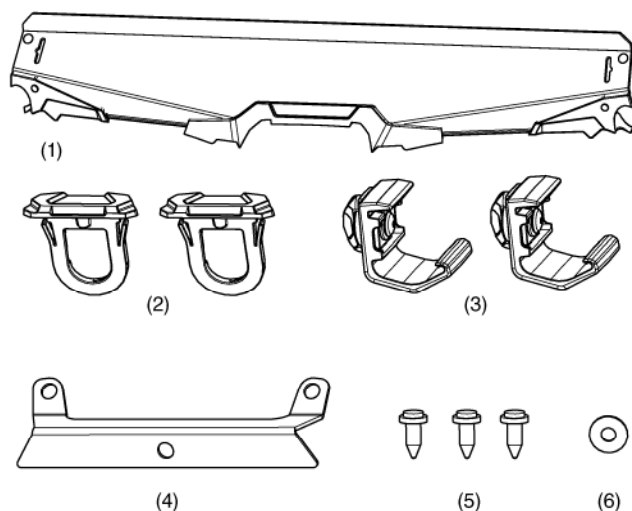

No.	Description	Qty
(1)	Wind deflector	1
(2)	Mounting clip	2
(3)	Clamp	2
(4)	Center bracket	1
(5)	Trim clip	3
(6)	Rubber washer	1

TOOLS REQUIRED

Power drill
8 mm drill bit
Pencil

USE AND CARE INFORMATION

- Check the accessory mounts frequently and retighten if necessary.
- Replace this accessory with a new one if it is damaged or discolored excessively.
- When this accessory becomes dirty, rinse it thoroughly with cool water to remove loose dirt and then wash with a clean cloth or sponge.
- Do not use a brush to clean this accessory as it may scratch the surface.
- Never use petroleum solvents such as gasoline, thinner, benzene, acid, or alkaline cleaners.

INSTALLATION

1. Insert the hook end of the clamps into the recessed areas in the base of both front vertical A-pillar OPS tubes, then wrap each clamp around the tube until it snaps into place. The knob on each clamp will be positioned toward the rear of the OPS bar.

NOTE: Clamp position can be adjusted vertically in the recess to allow the wind deflector to make a better seal against the top of the dash panel.

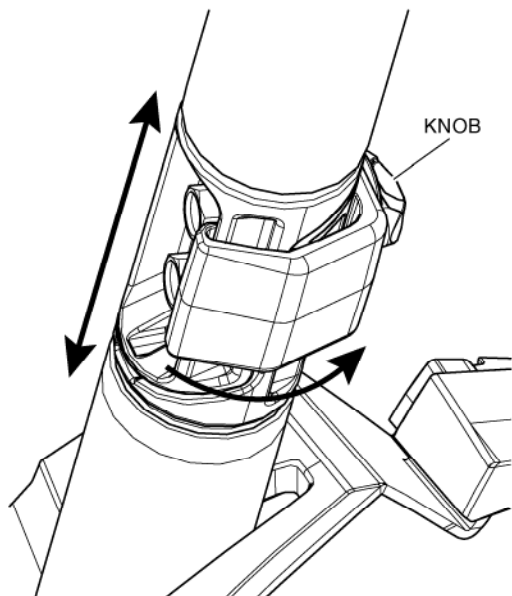

2. Insert the mounting clips through the slots in the wind deflector until they click into place. The feature on the outside of the clip will only fit through the recessed area on the outside of the slot.

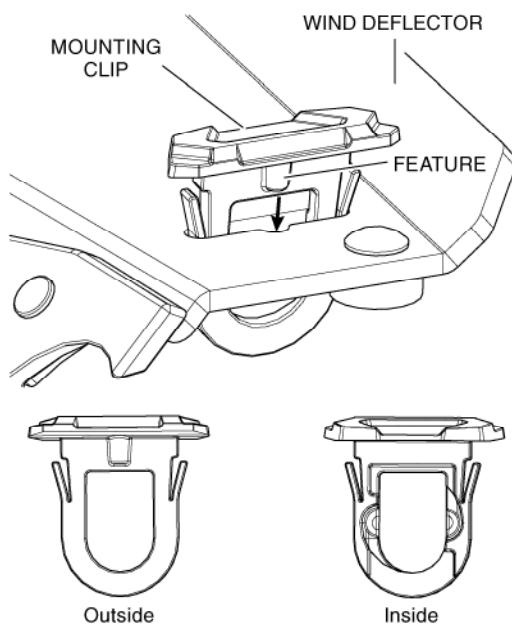

3. Attach the center bracket to the inside of the wind deflector using one rubber washer and one trim clip.

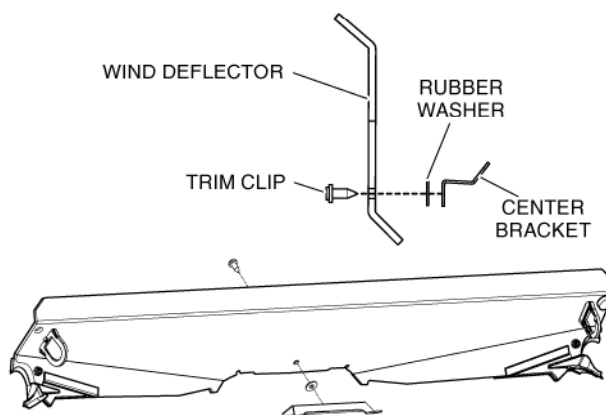

4. Cut out the template and place it in the recessed area on the top of the dash panel. Mark the locations of the holes onto the dash panel using a pencil, then remove the template. Drill the two holes at the marked locations using an 8 mm drill bit.

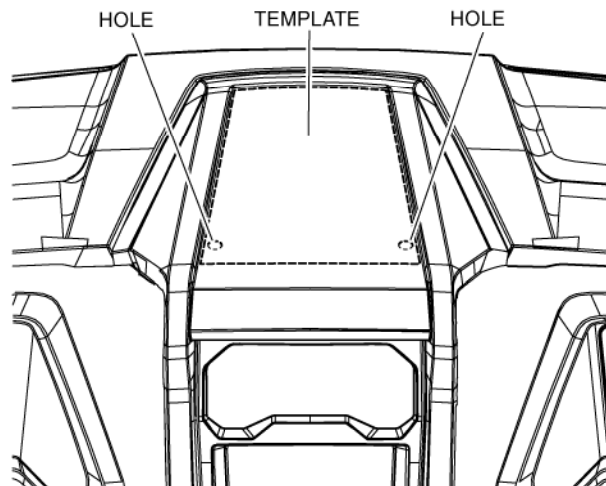

5. Place the bottom edge of the wind deflector on the dash panel as shown. Carefully guide the knobs on the clamps through the openings in the mounting clips. Press the wind deflector down to make sure the gasket is making contact with the top of the dash panel.

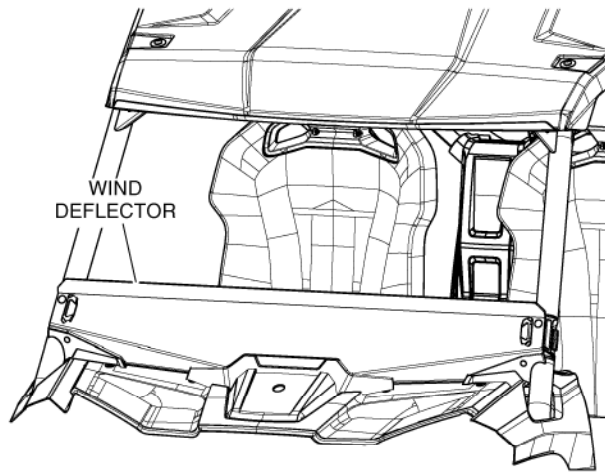

6. Make sure the knobs are fully inserted into the mounting clips, then turn the knobs 90 degrees clockwise to the position shown to secure the wind deflector.

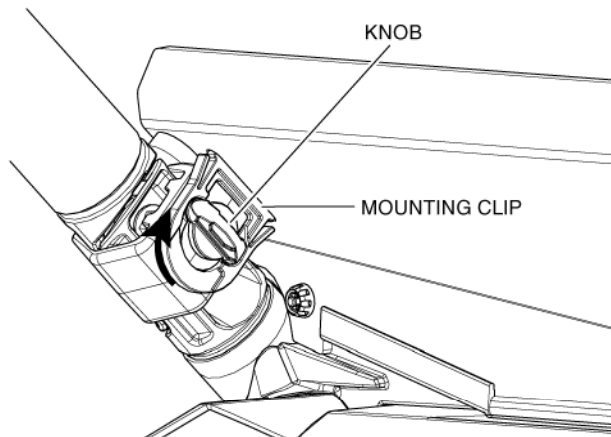

7. Apply pressure to the outside of the wind deflector until the holes in the center bracket line up with the holes in the dash panel, then secure the center bracket to the dash panel using two trim clips.

