

## Side Nets

Your Honda SXS is equipped with side nets to prevent branches, or other debris from getting inside the driver's compartment, and to keep the driver's and passenger's hands and arms inside the occupant protective structure (OPS) if the vehicle ever tips or overturns.

The side nets are secured to the OPS with side net rings, side net snap hooks and side net buckles. To function properly, the side nets should be tight. If a side net is loose, tighten the belts on the side net rings.

Be sure the side nets are properly latched before driving your Honda SXS, and never remove a side net from the vehicle. Inspect the condition of the side net and its mounting hardware. If there is wear, deterioration, damage, or they do not latch and tighten securely, see your dealer for repair or replacement.

## Side Nets

### Side Nets Set Up

The left and right side nets can be set up in the same manner.

Inspect the side nets and their mounting hardware for damage as specified in the maintenance schedule on page 95.

#### Front

1. Hook the side net snap hooks and fasten the side net buckle.
2. Tighten the belt on the lower side net ring.

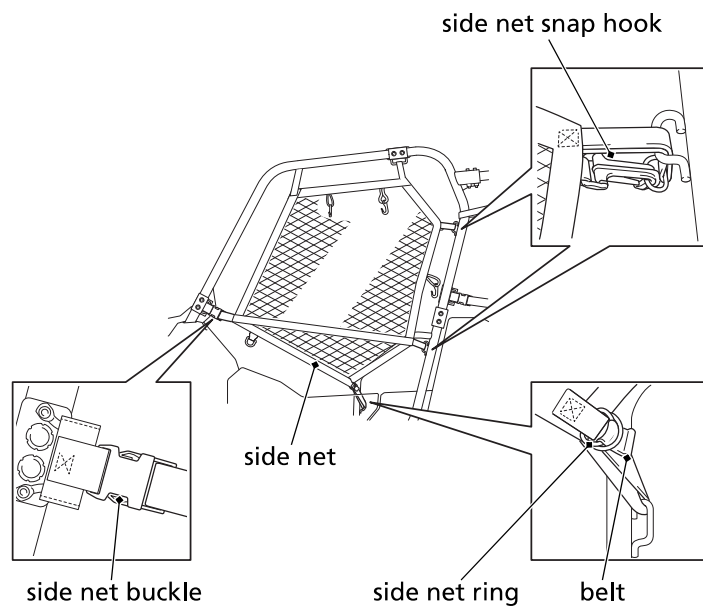

## Side Nets

### Rear (4 Person Model only)

1. Hook the side net snap hooks and fasten the side net buckle.
2. Tighten the belt on the side net ring.

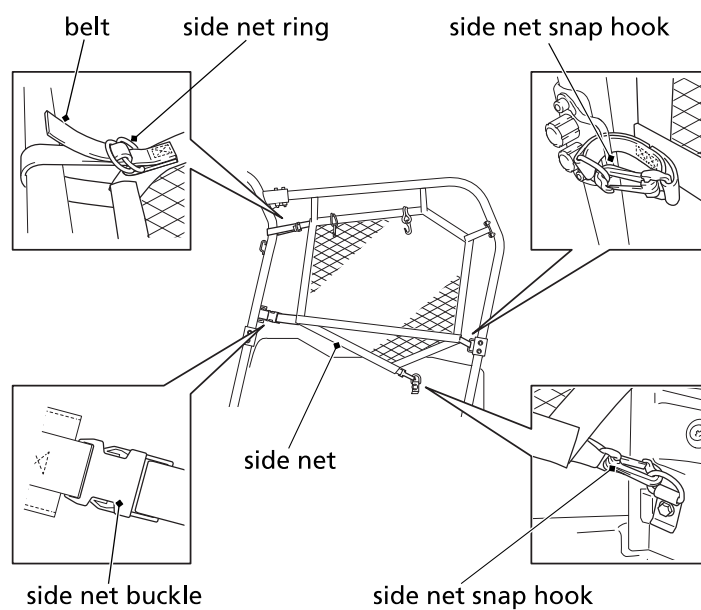

### Side net snap hooks wear limit

Inspect the side net snap hooks for wear. If the side net snap hook become less than 0.24 in (6 mm), see your SXS dealer for replacement.

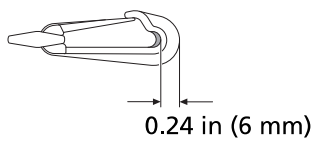

## 40 Instruments & Controls

## Side Nets

### Front Side Nets

The left and right side nets can be opened in the same manner.

#### Open

1. Release the side net buckle.
2. Hook the side net ring onto the side net hook while lifting the side net.

#### Close

1. Unhook the side net ring from the side net hook.
2. Fasten the side net buckle.

Always return the side nets to their normal positions, properly fastened, and tightened before driving.

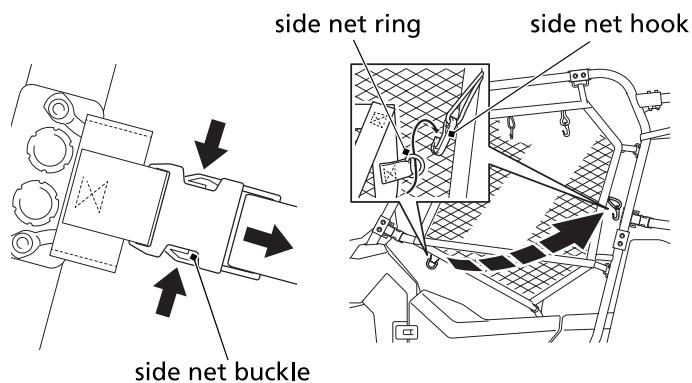

## Side Nets

### Rear Side Nets (4 Person Model only)

The left and right side nets can be opened in the same manner.

#### Open

1. Release the side net buckle and lower side net snap hook.
2. Hook the side net onto the side net hook while lifting the side net.

#### Close

1. Unhook the side net from the side net hook.
2. Hook the side net snap hook and fasten the side net buckle.

Always return the side nets to their normal positions, properly fastened, and tightened before driving.

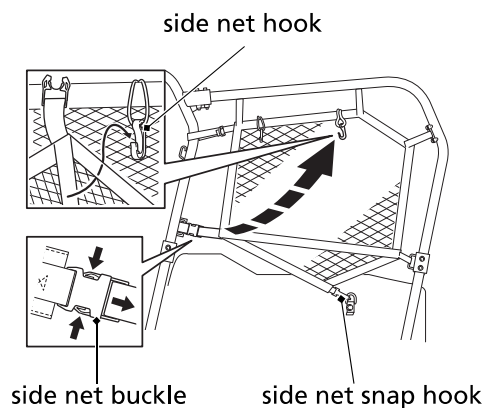

## Side Nets

### Roll Up The Side Nets

The side nets can be rolled up to make cleaning and maintaining your Honda SXS a little easier.

#### Front Side Nets Roll Up

1. Release the side net buckle and side net ring.
2. Unhook the side net snap hooks and slide the D-rings out of the stays.
3. Roll up the side net tightly, folding in the buckle and snap hooks on the way.
4. Hook the two upper side net hooks to the top edge of the side net.

#### Front Side Nets Roll Down

1. Unhook the upper side net hooks.
2. Fasten the side net buckle and hook the side net snap hooks.  
Tighten the belt of side net ring.

Always return the side nets to their normal positions, properly fastened, and tightened before driving.

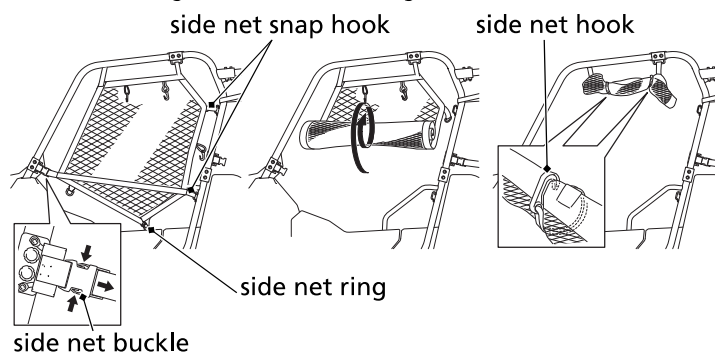

## Side Nets

### Rear Side Nets Roll Up (4 Person Model only)

1. Release the side net buckle.
2. Unhook the side net snap hooks and slide the D-rings out of the stays.
3. Roll up the side net tightly, folding in the buckle and snap hooks on the way.
4. Hook the two upper side net hooks to the top edge of the side net.

### Rear Side Nets Roll Down (4 Person Model only)

1. Unhook the upper side net hooks.
2. Hook the side net snap hooks and fasten the side net buckle.

Always return the side nets to their normal positions, properly fastened, and tightened before driving.

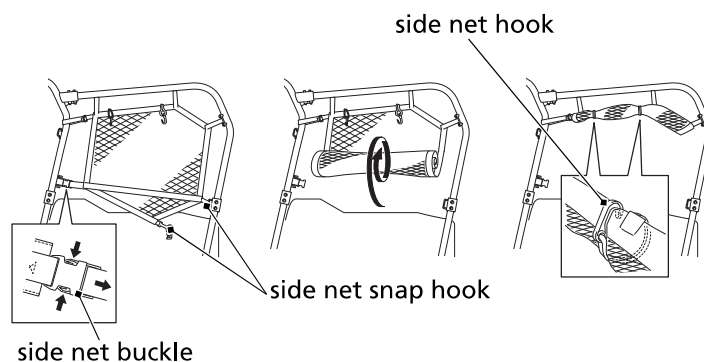

## 44 Instruments & Controls