



INSTALLATION INSTRUCTIONS

Accessory

REAR BUMPER
P/N 0SP73-HL6-A00

Application

SXS1000S2X
SXS1000S2R

Publication No.

MII 16561

Issue Date

March 2019

Honda Dealer: Please give a copy of these instructions to your customer.

PARTS LIST

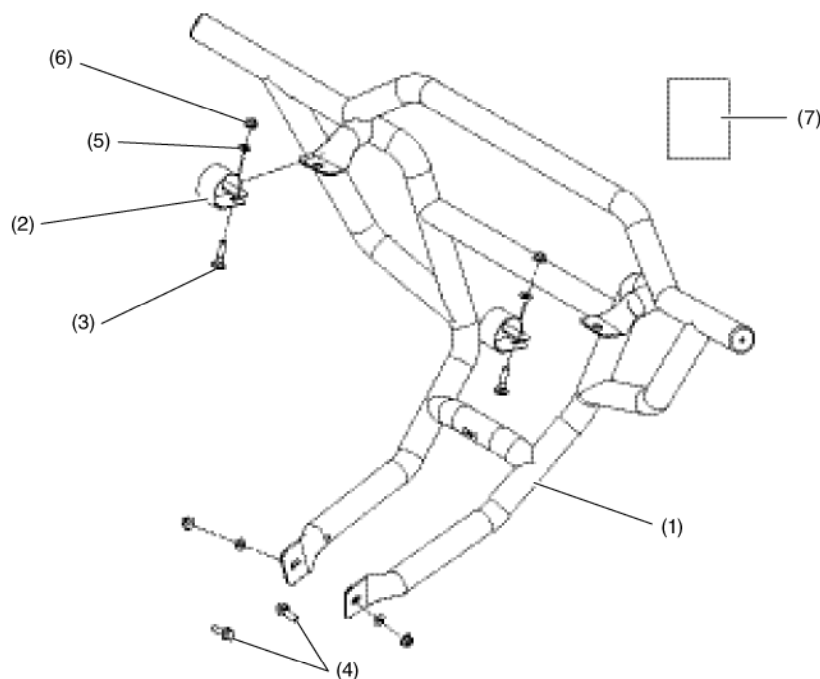

No.	Description	Qty
(1)	Rear Bumper	1
(2)	Clamp	2
(3)	35 mm Carriage bolt	2
(4)	12 × 25 mm Flange bolt	2
(5)	Washer	4
(6)	Flange nut	4
(7)	Installation Instruction URL	1

TORQUE CHART

Tighten all screws, bolts, and nuts to their specified torque values. Refer to the Service Manual for the torque values of the removed parts.

Item	N·m	kgf·m	lbf·ft
12 mm flange bolt	20	2.2	16
5 mm shoulder bolt (Original bolt)	4	0.4	2.95

TOOLS REQUIRED

Socket (12 mm)
Ratchet
Torque wrench
Box-end wrench (12 mm)
Hex wrench (5 mm)

INSTALLATION

⚠ CAUTION

To prevent burns, allow the engine, exhaust system, radiator, etc., to cool before installing the accessory.

1. Remove the original rear cover and the original hardware from the rear tube as shown.

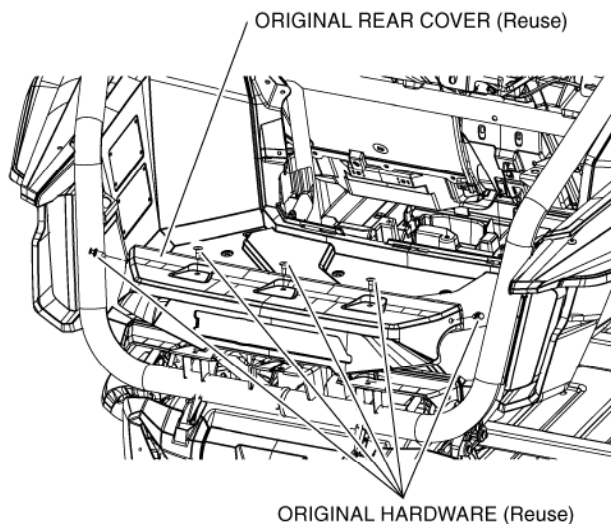

2. Install both clamps on the rear tube as shown.

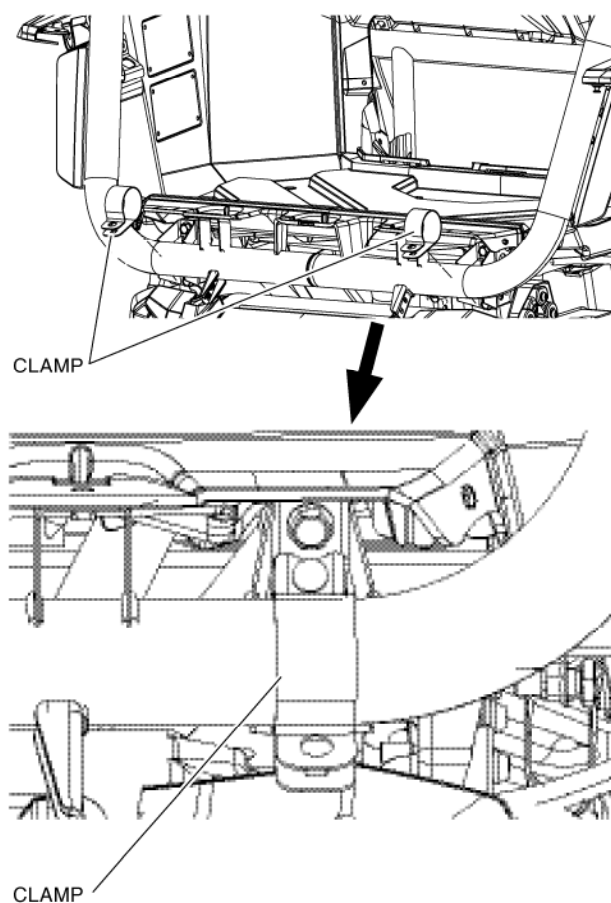

3. Loosely install the top of the rear bumper on the top of the clamps using the 35 mm carriage bolts, washers and flange nuts as shown.

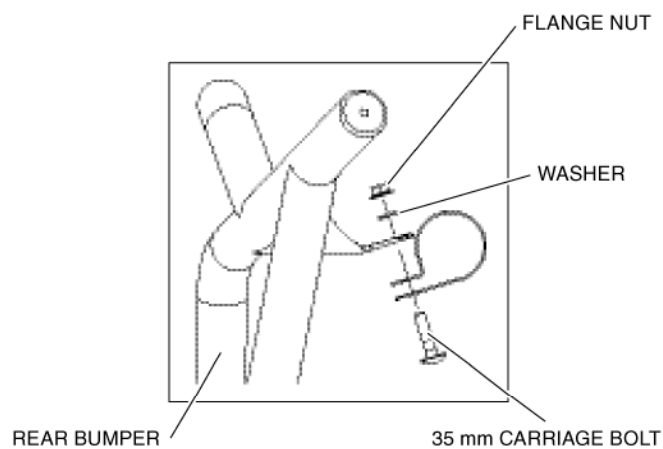
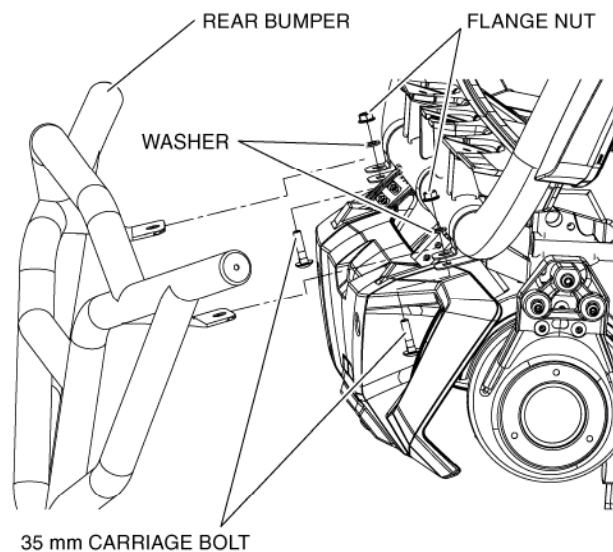

4. Loosely install the bottom of the rear bumper using the 12 × 25 mm flange bolts, washers and flange nuts as shown.

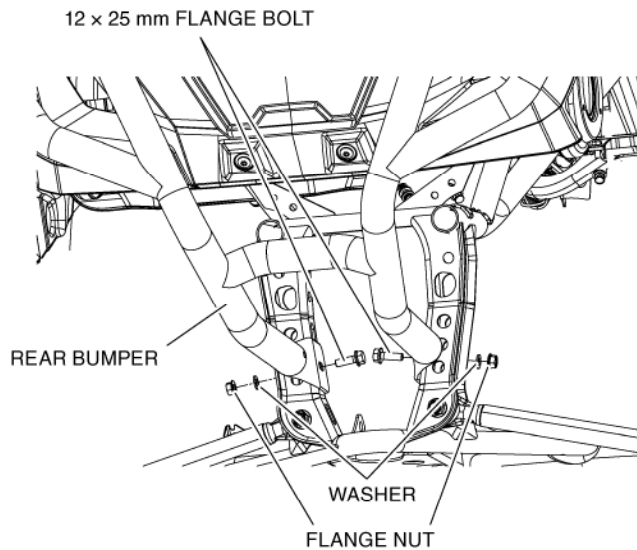

5. Tighten all bolts to the values specified in the TORQUE CHART.
6. Reinstall the original rear cover to the rear tube using the original hardware as shown. Tighten all hardware to the torque specification in the Service Manual.

