



INSTALLATION INSTRUCTIONS

Accessory
FRAME SKID PLATES
P/N 0SK30-HL6-A00

Application
SXS1000S2X
SXS1000S2R

Publication No.
MII 16561
Issue Date
February 2019

Honda Dealer: Please give a copy of these instructions to your customer.

PARTS LIST

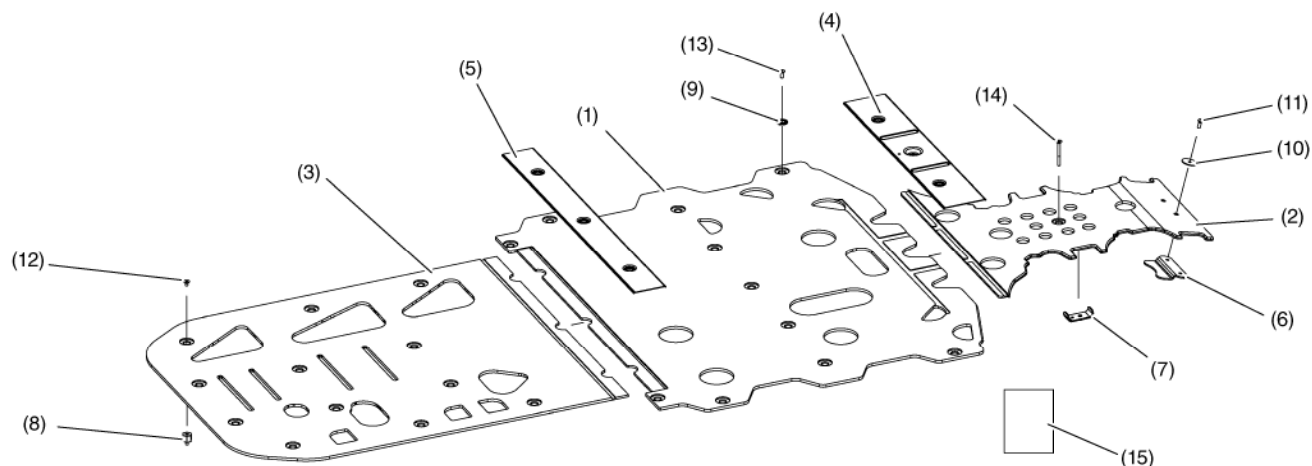

No.	Description	Qty
(1)	Center Skid Plate	1
(2)	Front Skid Plate	1
(3)	Rear Skid Plate	1
(4)	Front Link Plate	1
(5)	Rear Link Plate	1
(6)	Sub Frame Mounting Bracket	1
(7)	U-Bracket	1
(8)	Spacer	7
(9)	6 mm Stamped washer	26
(10)	6 mm Fender washer	2
(11)	4 x 16 mm Button Head socket screw	2
(12)	4 x 10 mm Flat Head socket screw	7
(13)	4 x 16 mm Flat Head socket screw	22
(14)	4 x 60 mm Flat Head socket screw	1
(15)	Installation Instruction URL	1

TOOLS REQUIRED

Socket (10 mm)
Socket (19 mm)
Ratchet
Torque wrench
Box-end wrench (19 mm)
4 mm Hex wrench

TORQUE CHART

Tighten all screws, bolts, and nuts to their specified torque values. Refer to the Service Manual for the torque values of the removed parts.

Item	N-m	kgf-m	lbf-ft
4 mm socket screw	9	0.92	6.5
Spacer	9	0.92	6.5

INSTALLATION

⚠ CAUTION

To prevent burns, allow the engine, exhaust system, radiator, etc., to cool before installing the accessory.

1. Remove original skid plates.

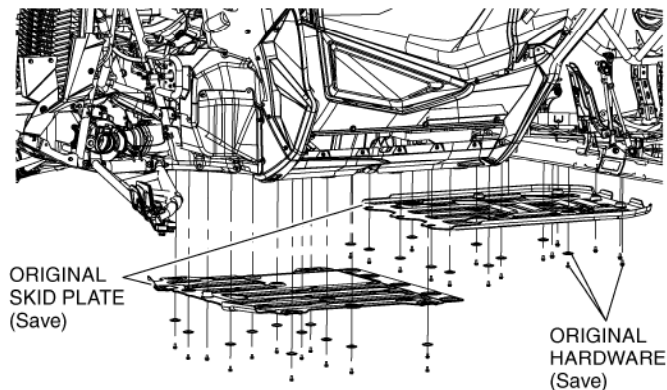

2. Install a spacer into the bracket at the position shown and tighten it to the value specified in the TORQUE CHART.

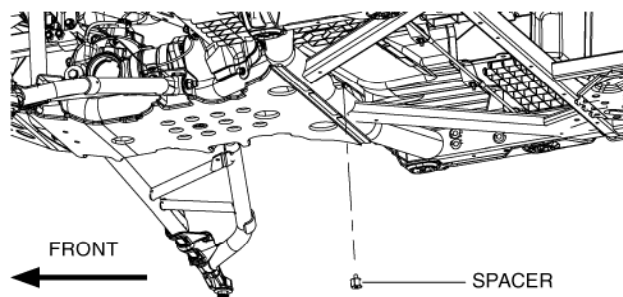

3. Install spacers into the brackets at the position shown and tighten them to the value specified in the TORQUE CHART.

«REAR SUSPENSION»

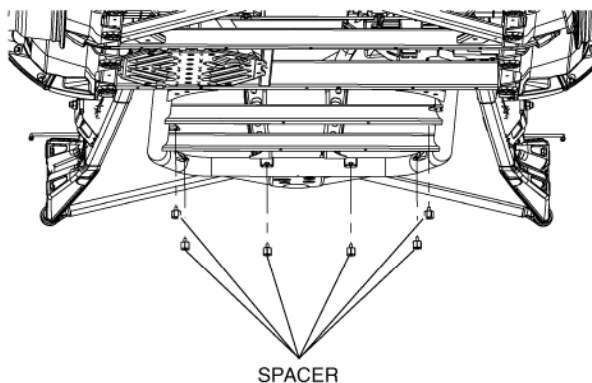

4. Loosely install front link plate as shown.

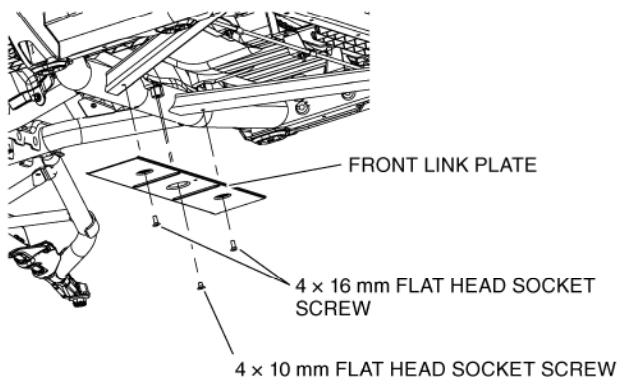

FRONT LINK PLATE SIDE
FRONT OF THE VEHICLE

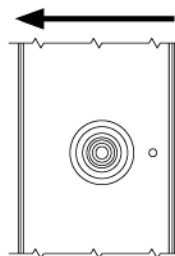

5. Hand bend the front skid plate to 15° along the v-groove.

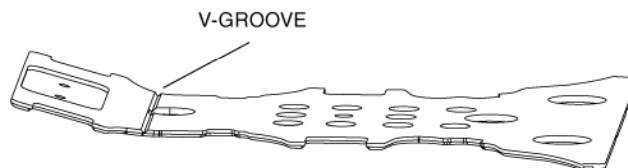

6. Slide rear edge of the front skid plate under front link plate as shown.

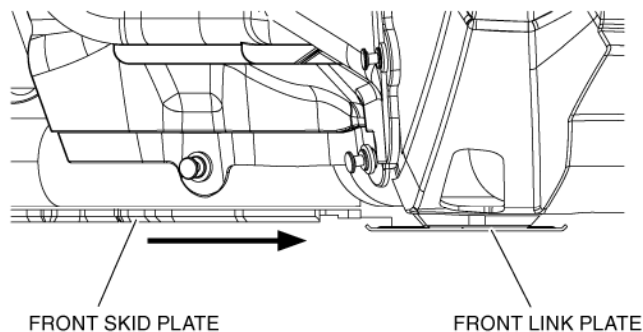

7. Place the sub frame mounting bracket on top of the original skid plate, hold it by hand and install the two fender washers and two 4 × 16 mm button head socket screws through the holes on front skid plate as shown.

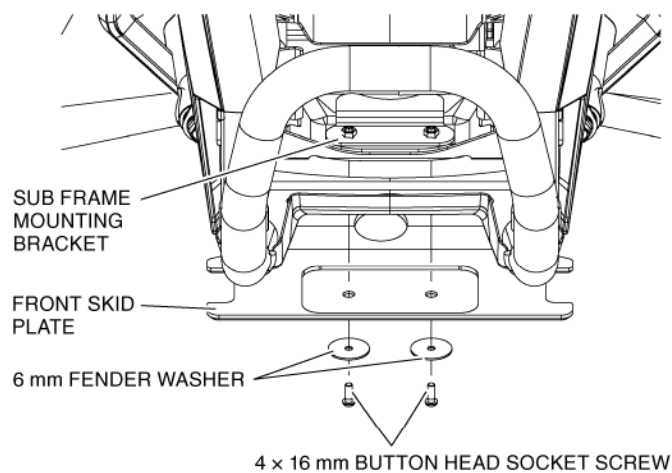

8. Place U-bracket in the center of the A-arm cross bracket as shown. Then install the 3 mm stamped washer with the 4 × 60 mm flat head socket screw through the skid plate and into the U-bracket.

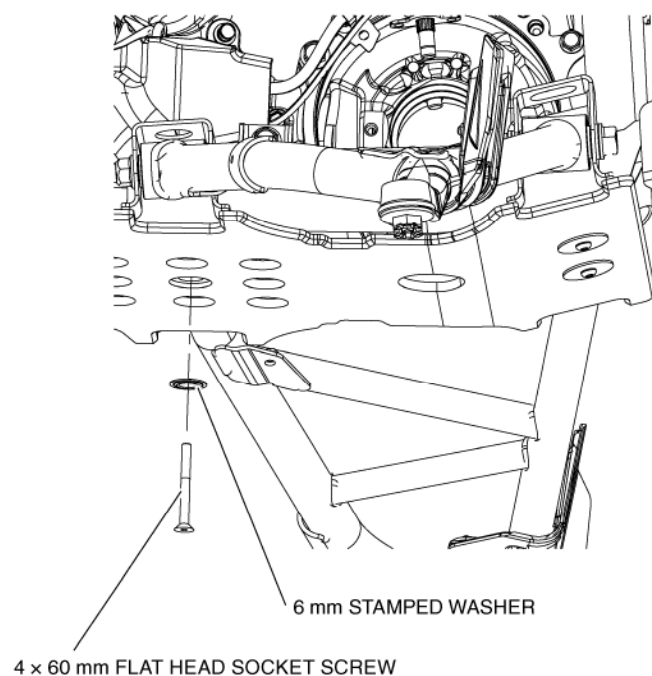
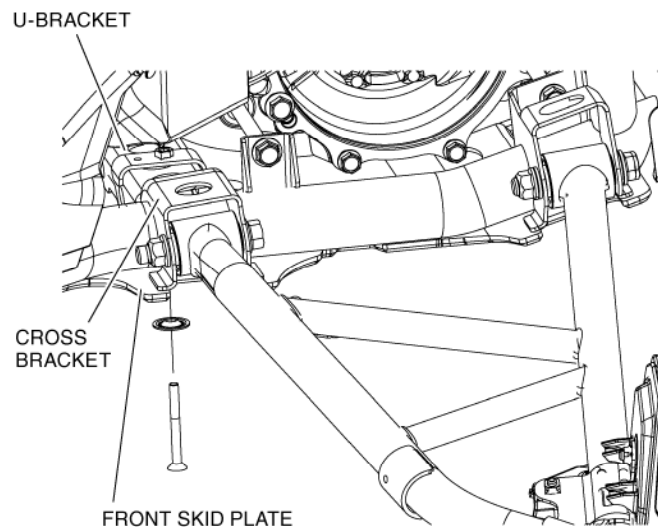

U-BRACKET SIDE
FRONT OF THE VEHICLE

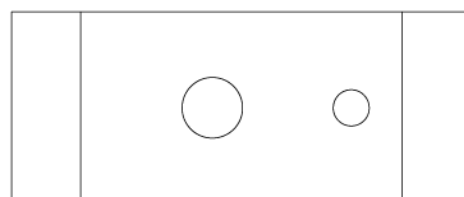

9. Slide the center skid plate under front link plate as shown.

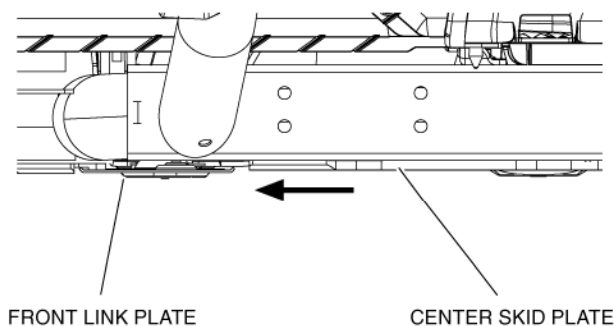

10. Loosely install eleven 4 × 16 mm flat head socket screws with eleven 6 mm stamped washers in the center skid plate as shown.

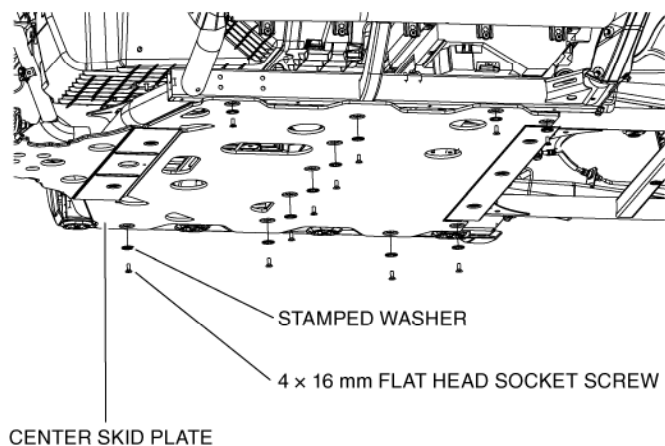

11. Loosely install rear link plate with three 4 × 16 mm flat head socket screws.

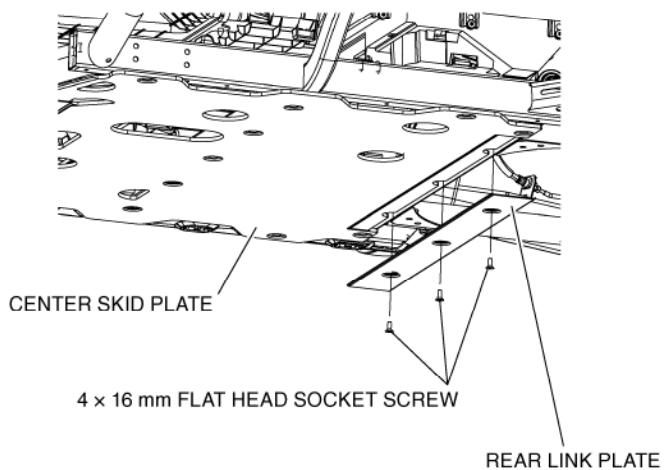

12. Slide the rear skid plate under the rear link plate as shown.

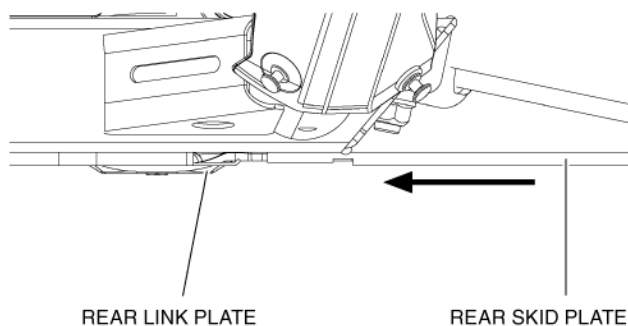

13. Loosely install six 4 × 10 mm flat head socket screws and six stamped washers as shown.

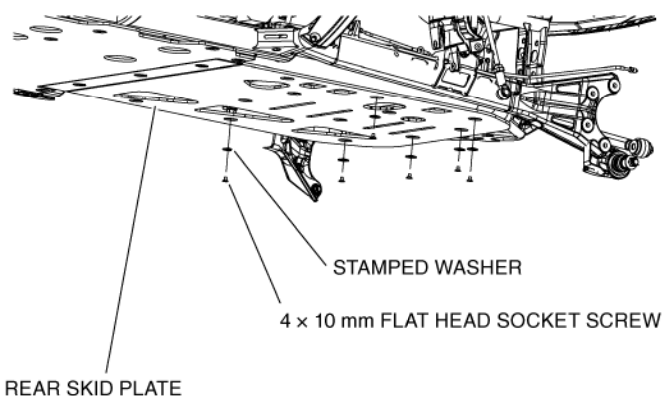

14. Loosely install six 4 × 16 mm flat head socket screws and six 6 mm stamped washers as shown.

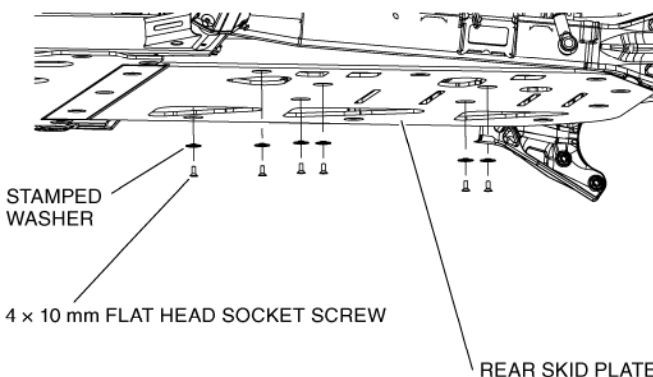

15. Tighten all the hardware to the values specified in the TORQUE CHART.