



INSTALLATION INSTRUCTIONS

Accessory

TRAILING ARM GUARDS
P/N 0SK11-HL6-A00

Application

SXS1000S2X

Publication No.

MII 16561

Issue Date

February 2019

Honda Dealer: Please give a copy of these instructions to your customer.

PARTS LIST

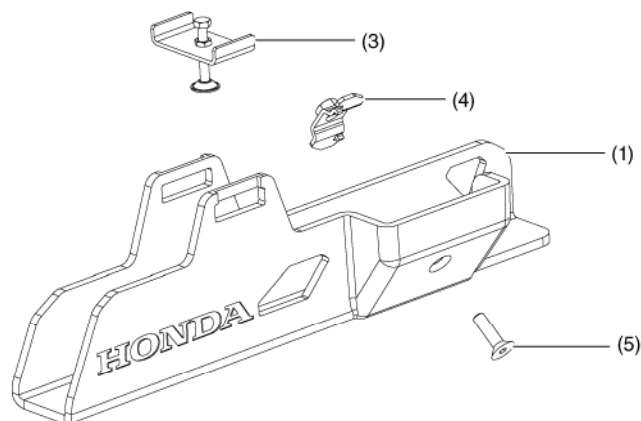
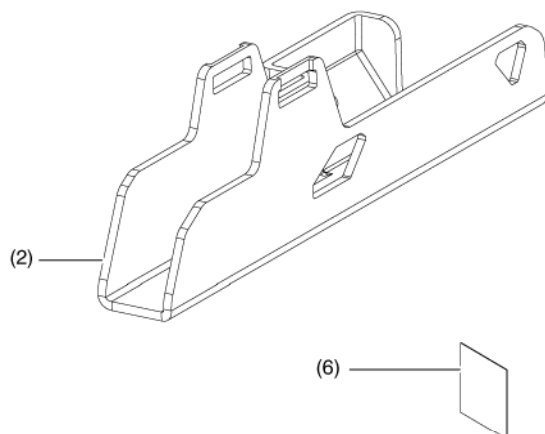

No.	Description	Qty
(1)	Left arm guard	1
(2)	Right arm guard	1
(3)	Top attachment bracket assembly	2
(4)	Side attachment bracket	2
(5)	5 x 30 mm hex head screw	2
(6)	Installation Instructions URL	1

TORQUE CHART

Tighten all screws, bolts, and nuts to their specified torque values. Refer to the Service Manual for the torque values of the removed parts.

Item	N-m	kgf-m	lbf-ft
10 mm bolt (in bracket assembly)	9	0.92	6.5
5 mm flat head hex screw	22	2.2	16

TOOLS REQUIRED

Socket (10 mm)

Ratchet

Torque wrench

Box-end wrench (10 mm)

Hex wrench (5 mm)

INSTALLATION

⚠ CAUTION

To prevent burns, allow the engine, exhaust system, radiator, etc., to cool before installing the accessory.

1. Start on the left side. Loosely install the side attachment bracket to the left arm guard using a 5 × 30 mm hex head screw.

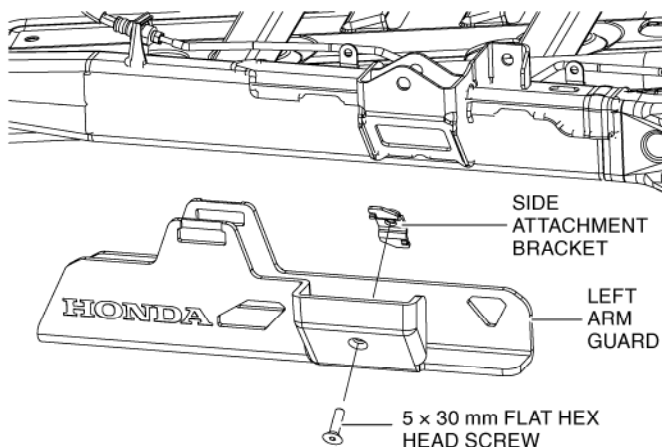

2. Position the side attachment bracket horizontally and insert the bracket through the rectangular hole in the rear arm of the vehicle.

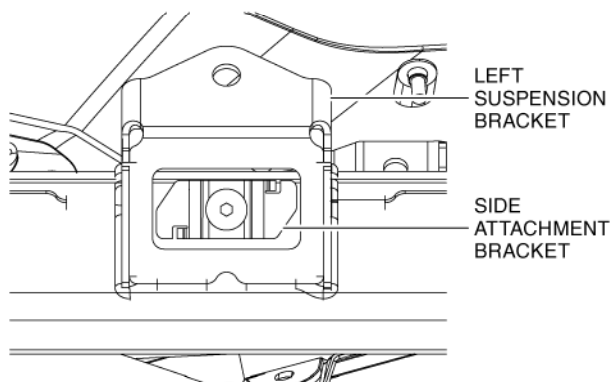

3. Rotate the side attachment bracket vertically and tighten the 5 × 30 mm hex head screw to the value specified in the TORQUE CHART.

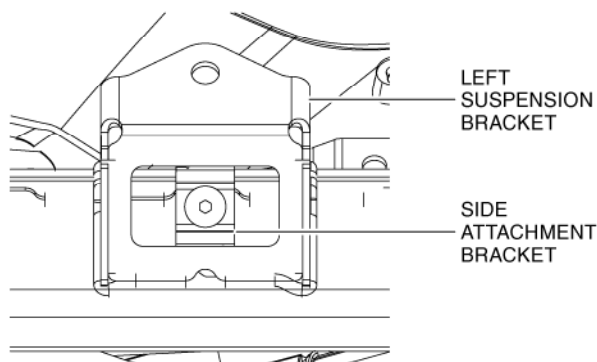

4. Unscrew the bolt and nut of the top attachment bracket assembly.

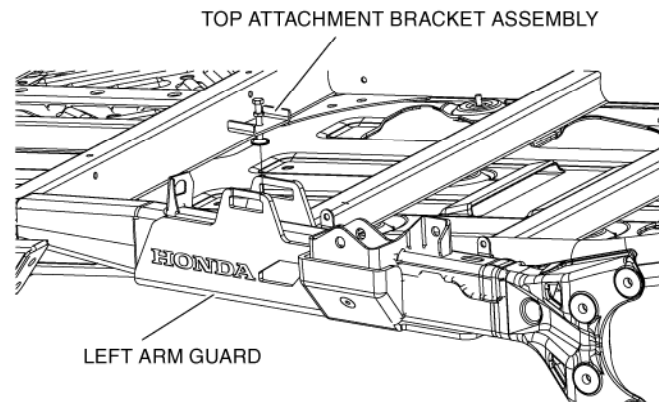

5. Place the top attachment bracket assembly on the left arm guard as shown below. Be sure to center the bracket assembly on the suspension arm then tighten the 10 mm bolt of the bracket assembly to the value specified in the TORQUE CHART.

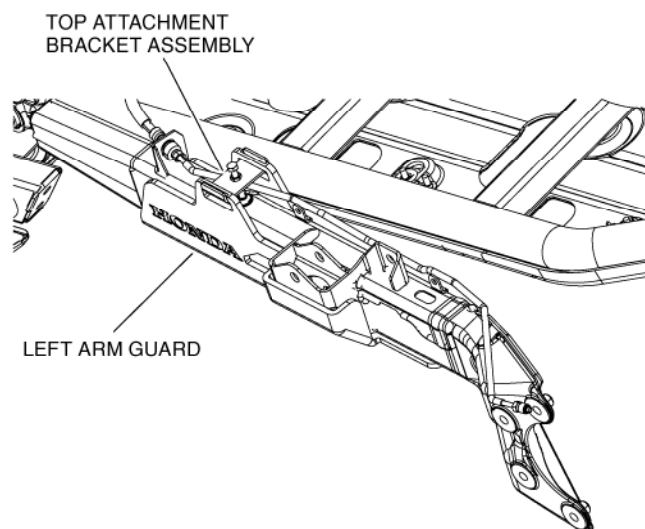

6. Repeat steps 1 through 5 on the right side.