



INSTALLATION INSTRUCTIONS

Accessory

**WINDSHIELD WIPER
WASHER KIT
P/N 0SE10-HL6-A00**

Application

**SXS1000S2R
SXS1000S2X
SXS1000S4
SXS1000S4D**

Publication No.

MII 16561

Issue Date

August 2019

Honda Dealer: Please give a copy of these instructions to your customer.

PARTS LIST

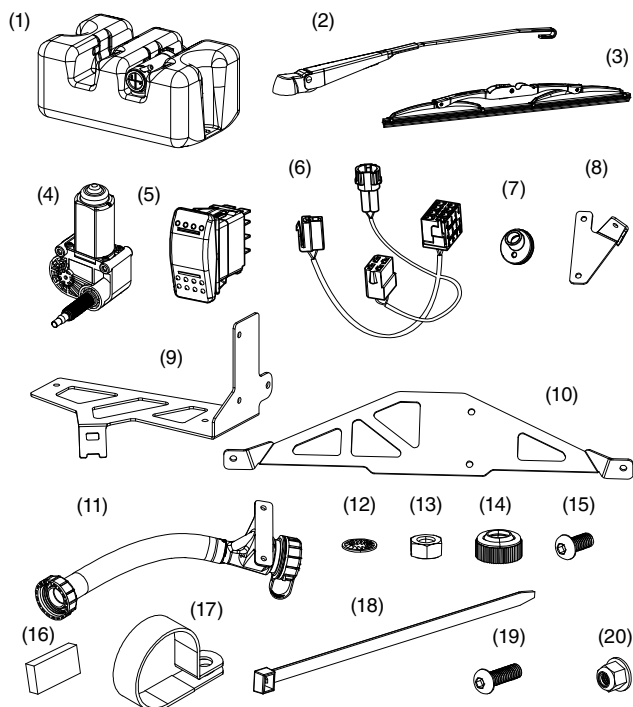

No.	Description	Qty
(1)	Washer tank	1
(2)	Wiper arm	1
(3)	Wiper blade	1
(4)	Wiper motor	1
(5)	Switch	1
(6)	Harness	1
(7)	Spindle grommet	1
(8)	Filler bracket	1
(9)	Tank bracket	1
(10)	Motor bracket	1
(11)	Filler spout	1
(12)	Toothed washer	1
(13)	Spindle nut	1
(14)	Plastic cap	1
(15)	12 mm button head bolt	2
(16)	Rubber trim	1
(17)	Clamp	2
(18)	Cable tie	3
(19)	20 mm button head bolt	6
(20)	Nylock nut	6
(21)	Installation Instruction URL (not shown)	1

GLASS WINDSHIELD

Sold separately (P/N 0SU85-HL6-A00)

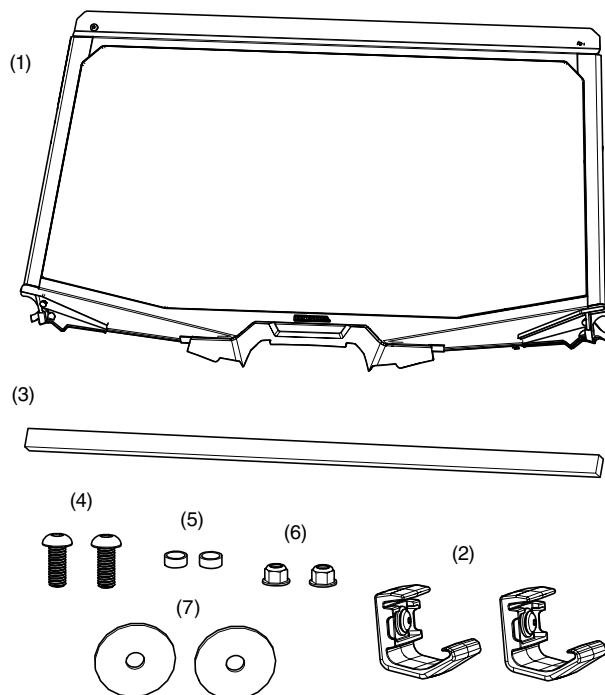

No.	Description	Qty
(1)	Glass windshield	1
(2)	Mounting clamp	2
(3)	Foam seal	1
(4)	20 mm button head bolt	4*
(5)	Spacer	2
(6)	Nylock nut	2*
(7)	Fender washer	2
(8)	Installation Instruction URL (not shown)	1

* Two of the four 20 mm button bolts (4) and both Nylock nuts (6) will come assembled to the windshield.

SWITCH PLATE/WIRE HARNESS
Sold separately (P/N 0SA30-HL6-A00)

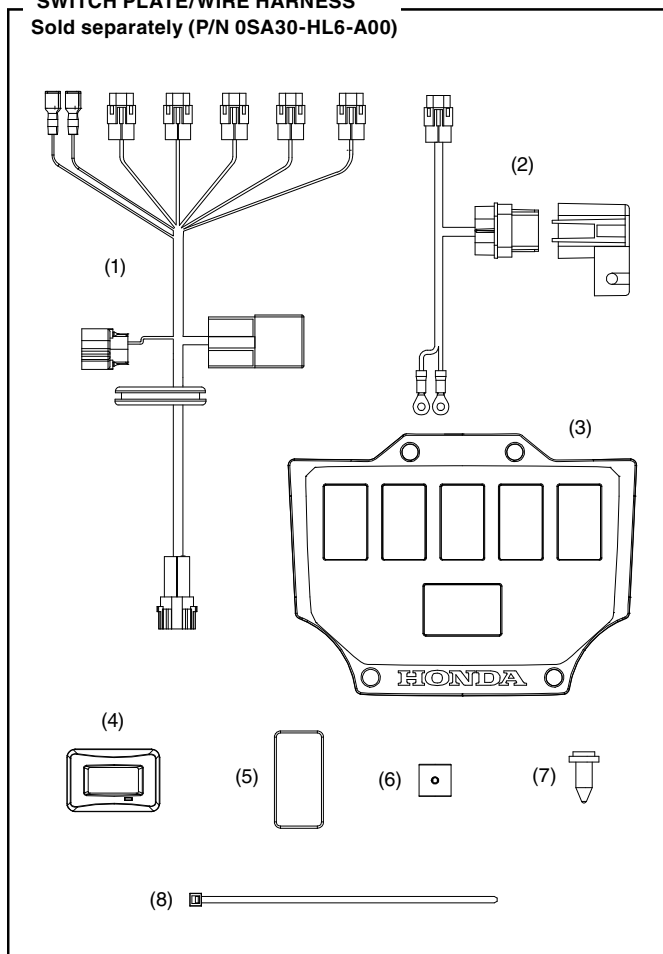

No.	Description	Qty
(1)	Main harness	1
(2)	Battery terminal harness	1
(3)	Switch cover	1
(4)	Voltmeter	1
(5)	Blank plate	4
(6)	Drill stop	1
(7)	Trim clip	4
(8)	Cable tie	8
(9)	Installation Instruction URL (not shown)	1

ACCESSORY SUB-HARNESS
Sold separately (P/N 0SZ08-HL6-A00)
*not needed if Honda Winch installed

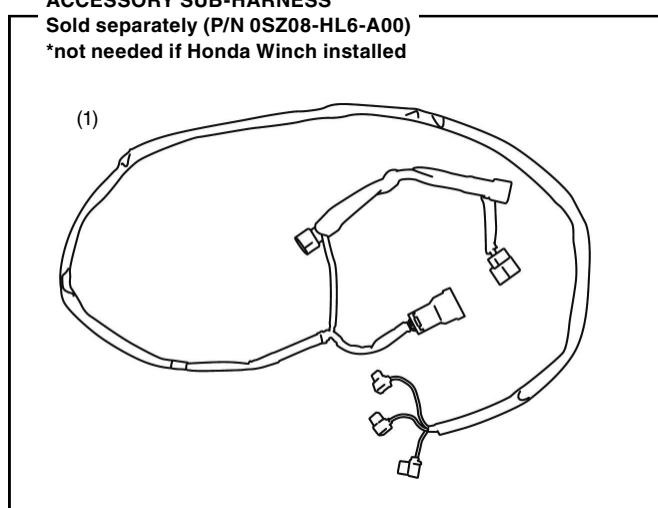

No.	Description	Qty
(1)	Accessory sub-harness	1

TOOLS REQUIRED

Power drill
1 ¼ inch hole saw bit
13 mm socket wrench
T25 Torx wrench
Pencil

USE AND CARE INFORMATION

- Check the accessory mounts frequently and retighten if necessary.
- Replace this accessory with a new one if it is damaged or discolored excessively.
- Never use petroleum solvents such as gasoline, thinner, benzine, acid, or alkaline cleaner.

INSTALLATION

⚠ CAUTION

1. Remove the glass windshield (if installed) and the hood from the vehicle and set aside.
2. Remove the heat shield and instrument panel and set aside.

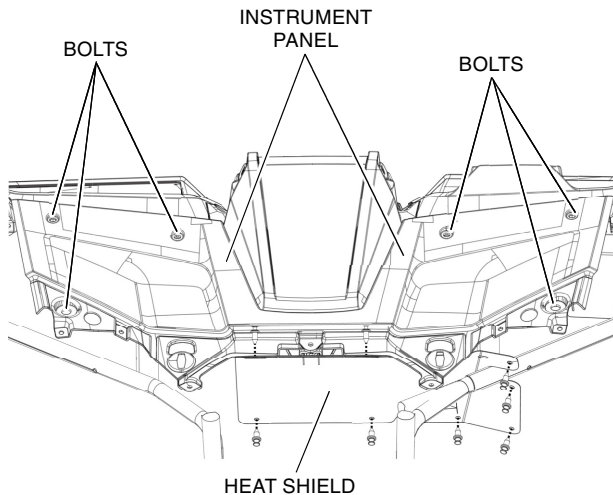

3. Install the rubber trim to the small tab on the tank bracket, then install the tank bracket to the washer tank using two 20 mm button head bolts and Nylock nuts as shown.

NOTE: Make sure the rubber trim is not covering the hole on the tank bracket tab.

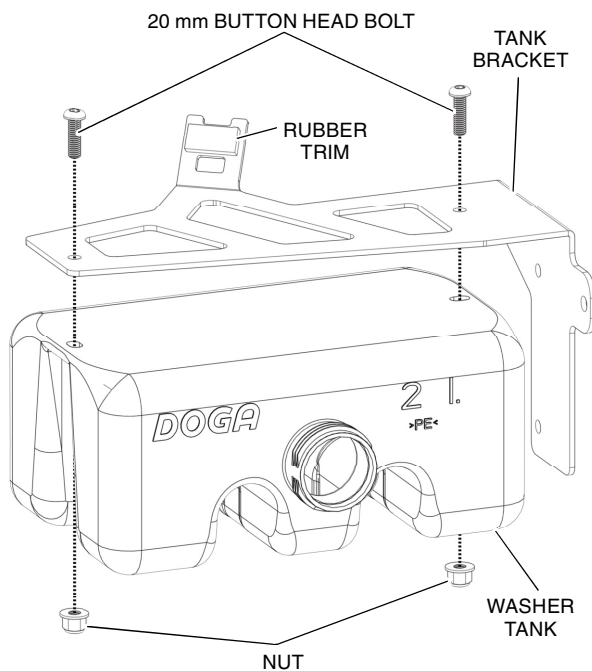

4. Remove the clip securing the wiring harness to the frame, then move the harness out of the way. Install the washer tank into the hood compartment using two clamps, 20 mm button head bolts, Nylock nuts, and one cable tie as shown.

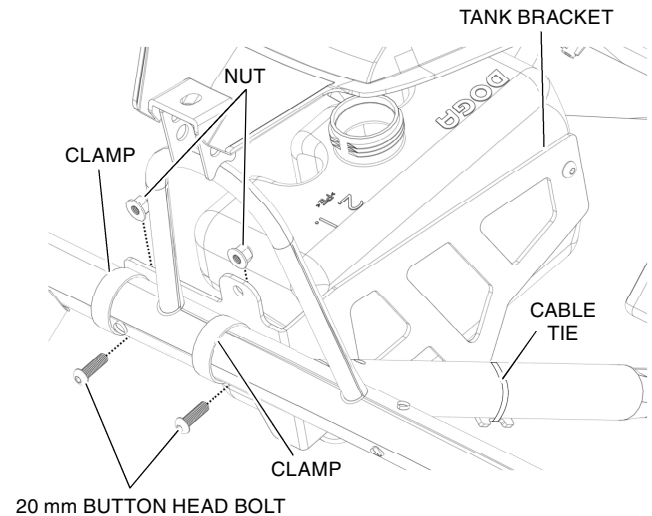

5. Insert the wiring harness clip into the hole in the tank bracket.

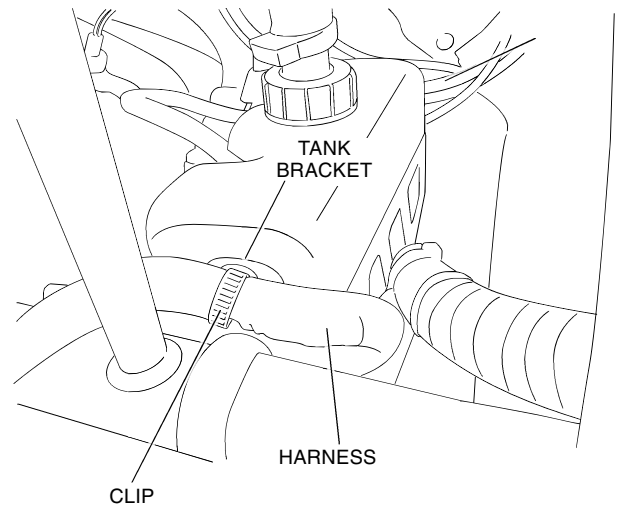

6. Cut out the supplied template and place it in the recessed area on the top of the instrument panel. Mark the location of the hole onto the dash panel using a pencil, then remove the template. Drill the hole at the marked location using a 1 ¼ inch hole saw bit.

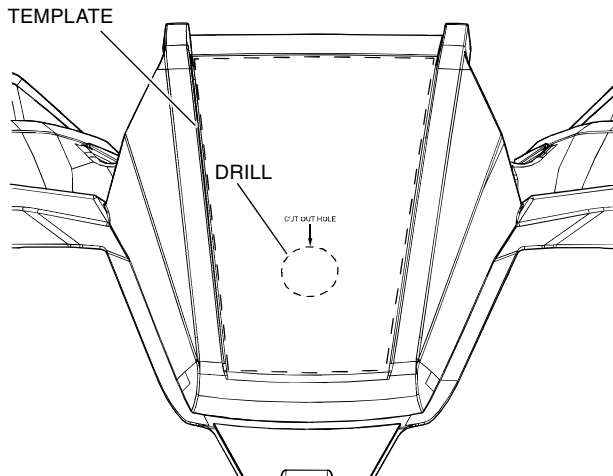

7. Install the wiper motor to the motor bracket using two 20 mm button head bolts. The spindle on the motor will be on the same side of the bracket as the two mounting tabs on the ends of the bracket.

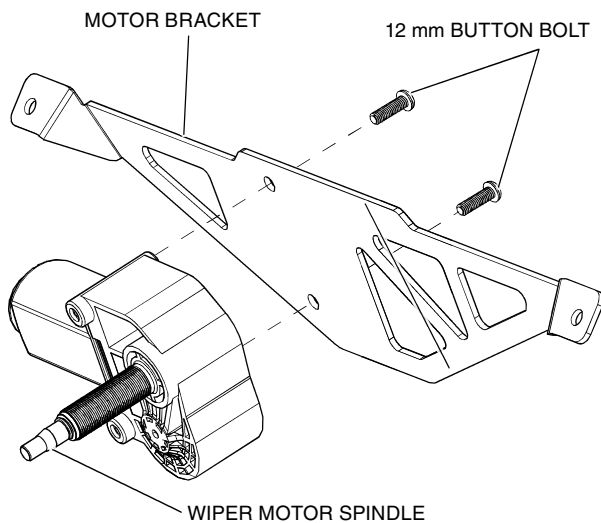

8. Position the motor bracket underneath the edge of the body panel, lining up the holes in the bracket with the holes in the panel. The spindle on the wiper motor will protrude through the drilled hole. While holding the motor bracket in place, reinstall the instrument panel. Two of the original bolts used to reinstall the instrument panel will also secure the motor bracket to the body panel.

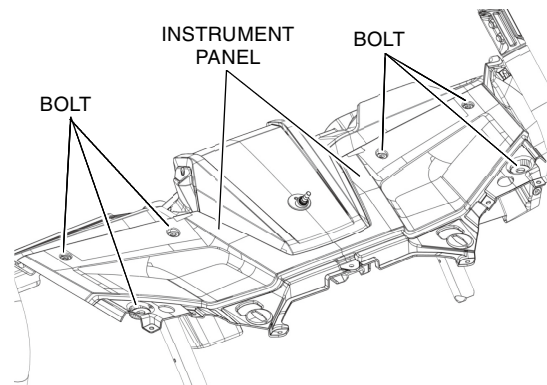
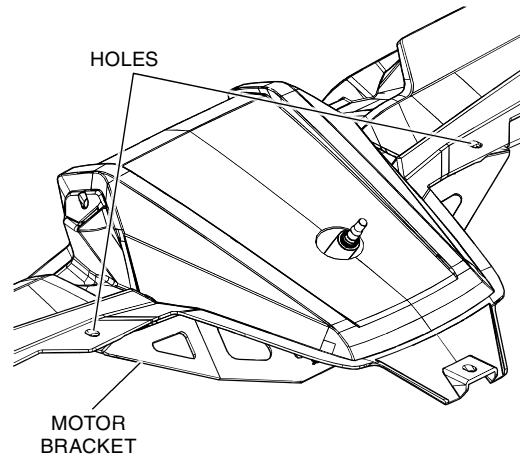

9. Install the spindle grommet into the drilled hole in the instrument panel and around the end of the wiper motor spindle.

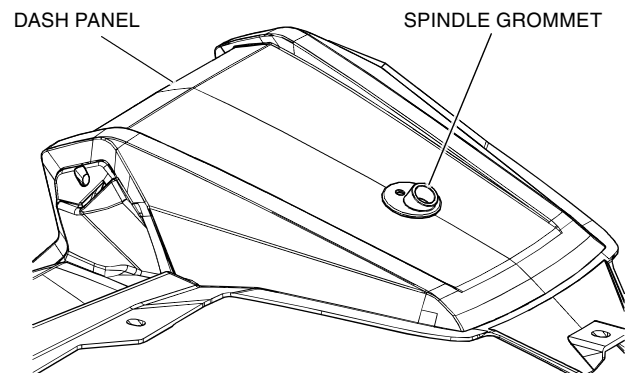

10. Attach the filler bracket to the end of the filler spout using two 20 mm button head bolts and Nylock nuts.

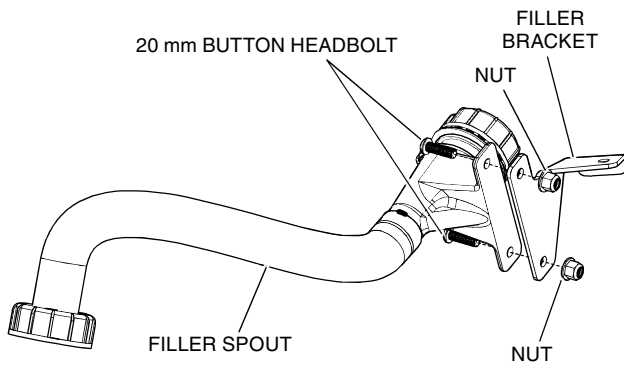

11. Thread the end of the filler spout onto the top of the washer tank as shown.

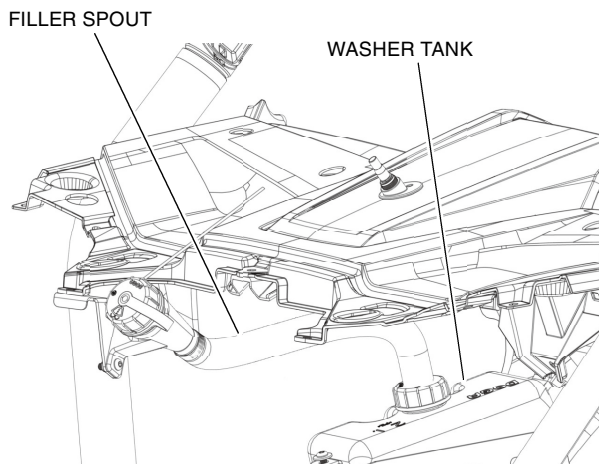

12. Attach the filler bracket to the front edge of the instrument panel using the original bolt.

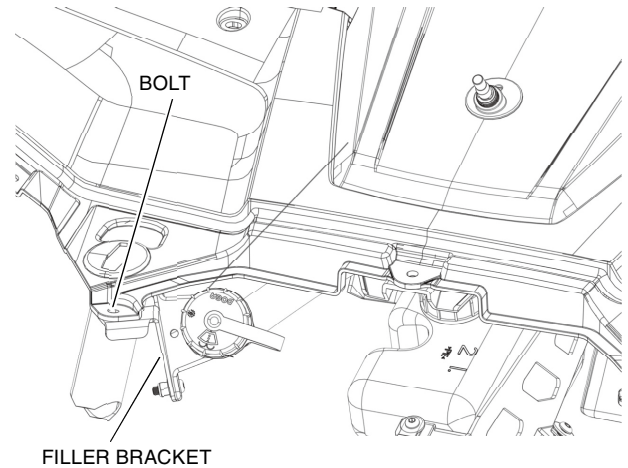

13. Insert the supplied wiring harness into the space above the washer tank. Connect the large white connector on the wiring harness to the wiper motor and connect the small white connector to the washer motor on the side of the washer tank.

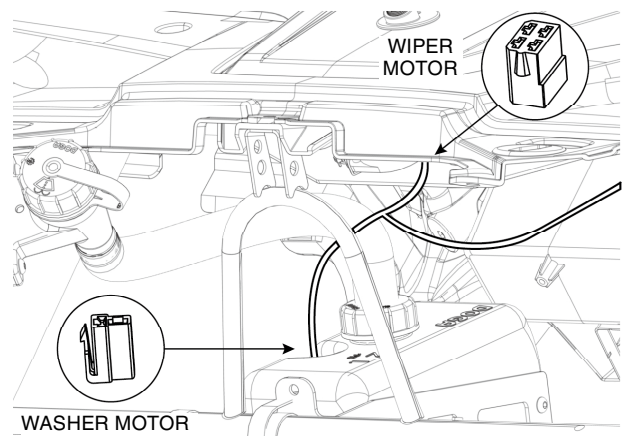

14. Loosely install the wiper arm to the wiper motor spindle using one plastic cap, toothed washer, and spindle nut.

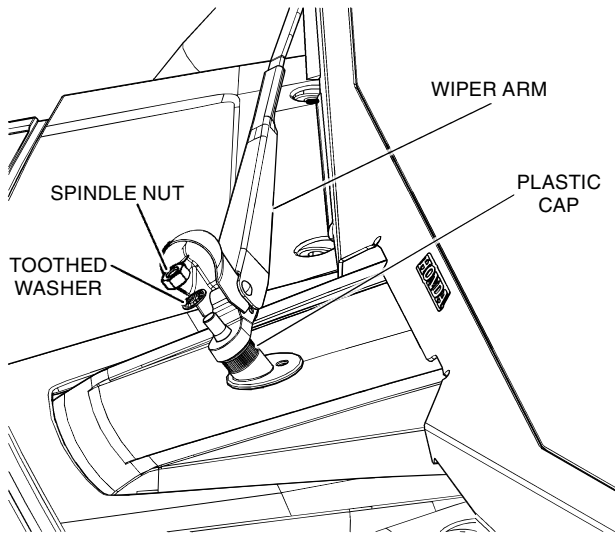

15. Route the fluid hose on the wiper arm down through the small hole in the spindle grommet. Attach the open end of the hose to the washer motor.

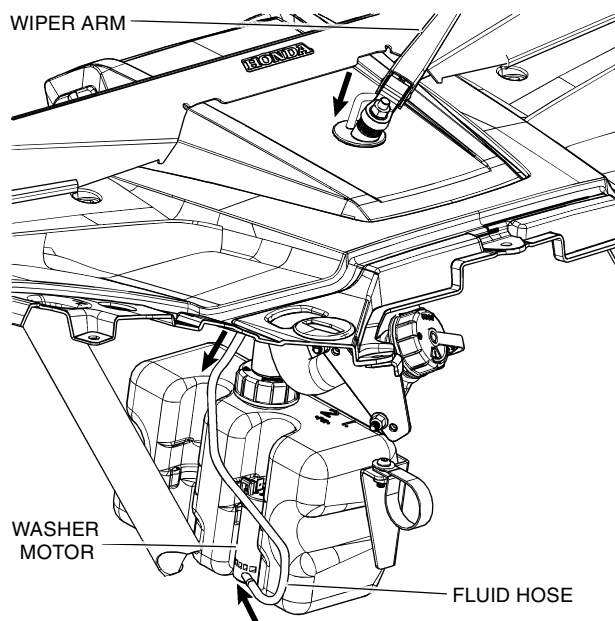

16. Install the glass windshield, then attach the wiper blade to the wiper arm.

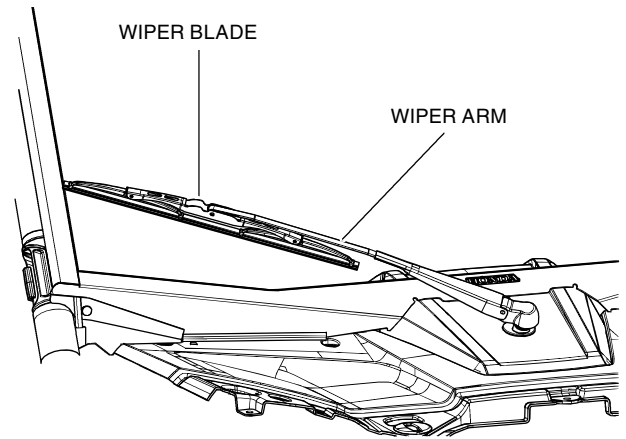

17. Remove the accessory switch cover on the inside of the vehicle. Route the large and small black connectors on the supplied wiring harness through the grommet in the back of the instrument panel and into the compartment behind the switch cover.

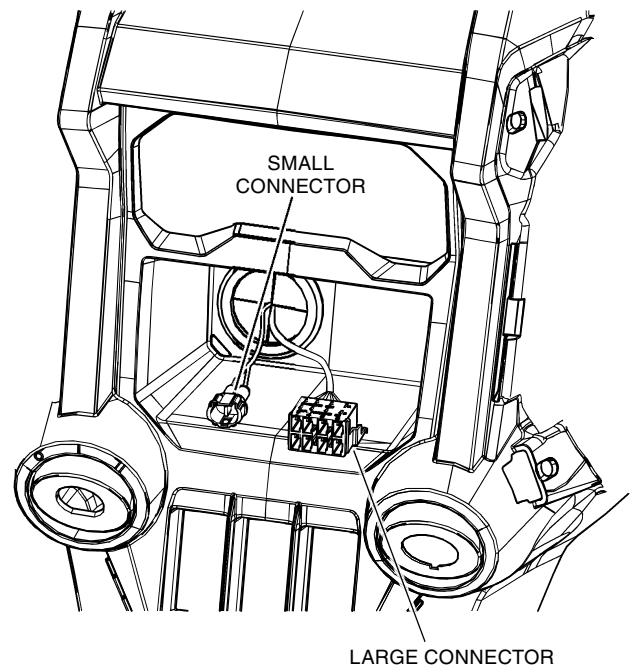

18. Remove an available blank plate from the panel, then insert the switch into the empty slot. Connect the switch to the large black connector on the wiring harness and connect the small black connector to an available two-pin connector on the switch harness.

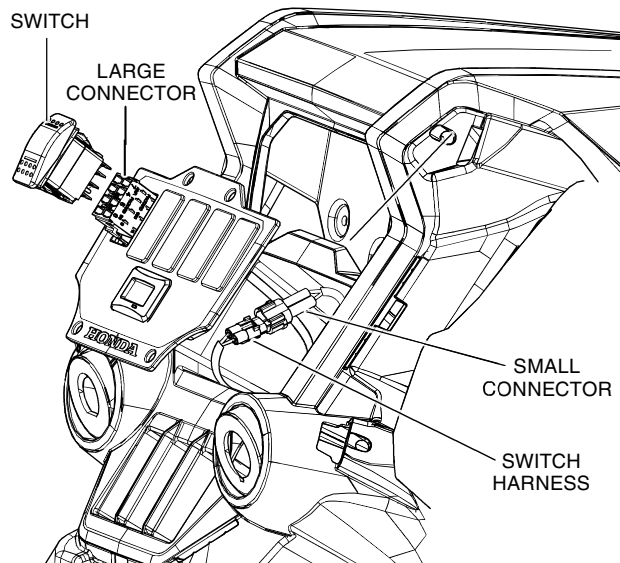

19. Reinstall the switch cover as shown.

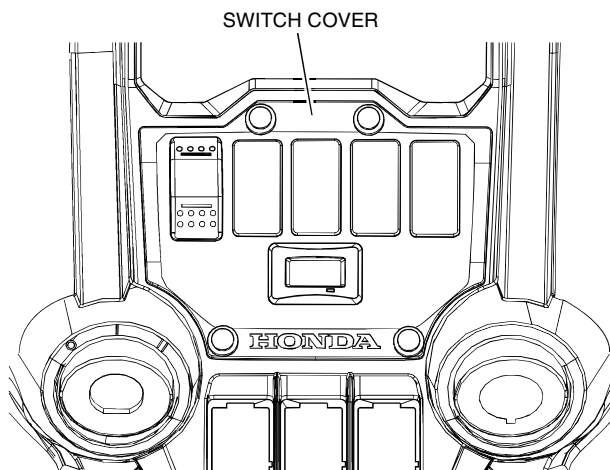

20. Fill the washer tank with windshield washer fluid.
21. Reinstall the heat shield and the hood.

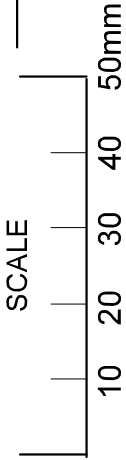
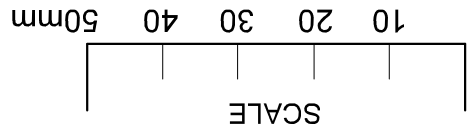

CUT OUT HOLE

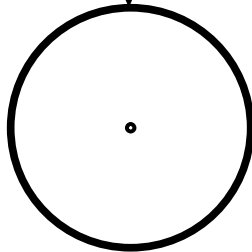

NOTICE
If you print this template from
your local computer, make sure
the printer settings do not "scale"
or "shrink" the page.

>TEMPLATE<