



# INSTALLATION INSTRUCTIONS

## Accessory

**2-PIECE FOLDING POLY  
WINDSCREEN (HARDCOAT)  
P/N 0SR72-HL3-A00**

## Application

**SXS700M2/M2D/M4/M4D**

## Publication No.

**MII 16419**

## Issue Date

**September 2017**

**Honda Dealer: Please give a copy of these instructions to your customer.**

## PARTS LIST

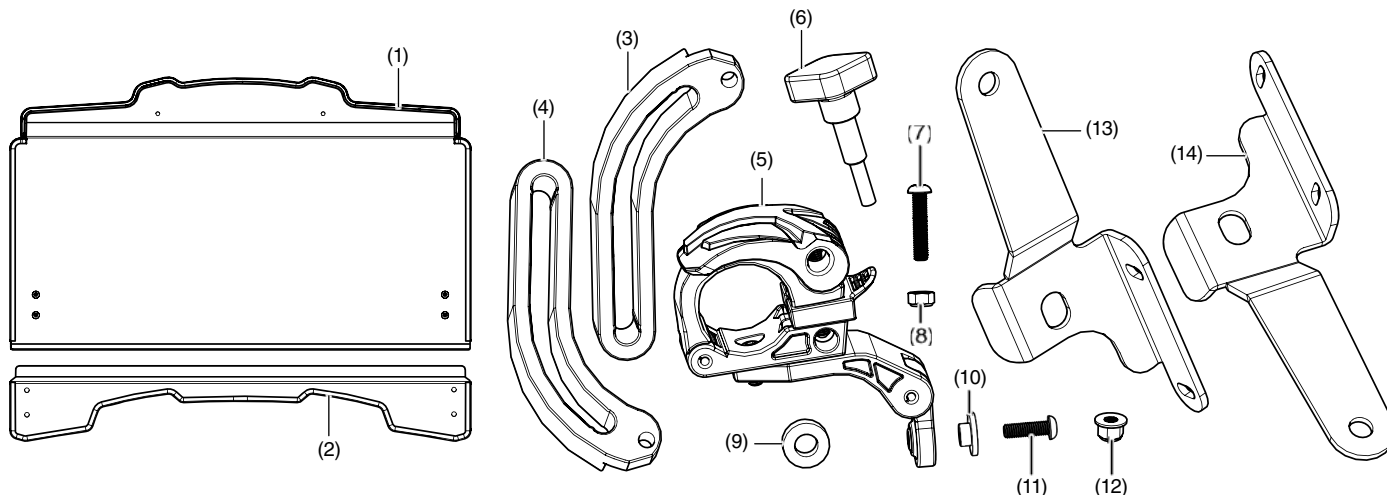

No.	Description	Qty
(1)	Upper windscreen	1
(2)	Lower windscreen	1
(3)	Left hinge arm	1
(4)	Right hinge arm	1
(5)	Cam lock clamp	2
(6)	Knob	2
(7)	6 x 30 mm screw	2
(8)	6 mm nylock nut	2
(9)	Nylon spacer	2
(10)	Shoulder spacer	6
(11)	6 x 20 mm screw	6
(12)	6 mm flange nut	4
(13)	Left bracket	1
(14)	Right bracket	1

## TOOLS AND SUPPLIES REQUIRED

Torque wrench

Socket (10 mm)

4 mm hex wrench

Ratchet

## TORQUE CHARTS

Tighten all screws, bolts, and nuts to their specified torque values. Refer to the Service Manual for the torque values of the removed parts.

Item	N-m	kgf-m	lbf-ft
6 mm screw and nut	5	0.5	4

## USE AND CARE INFORMATION

- Check the accessory mounts frequently and retighten if necessary.
- Replace this accessory with a new one if it is damaged or discolored excessively.
- When this accessory becomes dirty, rinse it thoroughly with cool water to remove loose dirt, and then wash with warm, soapy water and a clean cloth or sponge.
- Do not use a brush to clean this accessory as it may scratch the surface.
- Never use petroleum solvents such as gasoline, thinner, benzene, acid, or alkaline cleaners.

## NOTE

- Remove rubber shipping spacer before installing the clamp to the vehicle.

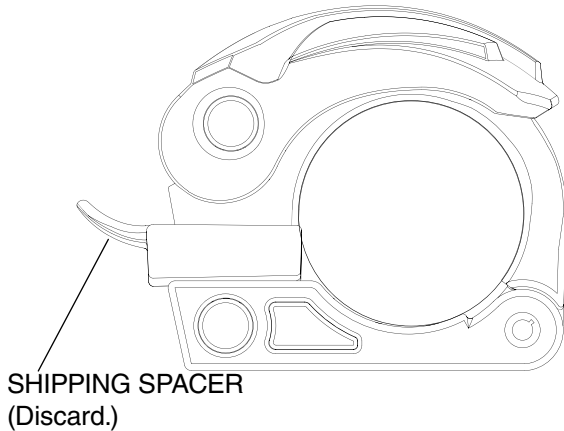

## INSTALLATION

- Remove the upper nut from the base of the left and right A-pillars as shown.
  - Remove only one nut at a time.

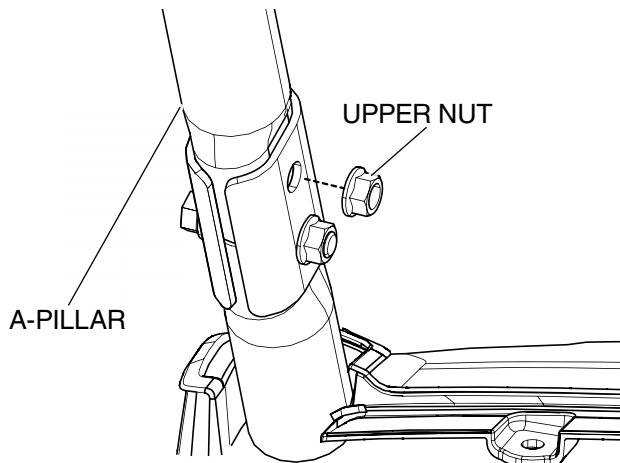

- Place the left bracket over the upper bolt of the left A-pillar and reinstall the nut removed in the previous step.

Repeat this process for the right bracket.

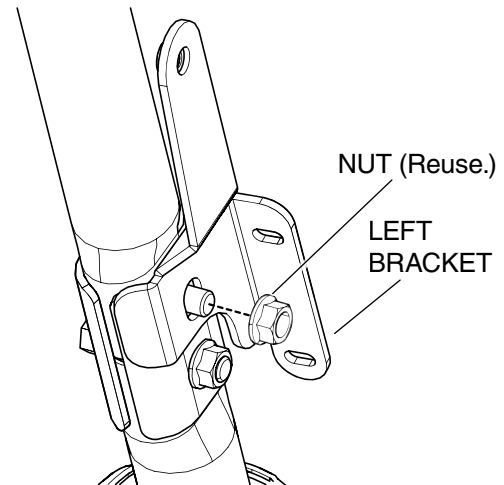

- Place the lower windscreen onto the vehicle frame and line up the holes on both sides with the holes in the brackets.
  - Seat the bottom edge of the lower windscreen along the front hood as shown.

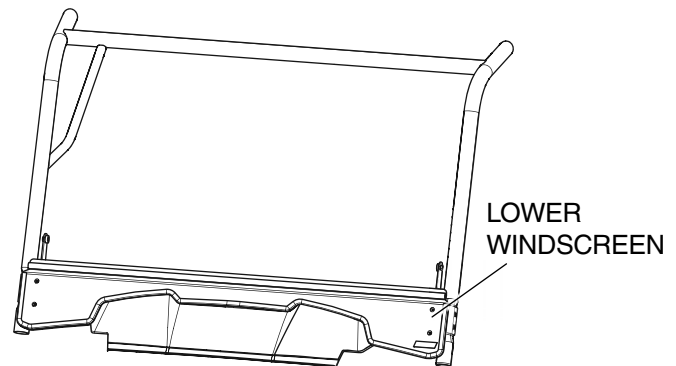

4. Line up the holes on the left side of the lower windscreen with the holes in the left bracket and install two 6 x 20 mm screws, shoulder spacers, and 6 mm flange nuts as shown.

Repeat this process for the right bracket.

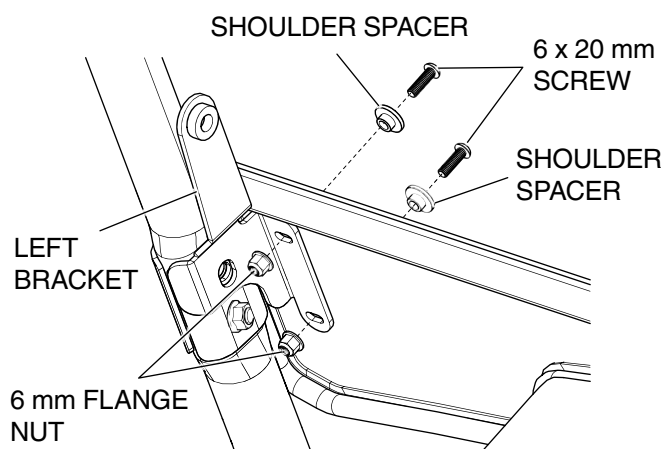

5. Insert a lock nut into the left hinge arm bracket as shown.

Insert a 6 x 30 mm screw through the hole in the left hinge arm and hinge bracket and then install the lock nut hand-tight.

- The hinge arm must rotate freely on the bracket.

Repeat this process for the right hinge arm.

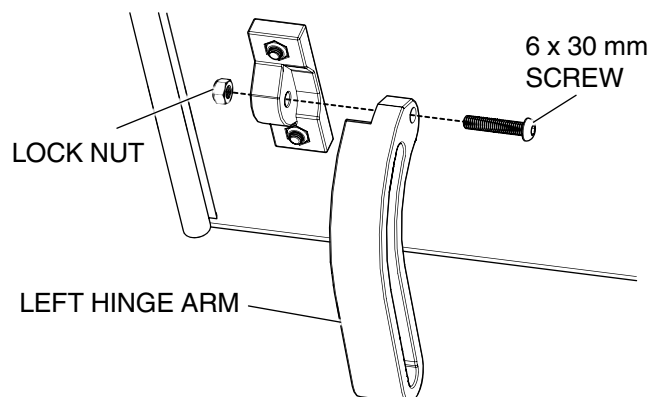

6. Install a cam lock clamp at the hole in the upper windscreen using one 6 x 20 mm screw and shoulder spacer, noting the orientation of the clamp assembly as shown.

Install the second cam lock at the other hole.

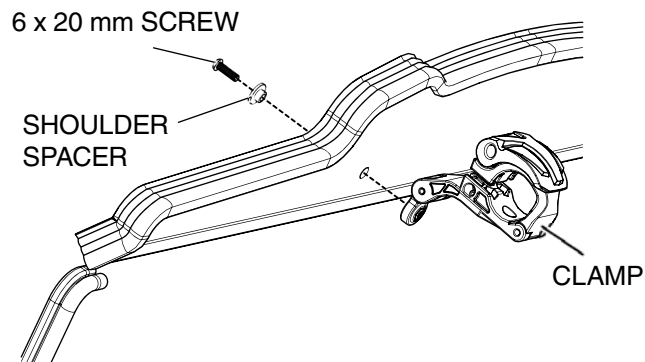

7. Place the upper windscreen onto the cab frame with its bottom edge overlapping the top edge of the lower windscreen and then close the cam locks.

- Adjust each windscreen installation so the entire overlapping edges touch each other along their entire length.

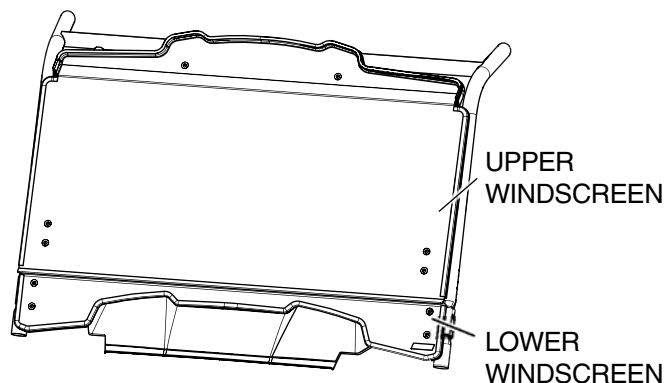

- To ensure proper fitment, close the cam locks once the gap between the edge of the windscreen and the A-pillars is even along the entire length of the windscreen.
- Approximate angle of the cam locks shown.

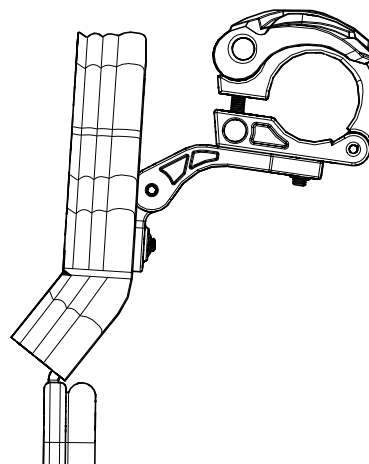

8. Line up the hinge arm with the top hole in the left bracket and place a nylon spacer between both components as shown.

Thread a knob through the hinge arm into the upper hole in the bracket as shown.

Repeat the process on the right side.

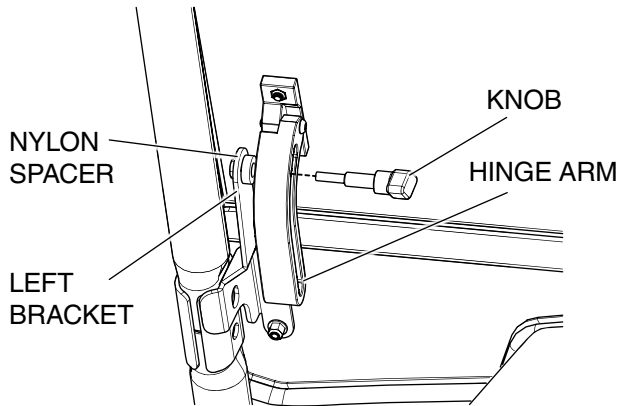

To open the windscreen, loosen the knobs and push the upper windscreen forward. When the windscreen reaches the desired opening angle, tighten both knobs.