



# INSTALLATION INSTRUCTIONS

Accessory

**WIND DEFLECTOR**  
**P/N 0SR73-HL4-200B**

Application

**SXS1000M3/M3P/M5D/M5P**

Publication No.

**MII 15262**

Issue Date

**September 2015**

**Honda Dealer: Please give a copy of these instructions to your customer.**

## PARTS LIST

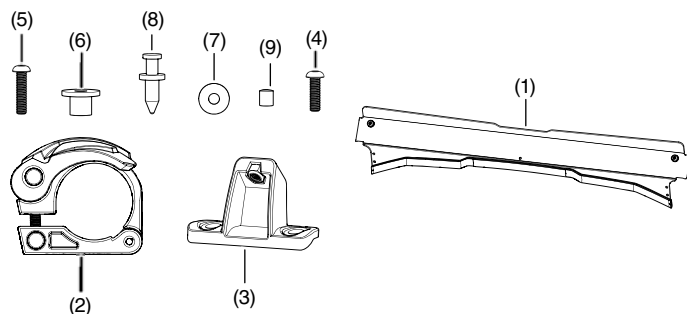

No.	Description	Qty
(1)	Wind deflector	1
(2)	Cam lock	2
(3)	Center support bracket	1
(4)	6 x 20 mm screw	1
(5)	6 x 25 mm screw	2
(6)	Flange collar	2
(7)	Flat washer	1
(8)	Trim clip	2
(9)	Small spacer	1
(10)	Installation Instruction URL (not shown)	1

## TOOLS AND SUPPLIES REQUIRED

Power drill

5/16 inch (8 mm) drill bit

4 mm hex wrench

## TORQUE CHARTS

Tighten all screws, bolts, and nuts to their specified torque values. Refer to the Service Manual for the torque values of the removed parts.

Item	N·m	kgf·m	lbf·ft
6 mm screw and nut	5	0.5	4

## USE AND CARE INFORMATION

- Check the accessory mount frequently and retighten if necessary.
- Replace this accessory with a new one if it is damaged or discolored excessively.
- When this accessory becomes dirty, rinse it thoroughly with cool water to remove loose dirt, then wipe with a clean cloth or sponge.
- Never use petroleum solvents such as gasoline, thinner, benzene, acid or alkaline cleaners.

## NOTE:

- Remove and discard the rubber shipping band from the cam lock before installation of this accessory.

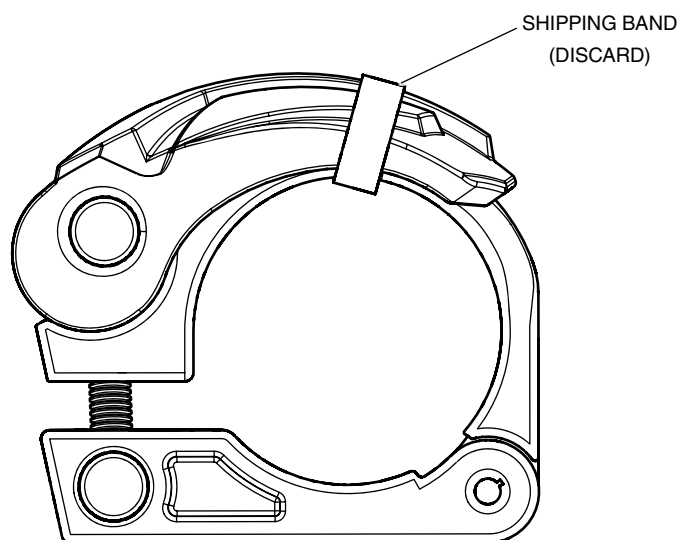

## INSTALLATION

1. Install a cam lock into each of the two side slots using one 6 x 25 mm screw and one flange collar, noting the orientation of the clamp.
  - Screw must be threaded into the hole in the base of the clamp as shown.

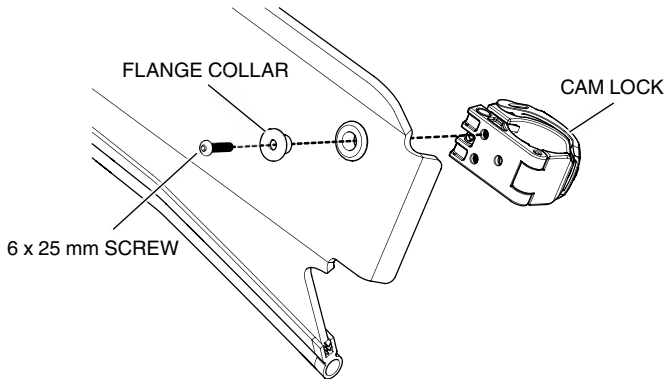

2. Open both cam locks along the sides of the wind deflector.
3. Place the wind deflector onto the vehicle and its bottom edge onto the instrument panel as shown.

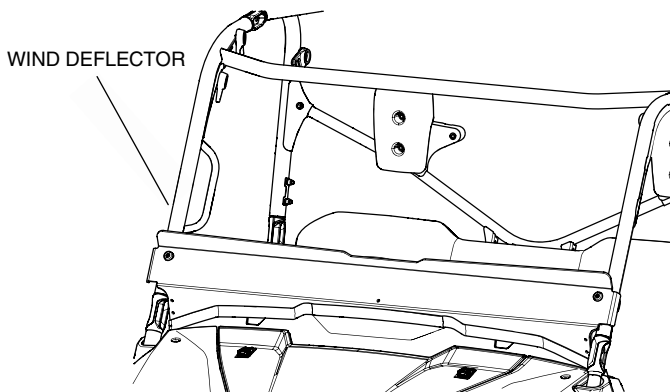

4. Install the support bracket to the inside of the wind deflector using one 6 x 20 mm screw, one small spacer, and one washer.

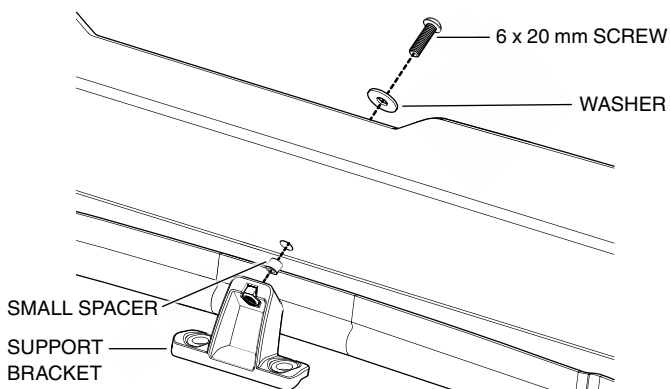

5. Using the support bracket as a template, make a mark on the instrument panel top edge through each hole in the bracket.
6. Remove the wind deflector and drill holes through the marks on the instrument panel with a 5/16 inch (8 mm) drill bit.
7. Reinstall the wind deflector and secure it to the instrument panel by placing trim clips through the windscreen bracket and into the holes.

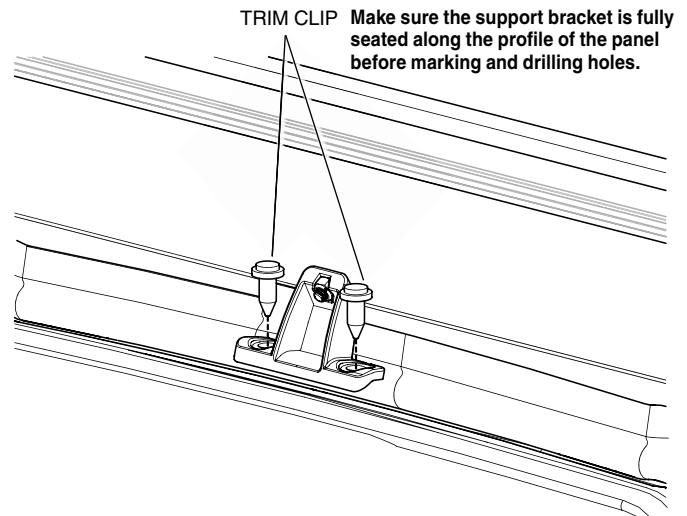

8. Align the cam locks around the cab A-pillars and snap the arm closed. Do this on both sides.

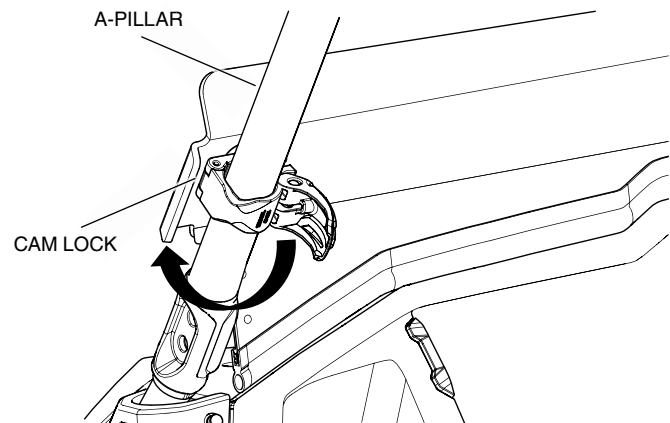

9. Adjust cam lock tension by rotating the threaded arms clockwise to tighten, counter-clockwise to loosen.

