



# INSTALLATION INSTRUCTIONS

Accessory

**BUSBAR**  
P/N 0SS27-HL3-A00

Application

**SXS700M2/M4**  
**'22 and Newer**

Publication No.

**MII 17775**

Issue Date

**August 2022**

**Honda Dealer: Please give a copy of these instructions to your customer.**

## PARTS LIST

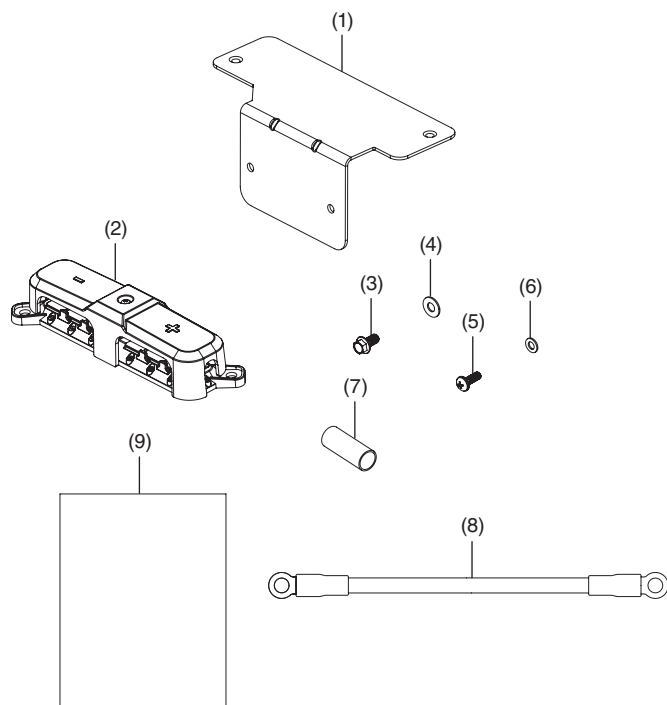

No.	Description	Qty.
(1)	Busbar mounting plate	1
(2)	Busbar	1
(3)	6 × 12 mm flange bolt	2
(4)	6 × 14 mm washer	2
(5)	5 × 14 mm screw	2
(6)	5 × 10 mm washer	2
(7)	Heat shrink	1
(8)	Harness, #6 AWG ground cable (21")	1
(9)	Installation Instructions URL	1

## TOOLS REQUIRED

Torque driver  
Socket (8 mm)  
Socket (10 mm)  
#1 phillips bit  
#2 phillips bit  
Heat gun or electrical tape

## REQUIRED ACCESSORIES

The item below is required for the installation of this accessory when installing the WARN VRX Winch and Winch Mount Kit together with the Busbar Kit.

**Busbar VRX Winch Cable**  
**Sold separately (P/N 0SL25-HL3-A00)**

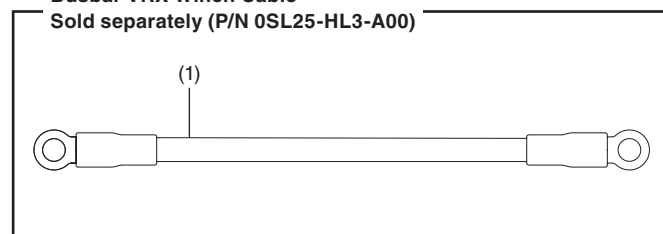

No.	Description	Qty.
(1)	Busbar cable vrx winch	1

## TORQUE CHART

Tighten all screws, bolts, and nuts to their specified torque values. Refer to the Service Manual for the torque values of the removed parts.

Item	N·m	kgf·m	lbf·ft
8 mm flange bolt	7.8	0.8	5.8
#1 drive phillips screw	1.7	0.10	0.73
#2 drive phillips screw	5.0	0.509	3.6
6 mm terminal	12.0	1.22	9.0

## INSTALLATION

1. Install all required accessories before starting installation.
2. Refer to the vehicle service manual and remove the following parts.
  - Hood
  - Ground cable connection to battery

**If vehicle is equipped with a winch:**

3. Locate the winch contactor.

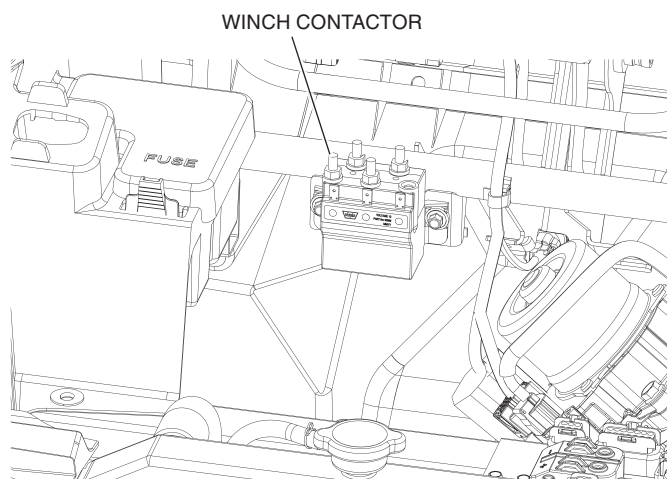

4. Pull the rubber terminal boots off the red positive power cable terminal at the winch contactor.

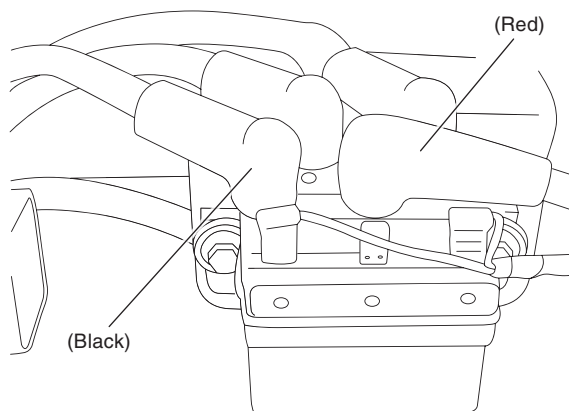

5. Remove the red positive power cable from the contactor by loosening the 6 mm nut. Set nut, lock washer and cable aside.

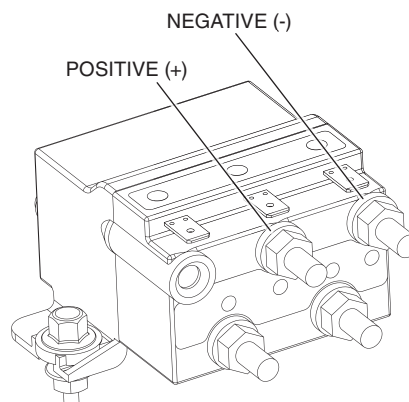

6. Remove the two 5 mm bolts, washers and nuts attaching the contactor to the frame, set contactor and hardware aside.

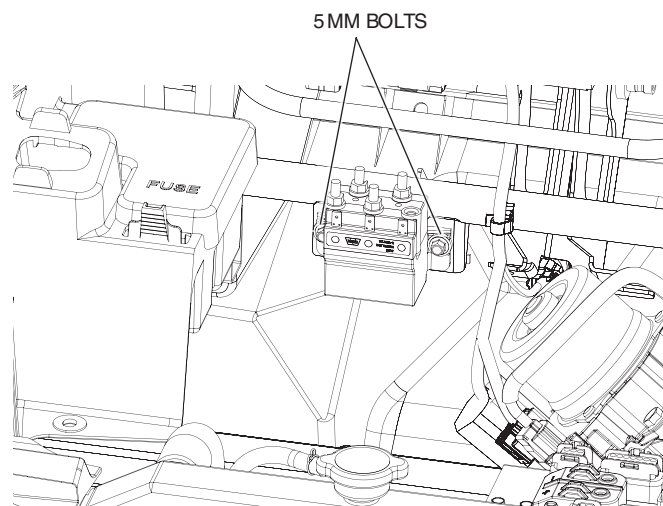

**If vehicle is not equipped with a winch:**

7. Locate the factory power (+) cable connection lead, remove tape, and move the wire out of the way.

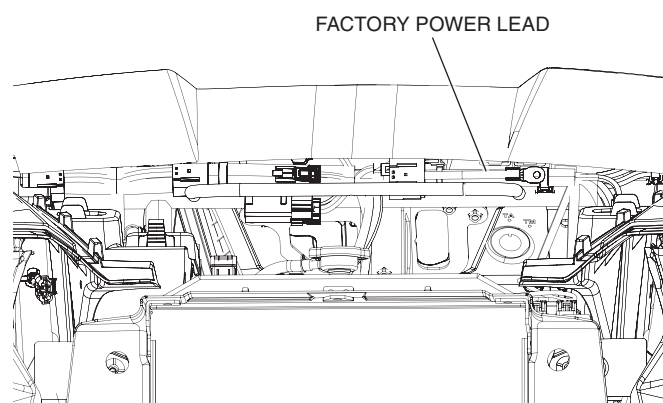

## ALL APPLICATIONS:

8. Remove the busbar cap screw and bus bar cap from the module.

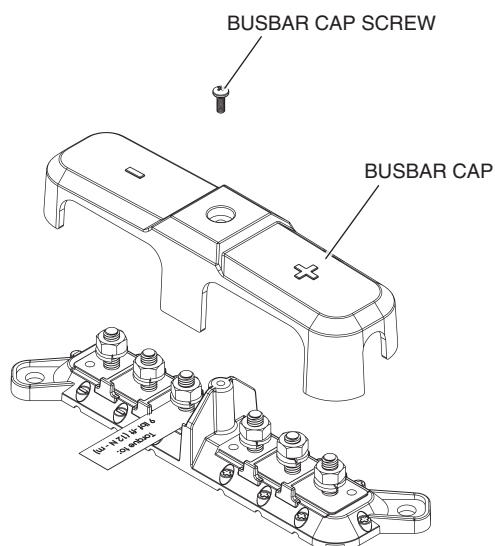

9. With the positive terminals on the driver's side, mount the busbar module to the busbar mounting plate using the two supplied 6 mm bolts and washers.

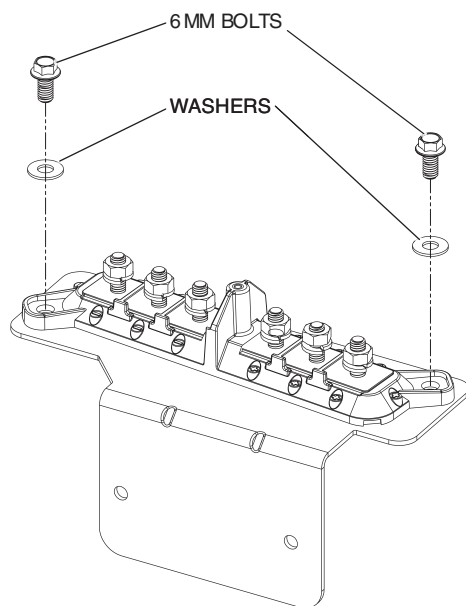

## If vehicle is not equipped with a winch:

10. A. Connect the supplied negative (-) cable connector to the negative side of the busbar as shown in the image.  
B. Connect the previously taped positive (+) power cable lead and connect it to the positive side of the busbar as shown.

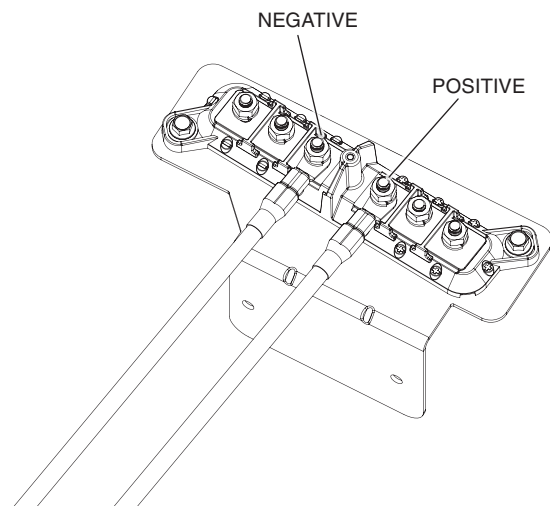

## Torque nuts to 9 lbf·ft (12 N·m).

**⚠ WARNING: Do not exceed the recommended torque specs or damage to busbar module can occur.**

11. Attach busbar mounting plate to the frame using the two 5 mm screws and washers.

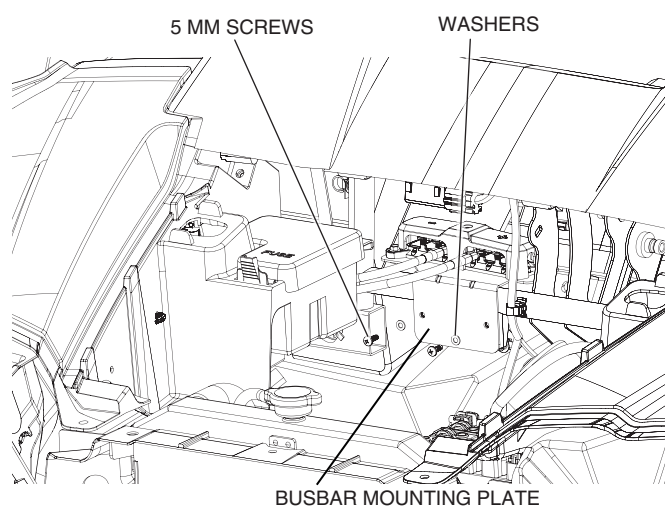

12. Route opposite end of negative (-) cable to ground bolt located on the vehicle as shown.

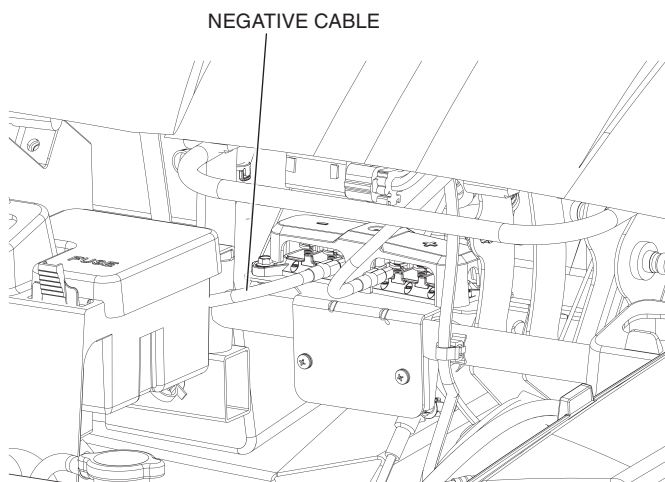

13. Locate and attach to the ground bolt located on the vehicle as shown.

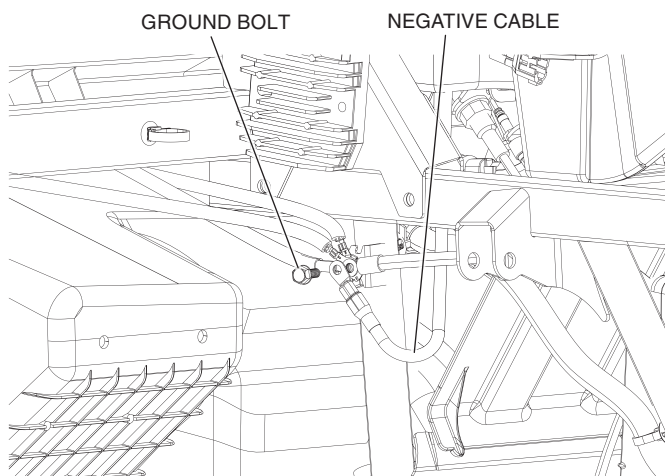

**If vehicle is equipped with a winch:**

14. Re-mount the contactor to the top of the main bus-bar mounting plate using the two pre-threaded 5 mm holes. Take the factory 5 mm bolts and washers previously removed and thread contactor to plate. Discard the factory nuts.

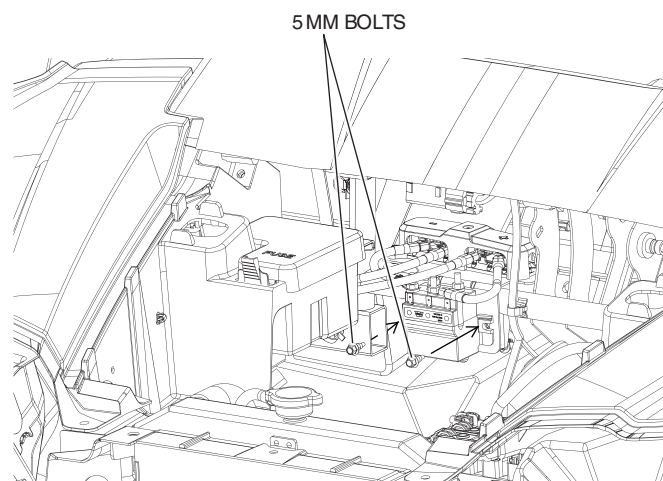

15. Locate the factory positive (+) cable connector previously removed from the winch contactor. Remove the rubber terminal boot over the end of the cable as shown.

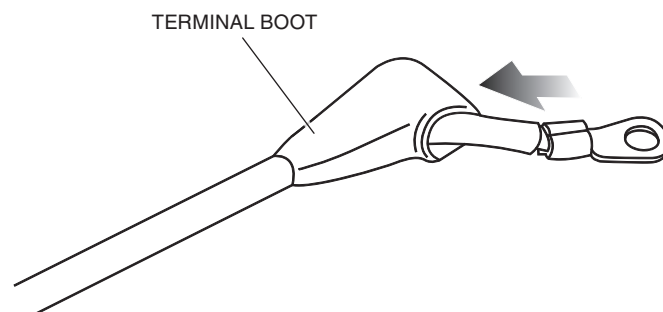



16. Use the supplied heat shrink and install it over the factory contactor positive (+) cable connector as shown. Electrical tape can be used as a substitute for the heat shrink.

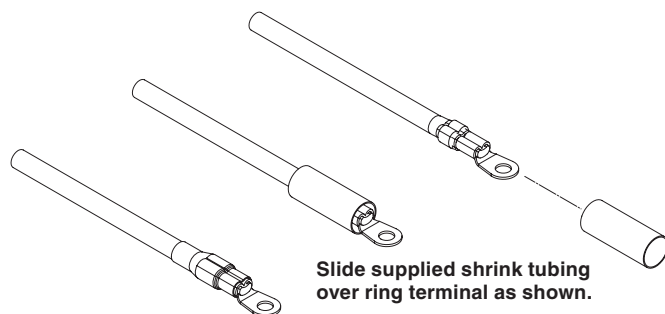

Once in place. Apply heat until shrink tubing is tightly covering the crimped section of ring terminal.

17. Connect the original positive (+) contactor wire to the busbar as shown in the image.

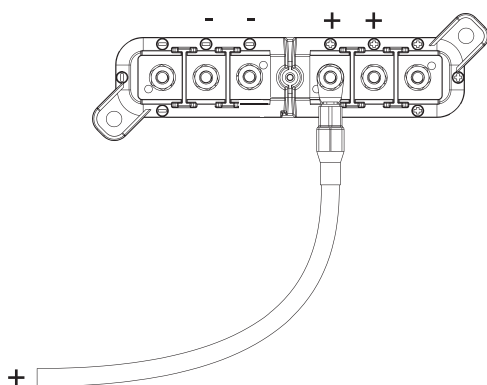

Torque nuts to 9 lbf-ft (12 N·m).

⚠ **WARNING:** Do not to exceed the recommended torque specs or damage to busbar module can occur.

18. Use the busbar Vrx winch cable positive (+) wire 0SL25-HL3-A00 ( sold separately ) to connect the busbar as shown in the image. Connect the opposite end of the cable to the winch contactor using the factory 6 mm nut and washer previously removed.

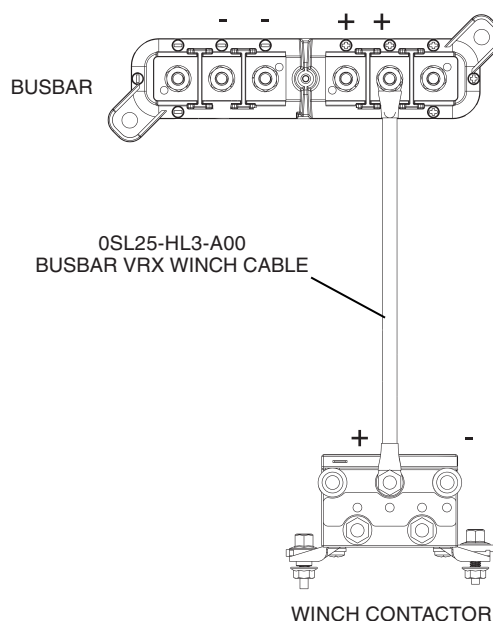

Torque nuts to 9 lbf-ft (12 N·m).

⚠ **WARNING:** Do not to exceed the recommended torque specs or damage to busbar module can occur.

**ALL APPLICATIONS:**

19. Reinstall the busbar cap and cap screw.

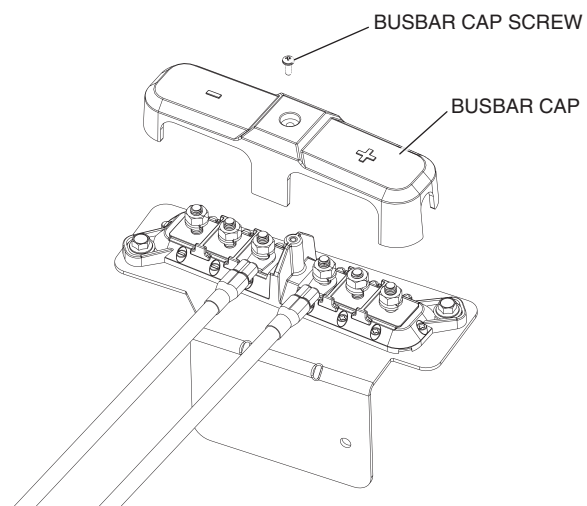

20. Reinstall the following in accordance with the vehicle service manual.

- Hood
- Ground cable connection to battery