



INSTALLATION INSTRUCTIONS

Accessory
HARD FRONT DOORS
P/N 0SU95-HL4-104

Application
SXS1000M3/M3P/M5D/M5P

Publication No.
MII 15262
Issue Date
September 2015

Honda Dealer: Please give a copy of these instructions to your customer.

PARTS LIST

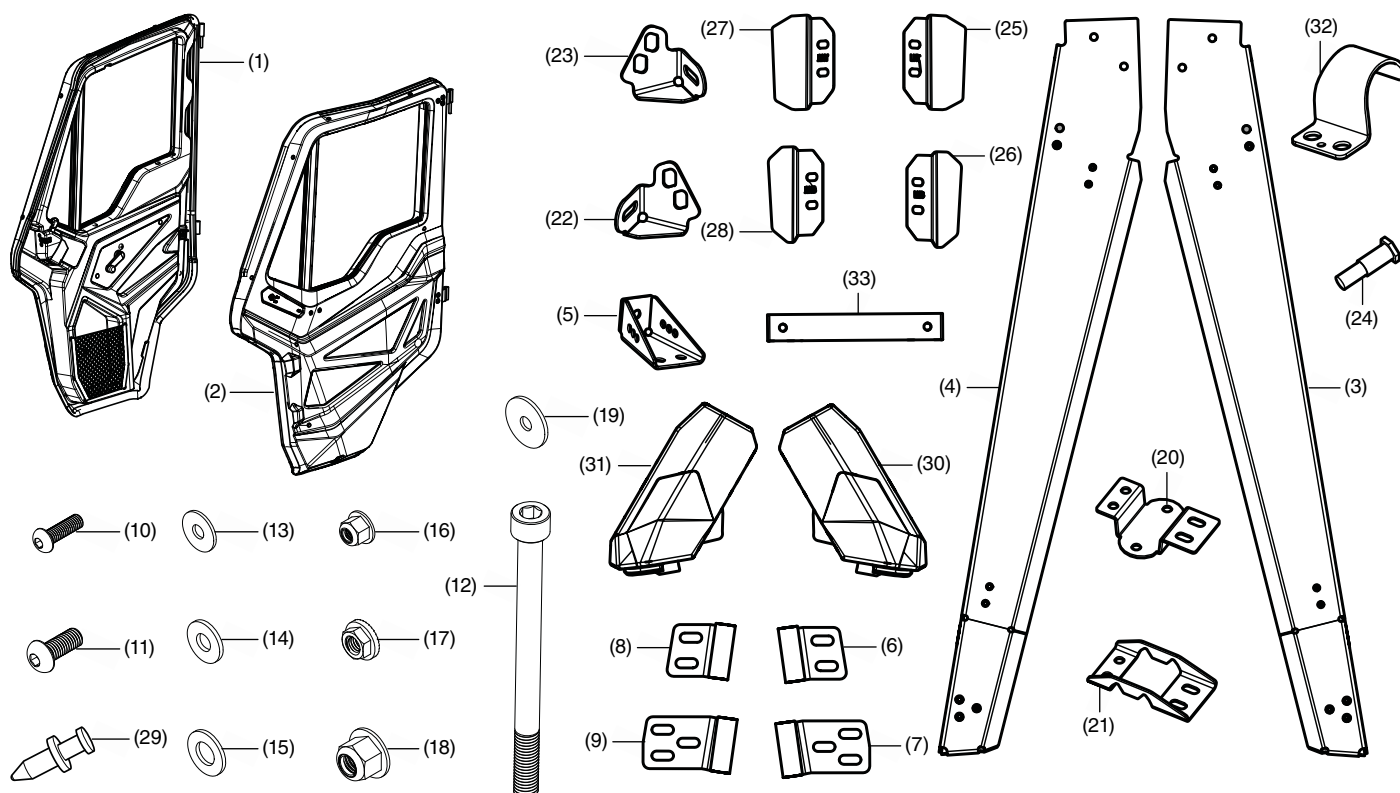

No.	Description	Qty
(1)	Door, Right	1
(2)	Door, Left	1
(3)	B-pillar bracket, Right	1
(4)	B-pillar bracket, Left	1
(5)	B-Pillar brace	2
(6)	Upper Left hinge	1
(7)	Lower Left hinge	1
(8)	Upper Right hinge	1
(9)	Lower Right hinge	1
(10)	6 x 20 mm bolt	4
(11)	8 x 20 mm bolt	36
(12)	10 x 130 mm bolt	2
(13)	6 mm flat washer	4
(14)	8 mm washer	36
(15)	10 mm flat washer	6
(16)	6 mm nylock nut	4
(17)	8 mm flange nut	18
(18)	10 mm nylock nut	4

No.	Description	Qty
(19)	Fender washer	4
(20)	Inner striker clamp	2
(21)	Outer striker clamp	2
(22)	Striker bracket, Right	1
(23)	Striker bracket, Left	1
(24)	Striker pin	2
(25)	Top-left cover (LHT)	1
(26)	Bottom-left cover (LHB)	1
(27)	Top-right cover (RHT)	1
(28)	Bottom-right cover (RHB)	1
(29)	Trim clip	10
(30)	Striker bracket cover, Right	1
(31)	Striker bracket cover, Left	1
(32)	Strap clamp	4
(33)	Door tether	2
(34)	1-1/2 inch Foam tape (not shown)	1
(35)	1 inch Foam tape (not shown)	1
(36)	Installation Instructions URL (not shown)	1

TOOLS AND SUPPLIES REQUIRED

4 mm hex wrench	10 mm socket wrench
5 mm hex wrench	12 mm socket wrench
8 mm hex wrench	15 mm socket wrench
Power drill	5/8 inch socket wrench
5/16 inch drill bit	

TORQUE CHART

Tighten all screws, bolts, and nuts to their specified torque values. Refer to the Service Manual for the torque values of the removed parts.

Item	N·m	kgf·m	lbf·ft
6 mm bolt and nut	5.5	0.6	4
8 mm bolt and nut	20	2	15
Striker pin	34	3.4	25

USE AND CARE INFORMATION

- Check the accessory mounts frequently and retighten if necessary.
- Replace this accessory with a new one if it is damaged or discolored excessively.
- When this accessory becomes dirty, rinse it thoroughly with cool water to remove loose dirt, then wipe with a clean cloth or sponge.
- Never use, or expose the doors to petroleum solvents such as gasoline, thinner, benzene, acid, or alkaline cleaners.

INSTALLATION

1. Remove the stock left-side door from the vehicle, including all hinge and striker hardware attached to the cab frame.
2. Install the plate over each recessed area left by the front hinges using the stock bolts from the hinges.

Use the engravings on each plate to ensure it is mounted in the correct location: LHT: Left-hand top; LHB: Left-hand bottom; RHT: Right-hand top; RHB: Right-hand bottom.

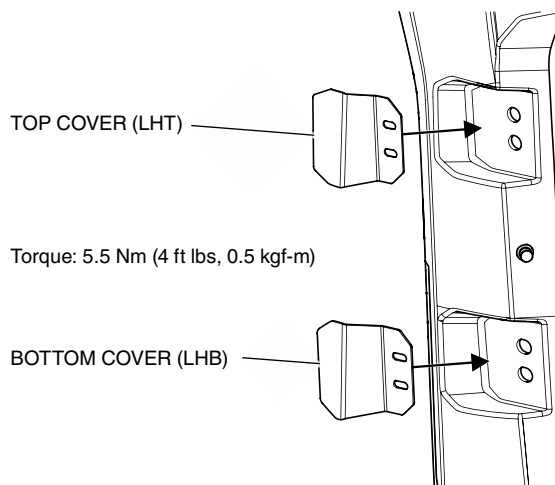

3. Orient the Left B-pillar bracket into place as shown. Attach the top of the B-pillar bracket to the cab frame using two 8 x 20 mm bolts, 8 mm washers, and 8 mm flange nuts as shown.

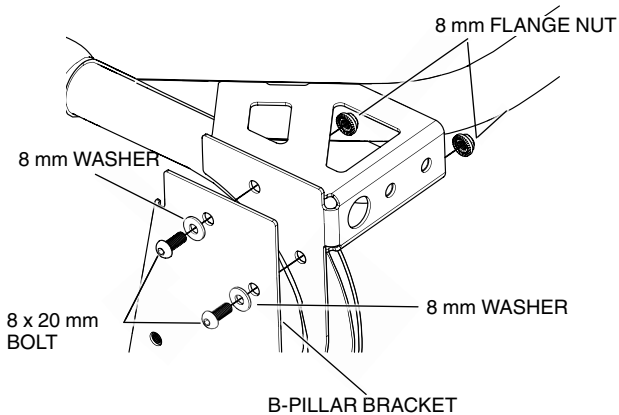

4. Install two strap clamps to the B-pillar bracket so they wrap around the cab frame tube using two 8 x 20 mm bolts and 8 mm washers per clamp as shown.

Top clamp:

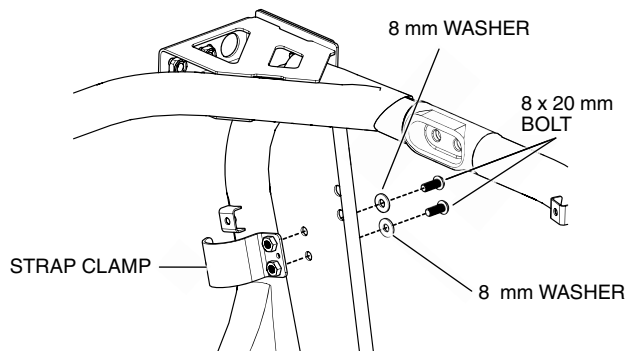

<BOTTOM CLAMP>

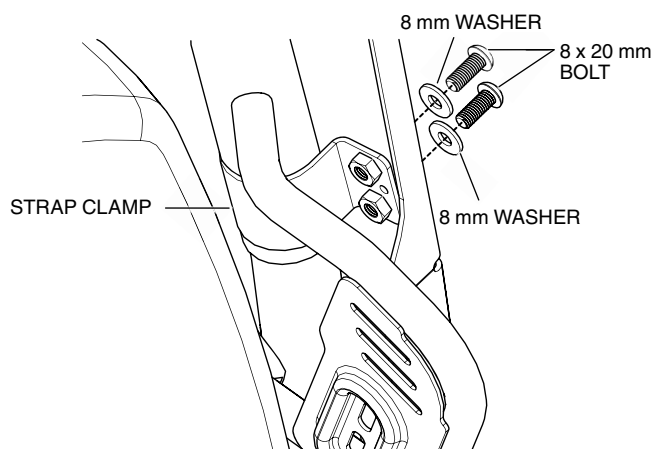

5. Install the top hinge to the B-pillar bracket using two 8 x 20 mm bolts and 8 mm washers as shown.
6. Install the bottom hinge to the B-pillar bracket using three 8 x 20 mm bolts and 8 mm washers as shown.
 - Each hinge is unique, make sure you have the correct hinge for each side before installing.
 - Tighten the hinge hardware snug for later adjustment (not fully torqued).

<TOP HINGE>

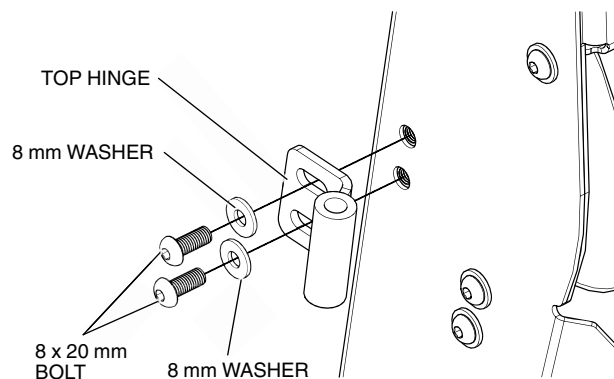

<BOTTOM HINGE>

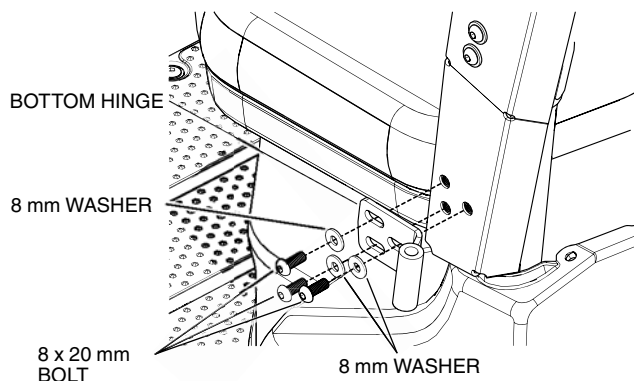

7. Install the B-pillar brace between the B-pillar bracket and the cab frame handle using three 8 x 20 mm bolts, 8 mm washers, and 8 mm flange nuts per brace, as shown.

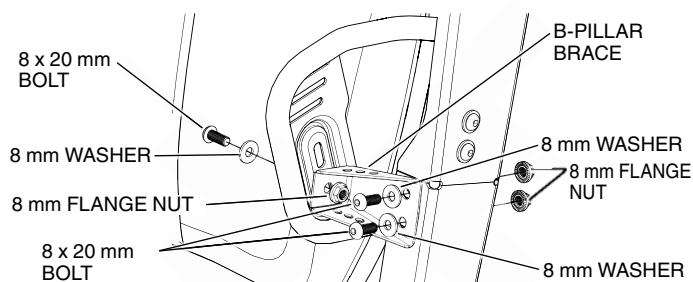

8. Hold the left striker bracket [1] between the outer [2] and inner [3] striker clamp and arrange them around the profile of the Left A-pillar as shown.
9. Assemble the bracket and both clamp brackets to the A-pillar using four 8 x 20 mm bolts, 8 mm washers, and 8 mm flange nuts.
 - The striker clamps must be installed with the slots facing the rear of the vehicle.
 - Tighten hardware snug for later adjustment (not fully torqued) .

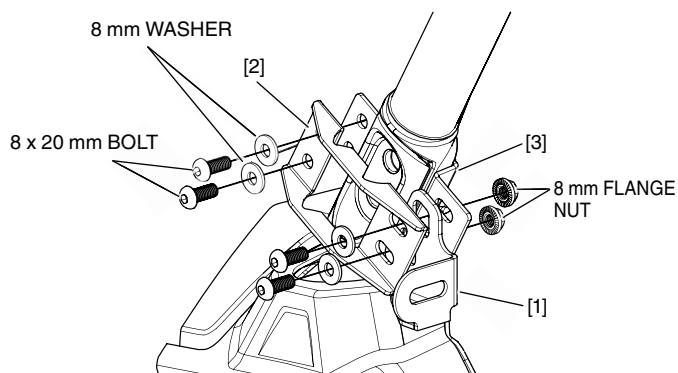

10. Loosely install a striker pin to the left striker bracket using a 10 mm flat washer and 10 mm lock nut.
 - Tighten hardware snug for later adjustment (not fully torqued).

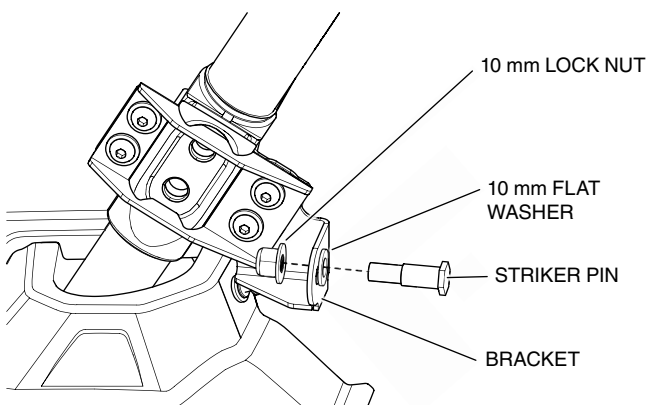

11. Using two people, lift the left door and position the upper hinge pin on the door, close to the upper hinge on the B-pillar bracket.
12. Place a 10 mm flat washer over the door hinge pin and hold it in place.
13. Slowly lower the door so that the hinge pin slides smoothly into the B-pillar hinge.

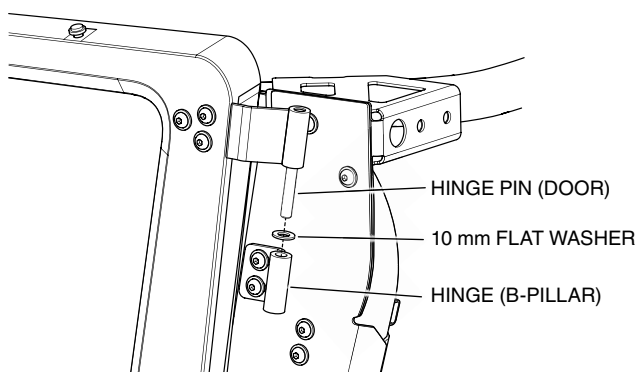

14. While the door is being supported, carefully line up the lower female hinges and insert a washer between them.
 - Have one person lift the door up slightly while the other person places the washer between the lower hinges.

15. Place the 10 x 130 mm bolt through both lower hinges and washer from the top, and then loosely install a 10 mm lock nut on the bottom of the bolt.
 - The lock nut should be snug to secure the door during the adjustment process, but not torqued completely yet.
 - Install the lock nut three full threads past the point of engaging the nylock.
 - Do not overtighten the lock nut; the door must be able to swing open freely.

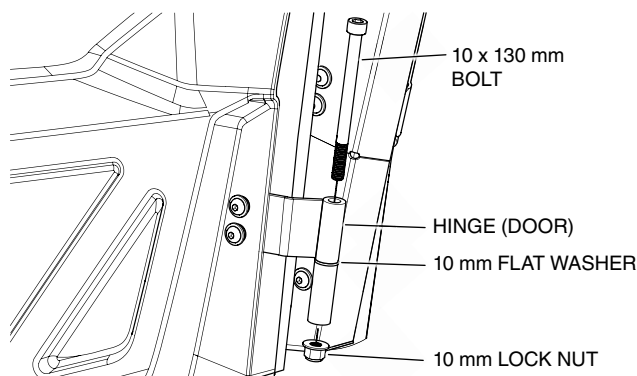

16. Attach the door tether to the top side of the bracket on the inside of the door using one 6 x 20 mm bolt, 6 mm flat washer, 1/4 inch fender washer, and 6 mm lock nut as shown.
17. Attach the other end of the tether to the B-pillar brace using one 6 x 20 mm bolt, 6 mm flat washer, 1/4 inch fender washer, and 6 mm lock nut.
 - The door must be in the OPEN position when torquing the door tether.
 - Use the series of holes in the B-pillar brace to set the desired opening angle for the door.
 - To prevent premature tether failure, fully torque all tether hardware.

<TO DOOR>

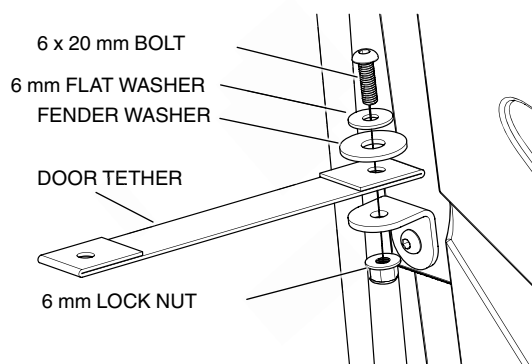

<TO CAB FRAME>

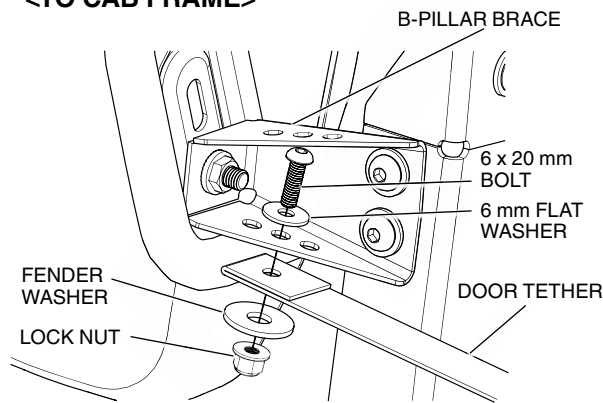

18. Adjust the position of the doors as follows:

- a. Align the door's position front to back, making adjustments using the slots in the door hinges. The rubber door trim must make contact with the vehicle's body/frame along the entire outside perimeter of the door.

Tighten the hinge hardware snug to allow for future adjustments, do not torque completely at this time.

- b. Adjust the striker pin until the door latches smoothly and the door trim compresses evenly along the entire cab frame.

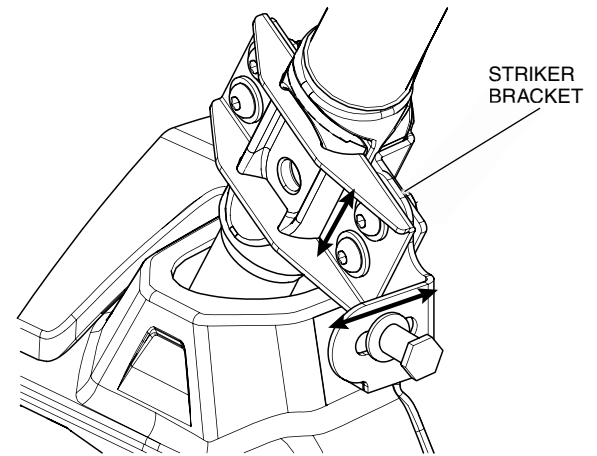
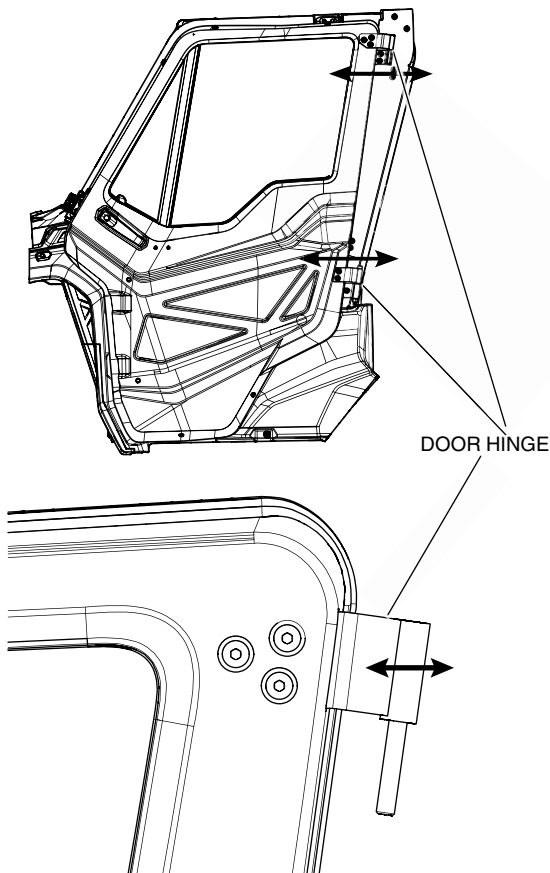

- c. Adjust striker bracket position until the door latches completely, then re-tighten the rear striker bracket hardware.
- d. Repeat adjustment steps a-c as needed until proper door alignment is achieved.

Note: If additional adjustment is needed at the door hinges, loosen the B-pillar hinge hardware and slide the hinges out as shown. Do not adjust the B-pillar hinges unless desired position cannot be achieved by only adjusting the door mounted hinges.

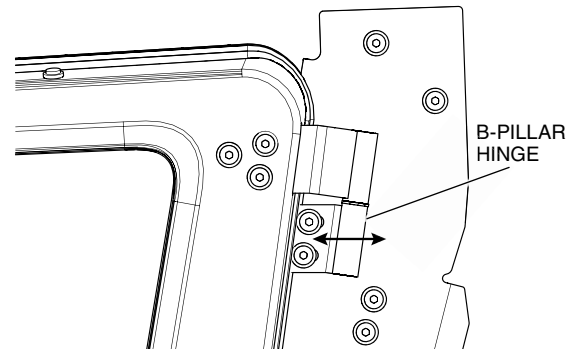

19. Once all adjustments have been made and the door is properly aligned with the vehicle, tighten all hardware to the values specified in the Torque Chart.

20. Place the Left striker bracket cover over the striker bracket as shown. Install the cover to the bracket using a trim clip in the location shown.

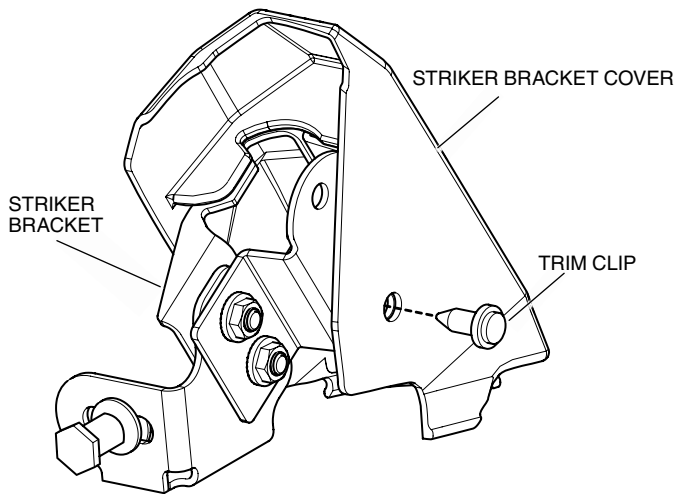

21. Repeat Steps 1 through 20 to install the passenger-side door.

FOAM TAPE INSTALLATION (OPTIONAL)

1. Install the foam tape as necessary to seal any gaps between the hard door and cab frame.

COLOR PANEL INSTALLATION (M3P/M5D; or M3/M5P with Accessory Color Panels)

1. If your vehicle is equipped with color panels, refer to the Service Manual (or Accessory Installation Instructions) and remove the colored panel from the standard door.
2. Completely roll up the windows on both hard doors. Remove the two stock trim clips from the locations shown.

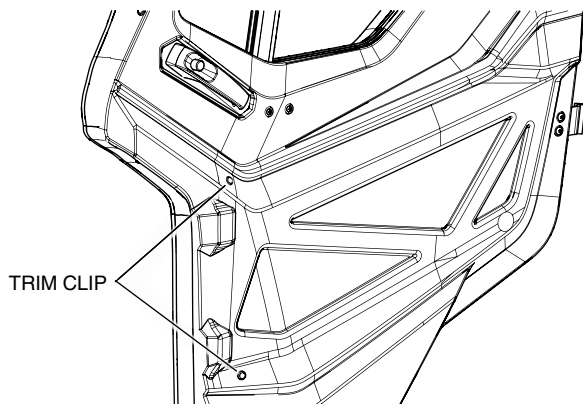

3. Place the color panel over each hard door, lining up the holes in the color panel with the locations of the trim clips removed in Step 2. Make a mark on the hard door at the location of the remaining four holes as shown.
4. Remove the color panels. Drill 5/16 inch holes in the hard door at the marked locations.

NOTE: The windows must be completely rolled up before drilling.

NOTE: Maintain shallow drill bit penetration (no greater than 3/8 inch) to avoid damaging the doors.

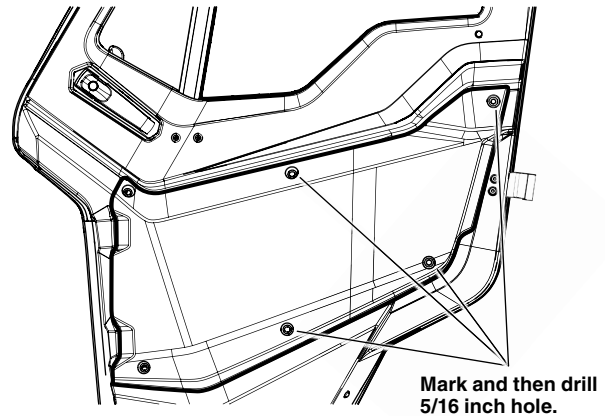

5. Install the color panel to the hard door by reusing the two removed trim clips and four new trim clips as shown.

