

SOUTHERN HONDA POWERSPORTS

Model Name	PIONEER 1000-5 DELUXE	Product Line	ALL TERRAIN VEHICLE
Model ID	SXS1000M5D	Year	2016
Mfg	USA	Area	
Section	FRAME	Clr Label	
		Illustration	FRONT DOOR

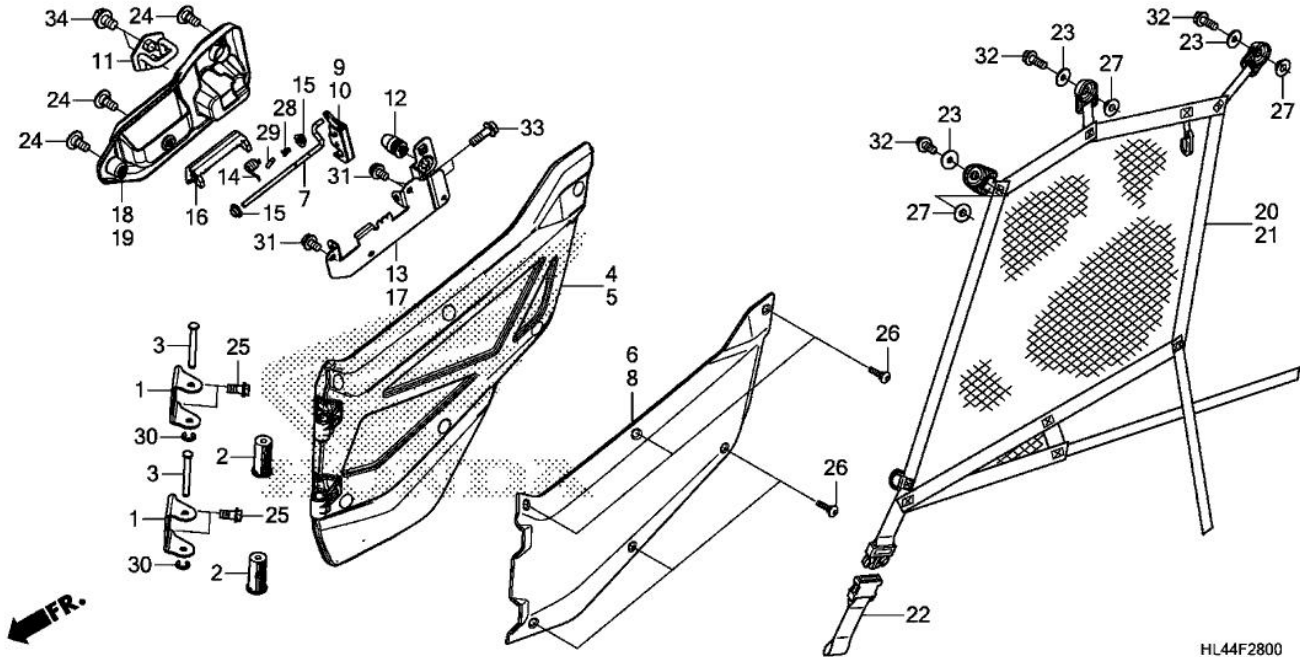

Ref.	Part Number	Part Description	Qty.
001	67150-HL4-A00	BRACKET, HINGE	004
002	67151-HL3-A00	COLLAR, HINGE	004
003	67153-HL3-A00	PIN, HINGE	004
004	67205-HL4-A10ZA	DOOR, R. FR. *NH1*(BLACK)	001
005	67215-HL4-A10ZA	DOOR, L. FR. *NH1*(BLACK)	001
006	67225-HL4-A10ZB	PANEL, R. FR. DOOR *R232*(PATRIOT RED)	001
006	67225-HL4-A10ZC	PANEL, R. FR. DOOR *NH196*(ROSS WHITE)	001
006	67225-HL4-A10ZE	PANEL, R. FR. DOOR *NHB68MR*(NEMESIS SILVER METALLIC R)	001
006	67225-HL4-A20ZA	PANEL, R. FR. DOOR *YRA05L*(CLOSE RANGE CAMO)	001
007	67230-HL1-A00	LEVER, DOOR	002
008	67235-HL4-A10ZB	PANEL, L. FR. DOOR *R232*(PATRIOT RED)	001
008	67235-HL4-A10ZC	PANEL, L. FR. DOOR *NH196*(ROSS WHITE)	001
008	67235-HL4-A10ZE	PANEL, L. FR. DOOR *NHB68MR*(NEMESIS SILVER METALLIC R)	001
008	67235-HL4-A20ZA	PANEL, L. FR. DOOR *YRA05L*(CLOSE RANGE CAMO)	001
009	67236-HL1-A01	LATCH, R. DOOR	001
010	67237-HL1-A01	LATCH, L. DOOR	001
011	67238-HL1-A00	STRIKER, DOOR	002
012	67239-HL1-A00	STOPPER, DOOR	002
013	67240-HL4-A00	PLATE, R. DOOR LEVER	001
014	67241-HL1-A00	SPRING, DOOR LEVER	002
015	67243-HL1-A00	BUSH, FLANGE (6MM)	004
016	67244-HL1-A00ZA	HANDLE, DOOR *NH1*(BLACK)	002
017	67250-HL4-A00	PLATE, L. DOOR LEVER	001
018	67251-HL4-A00ZA	COVER, R. DOOR *NH1*(BLACK)	001
019	67252-HL4-A00ZA	COVER, L. DOOR *NH1*(BLACK)	001
020	67310-HL4-A00	NET ASSY., R. FR. SIDE	001
021	67320-HL4-A00	NET ASSY., L. FR. SIDE	001
022	67330-HL4-A00	NET ASSY., SIDE (A)	002
023	77302-124-000	WASHER, SEAT MOUNTING	006
024	90106-KBV-000	SCREW, PAN (6X14)	006
025	90109-GS9-610	BOLT, SPECIAL (8MM)	008

SOUTHERN HONDA POWERSPORTS

Model Name	PIONEER 1000-5 DELUXE	Product Line	ALL TERRAIN VEHICLE
Model ID	SXS1000M5D	Year	2016
Mfg	USA	Area	
Section	FRAME	Clr Label	
		Illustration	FRONT DOOR

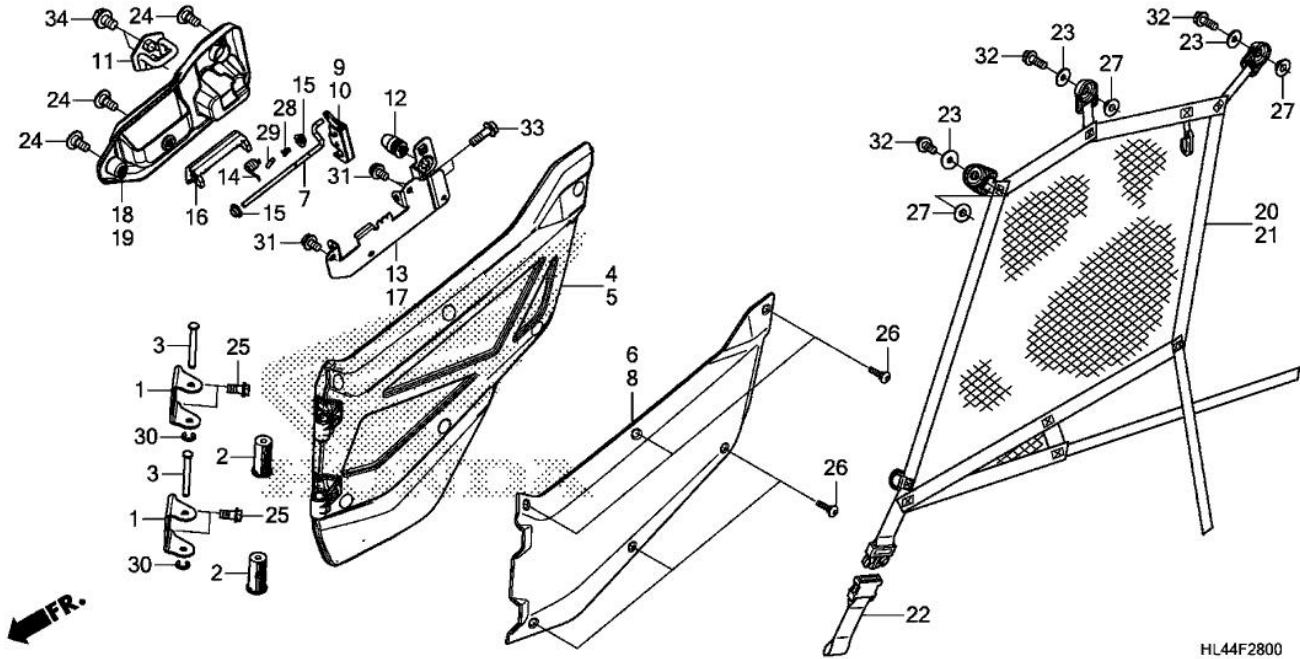

Ref.	Part Number	Part Description	Qty.
026	90114-MFL-000	SCREW, SPECIAL (6X16)	012
027	90127-KF0-770	COLLAR (6X4)	006
028	94251-06000	PIN, LOCK (6MM)	002
029	94305-25162	PIN, SPRING (2.5X16)	002
030	94540-07018	E-RING (7MM)	004
031	95701-06010-08	BOLT, FLANGE (6X10)	006
032	95701-06016-07	BOLT, FLANGE (6X16)	006
033	95701-06020-08	BOLT, FLANGE (6X20)	004
034	95701-08012-08	BOLT, FLANGE (8X12)	004