

# HONDA

## INSTALLATION INSTRUCTIONS

Accessory  
**NERF BAR**  
P/N: 08P74-HL6-A00

Application  
**SXS1000S2R**  
**SXS1000S2X**

Publication No.  
**MII 16561**  
Issue Date  
**March 2019**

### PARTS LIST

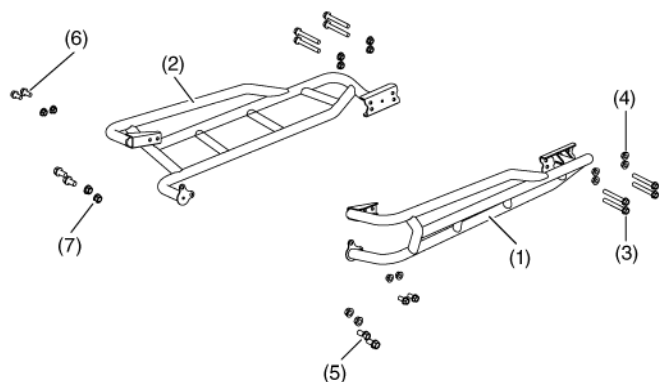

No.	Description	Qty
(1)	Passenger Nerf Bar	1
(2)	Driver Nerf Bar	1
(3)	8 x 60 mm Flange Bolt	8
(4)	8 mm Flange Nut	12
(5)	10 x 18 mm Flange Bolt	4
(6)	8 x 16 mm Flange Bolt	4
(7)	10 mm Flange Nut	4
(8)	Installation Instruction URL (not shown)	1

### TOOLS AND SUPPLIES REQUIRED

Torque Wrench  
Socket (10, 12, 14 mm)  
5 mm Hex Head Socket  
Open End Wrench (12, 14 mm)  
Cutting Tool

### TORQUE CHART

Tighten all screws, bolts, and nuts to their specified torque values. Refer to the Service Manual for the torque values of the removed parts.

Item	N·m	kgf·m	lbf·ft
8 mm Flange Bolt	27	2.7	19.9
10 mm Flange Bolt	39	4.0	28.8

### USE AND CARE INFORMATION

Check the accessory mounts frequently and retighten if necessary.

### INSTALLATION

1. Remove driver and passenger side floor protectors by removing eight mudguard clips from each side (as shown).

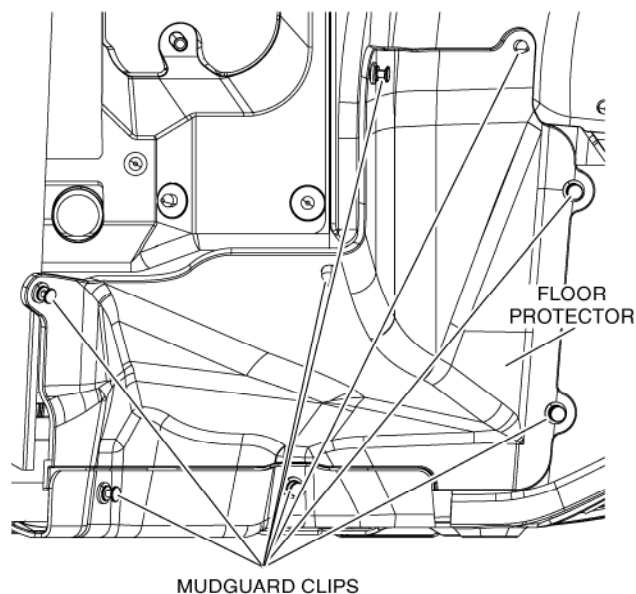

2. Remove driver and passenger side skid plates.
  - Eight mudguard clips (each side)
  - Four 6 mm flange bolts (each side)
  - Three 5 x 16 HEX screws (each side)

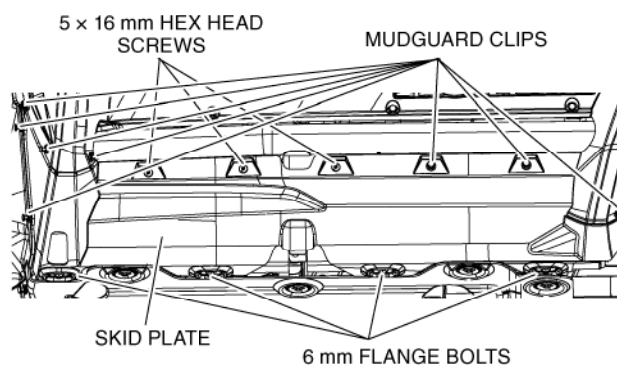

#### NOTE:

The rear over fender has two hooks requiring the driver and passenger side skid plates to be removed in a downward direction.

3. Remove the mid skid plate.
  - Seventeen 6 mm flange bolts

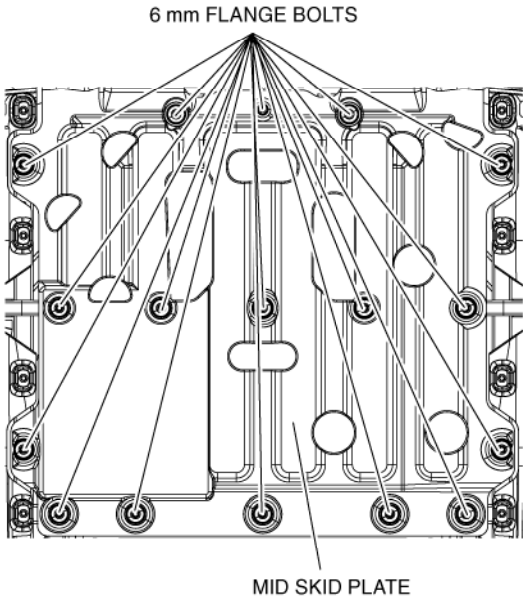

4. Use a cutting tool to trim the plastic from the driver and passenger side skid plates. Cut just inside of the scribe line (as shown).

**NOTE:**

Leave the scribe line unbroken then use a file to finish so not to remove too much material.

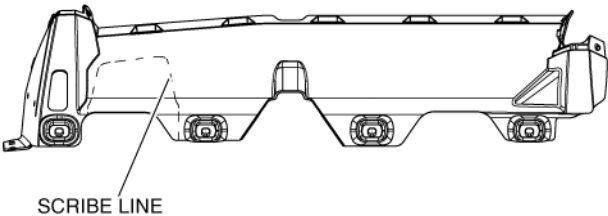

5. Reinstall driver and passenger side skid plates onto the vehicle. Use care to ensure the hooks on the rear over fender are installed into the slots on the driver and passenger side skid plates.
6. Carefully lift the driver side nerf bar into place then loosely install one 8 × 60 mm flange bolt, one 8 mm flange nut, one 8 × 16 mm flange bolt and one 8 mm flange nut to hold the bar in place. Insert and hand tighten the remaining 8 mm and 10 mm bolts and nuts.

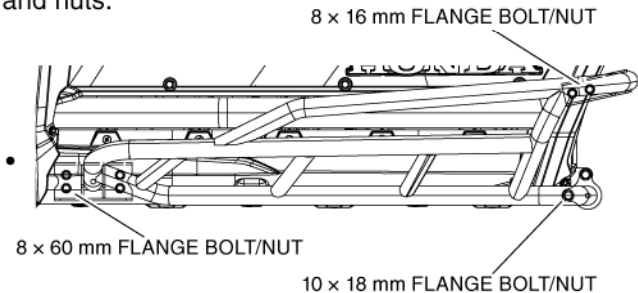

7. Tighten the 8 mm bolts in Area 1, then Area 2, then lastly tighten the 10 mm bolts in Area 3 (as shown). Tighten bolts/nuts to values shown on the Torque Chart.

**NOTE:**

AREA 1 nuts can be accessed from the underside of the vehicle.

Item	N-m	kgf-m	lbf-ft
8 mm Flange Bolt	27	2.7	19.9
10 mm Flange Bolt	39	4.0	28.8

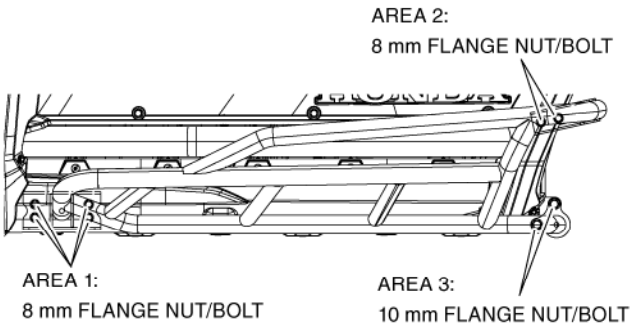

8. Install the passenger side nerf bar by repeating steps 6 and 7.
9. Reinstall the mid skid plate.
10. Reinstall the driver and passenger side floor protectors.