

## SHIFT SELECT LEVER/CABLE

### DISASSEMBLY/ASSEMBLY

Remove the instrument panel (page 2-23).

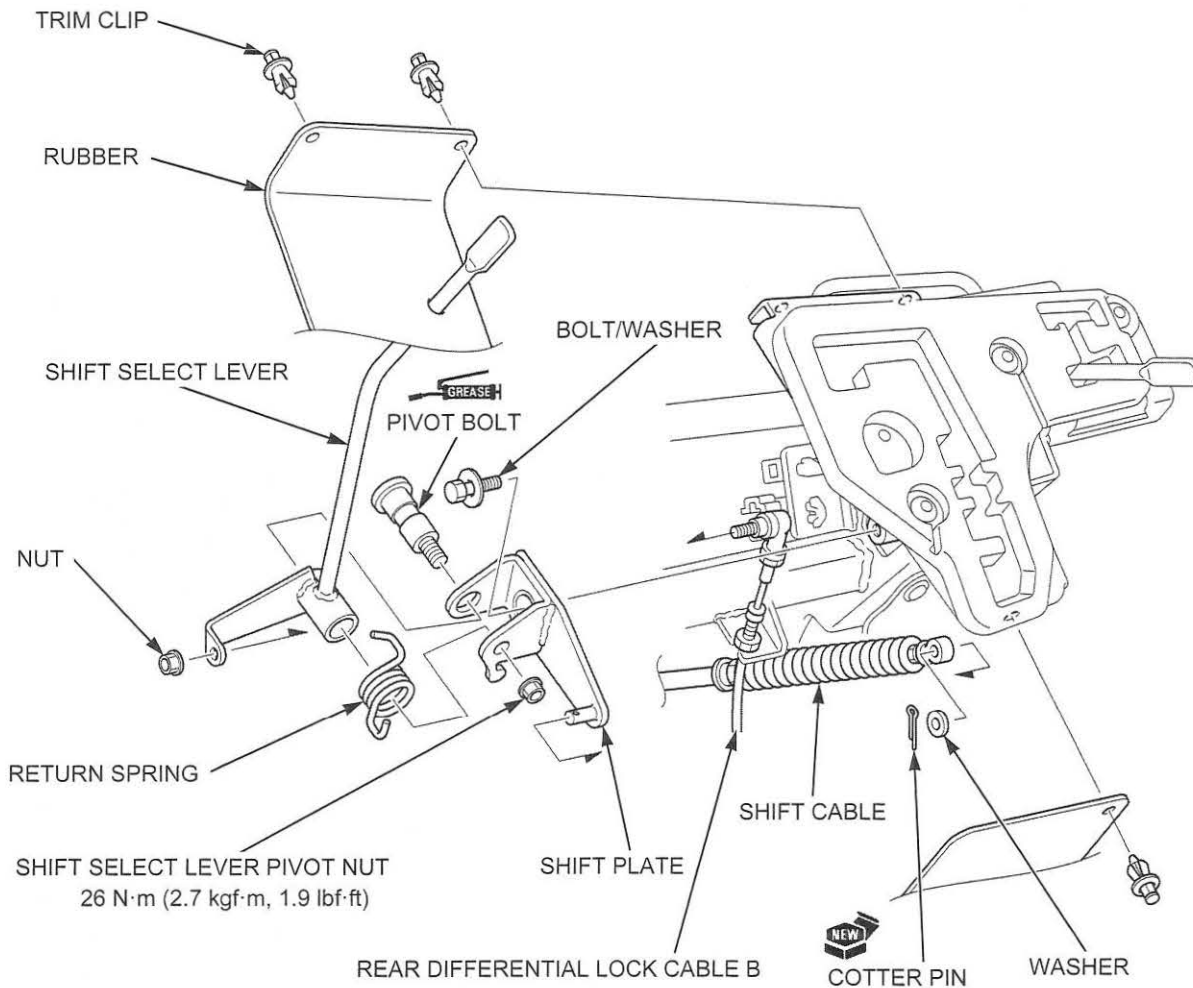

**NOTE:**

- Always replace the cotter pin with a new one.
- After installation, adjust the shift select lever freeplay (page 12-28).

### SHIFT SELECT LEVER FREEPLAY ADJUSTMENT

Remove the battery (page 22-4).

Remove the front seat cushion (page 2-4).

Remove the front fender lid [1].

