

SUB-TRANSMISSION

SHIFT SELECT LEVER/CABLE

DISASSEMBLY/ASSEMBLY

Remove the instrument panel (page 2-23).

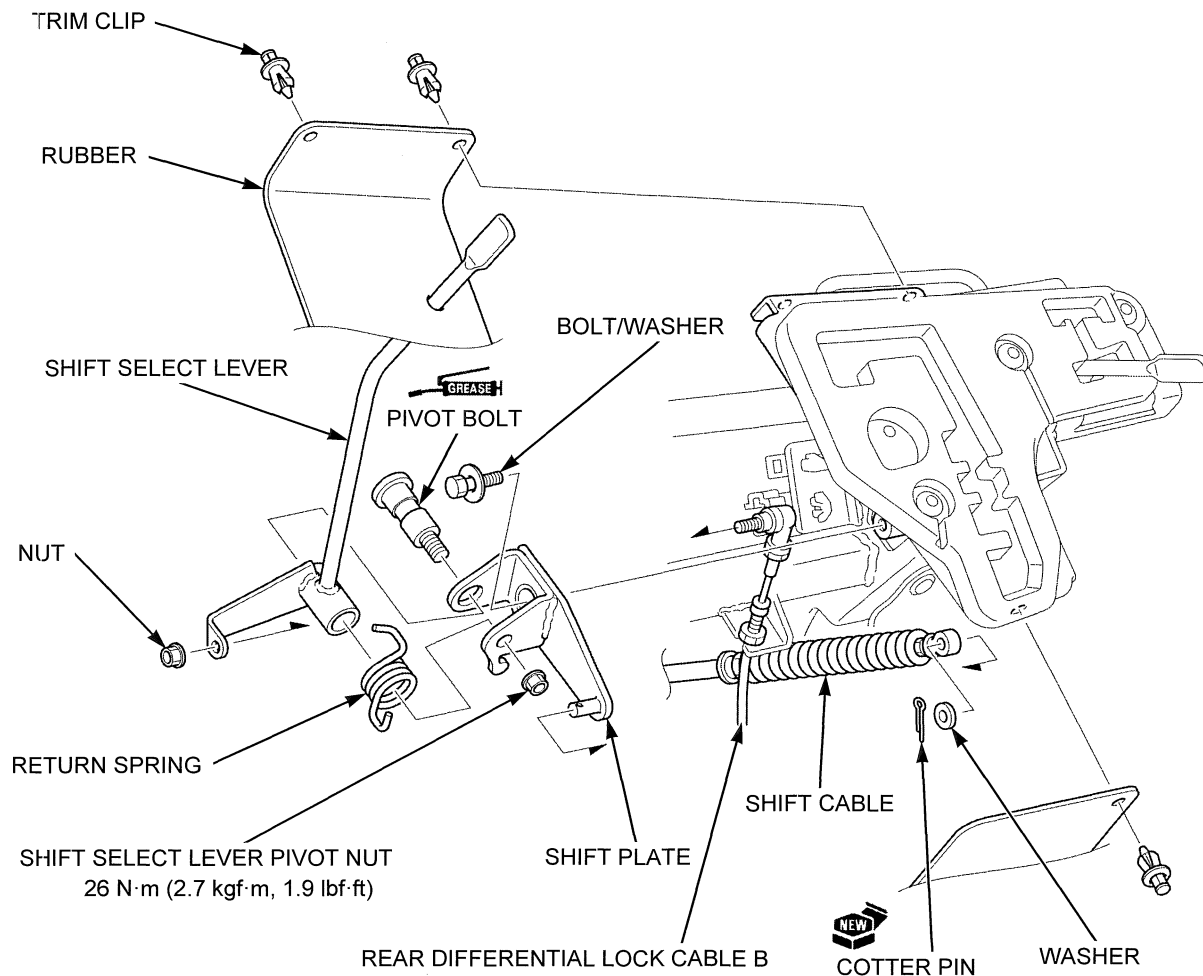

NOTE:

- Always replace the cotter pin with a new one.
- After installation, adjust the shift select lever freeplay (page 12-28).

SHIFT SELECT LEVER FREEPLAY ADJUSTMENT

Remove the battery (page 22-4).

Remove the front seat cushion (page 2-4).

Remove the front fender lid [1].

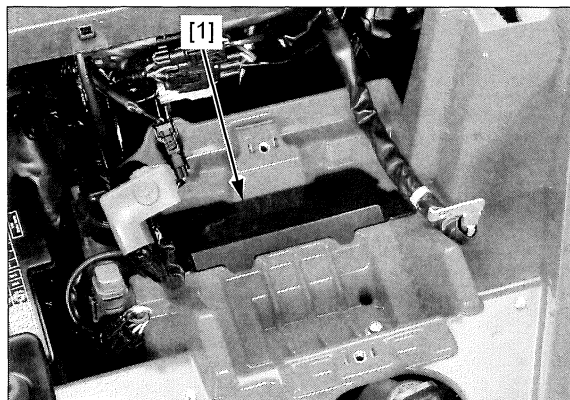

Move the shift select lever to the "N" (neutral) position.
Move the mode select lever to the "2WD" position.

Loosen the shift cable upper adjusting nut [1] and lower adjusting nut [2].

Temporarily install the battery (page 22-4).

Turn the ignition switch ON (I) and check that the gear position indicator indicates "N" (neutral).

If gear position indicator does not indicate "N" (neutral), operate the shift arm [3] by hand and shift the sub-transmission into the "N" (neutral) position.

Do not move the shift select lever from the neutral position.

Without applying force to move the cable, gradually screw the adjusting nuts together by hand until they touch the cable holder [4].

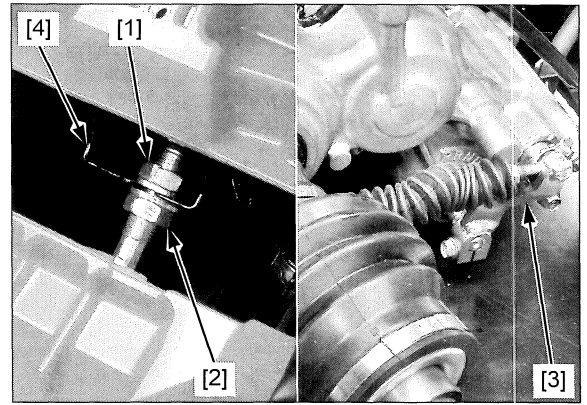

Adjust the shift select lever freeplay when the indicator indicates "N" (neutral) by turning the adjusting nuts [1].

FREEPLAY: More than 2 mm (0.01 in)

Tighten the nut while holding the other nut to the specified torque.

TORQUE: 26 N·m (2.7 kgf·m, 19 lbf·ft)

After adjustment, check that the shift select lever operates properly.

Install the removed parts in the reverse order of removal.

