



INSTALLATION INSTRUCTIONS

Accessory

SIDE MIRRORS
P/N 0SV05-HL4-202

Application

SXS1000M3/M5/M6

Publication No.

MII 15262

Issue Date

Revised: August 2022

Honda Dealer: Please give a copy of these instructions to your customer.

PARTS LIST

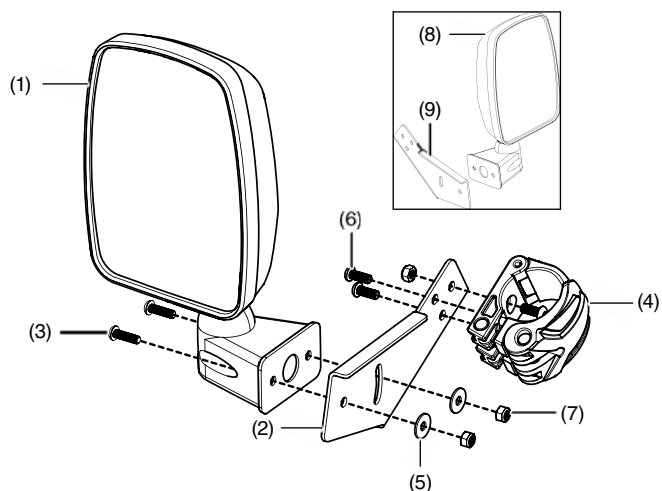

No.	Description	Qty
(1)	Left mirror	1
(2)	Left bracket	1
(3)	6 x 20 mm socket bolt	4
(4)	Cam lock	2
(5)	Washer	4
(6)	6 x 16 mm socket bolt	6
(7)	Lock nut	6
(8)	Right mirror	1
(9)	Right bracket	1

TOOLS AND SUPPLIES REQUIRED

4 mm hex wrench

10 mm socket wrench

TORQUE CHARTS

Tighten all screws, bolts, and nuts to their specified torque values. Refer to the Service Manual for the torque values of the removed parts.

Item	N·m	kgf·m	lbf·ft
6 x 20 mm bolt and lock nut	1	0.1	0.8
6 x 16 mm bolt and lock nut	5	0.5	4

USE AND CARE INFORMATION

- Check the accessory mounts frequently and retighten if necessary.
- Replace this accessory with a new one if it is damaged or discolored excessively.
- When this accessory becomes dirty, rinse it thoroughly with cool water to remove loose dirt, then wipe with a clean cloth or sponge.
- Never use petroleum solvents such as gasoline, thinner, benzine, acid, or alkaline cleaners.
- Side mirrors are not intended for on-road use.

INSTALLATION

NOTE:

- Remove and discard the rubber shipping band from the cam lock before installation of this accessory.

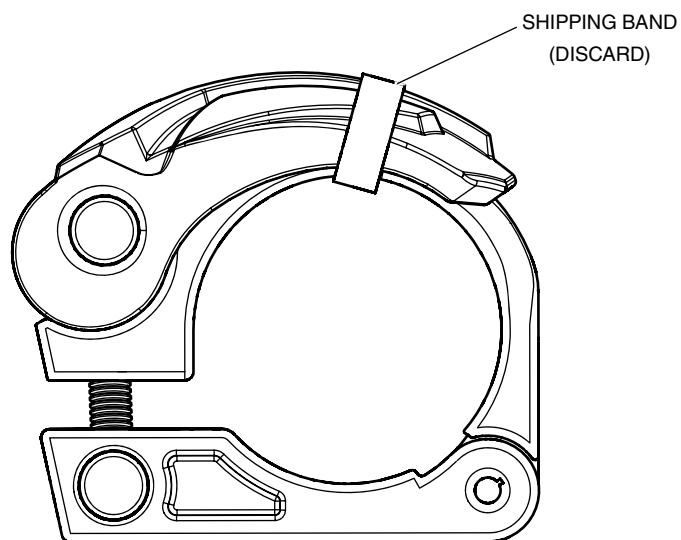

1. Insert one 6 x 16 mm socket bolt into the slot in the base of the cam lock and pass it through the hole in the bracket as shown.
2. Install a lock nut and tighten it to the value specified in the torque chart.
3. Install two 6 x 16 mm socket bolts through the holes in the bracket and into the base of the cam lock as shown.

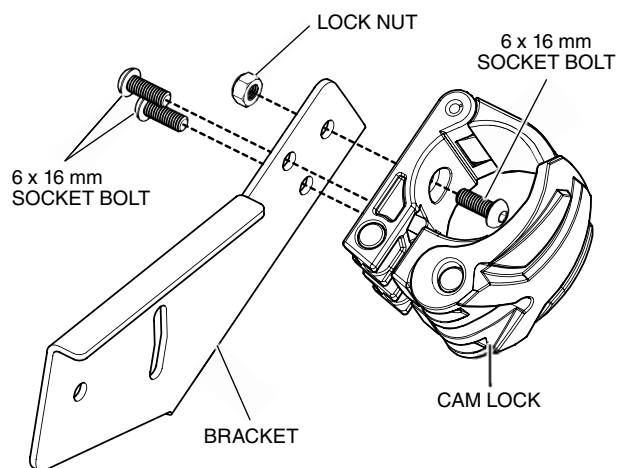

4. Insert two 6 x 20 mm socket bolts through the slots in the base of the mirror and pass them through the holes in the bracket as shown.
5. Install two washers and two lock nuts and tighten them to the value specified in the torque chart.

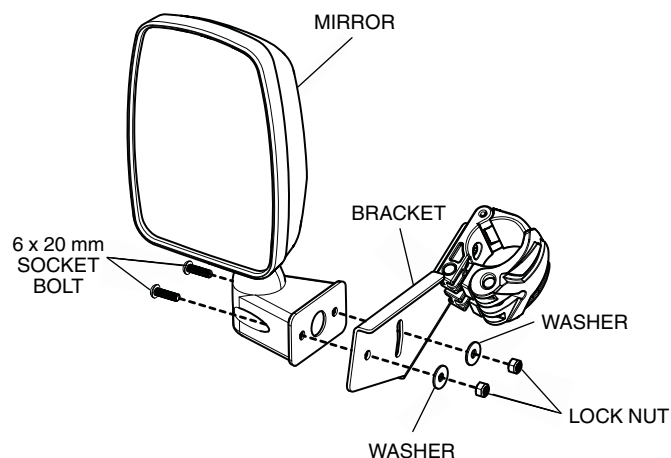

6. Clamp the assembled mirror onto the left A-pillar in the desired location.

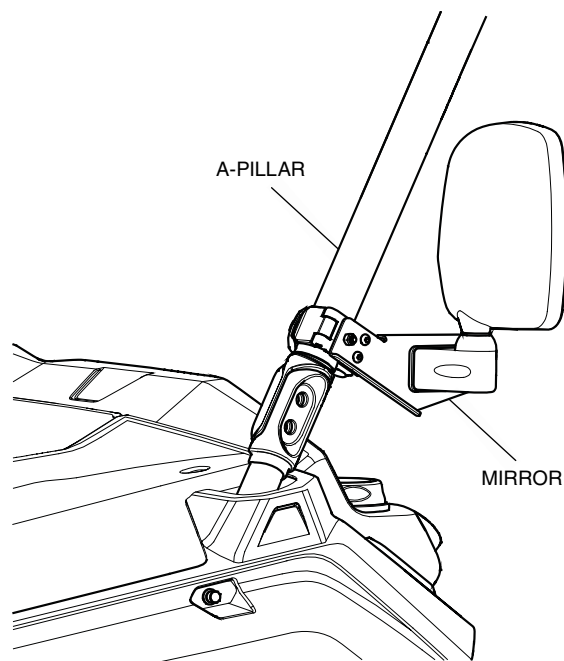

7. Adjust cam lock tension by rotating the threaded arm clockwise to tighten, counter-clockwise to loosen.

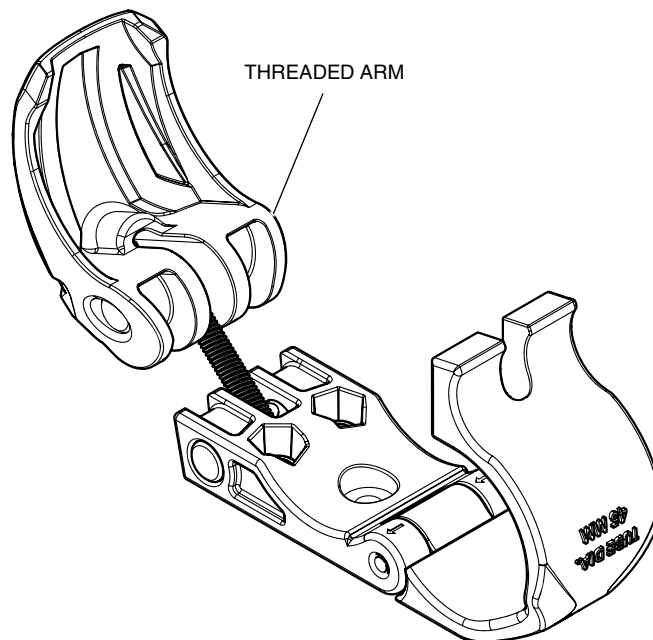

8. Repeat Steps 1 through 7 for the right side mirror.

INSTALLATION TO HARD DOOR

9. Remove the two existing 6 mm screws and washers from both doors in the location shown.

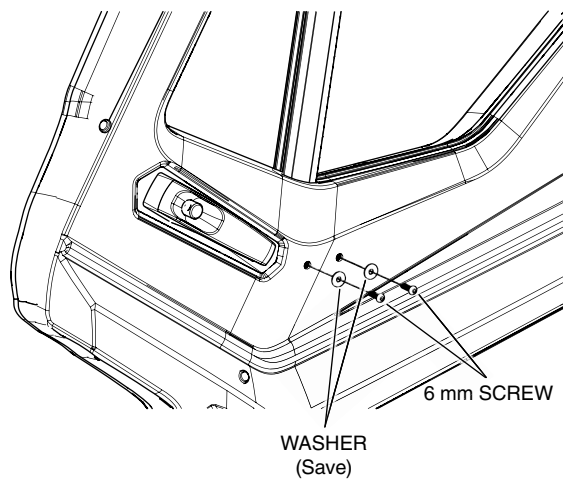

10. Install the mirror to the door using two 6 x 20 mm screws as shown.

Repeat the procedure on the other door.

