



INSTALLATION INSTRUCTIONS

Accessory
FABRIC UPPER DOORS
P/N 0SR90-HL7-A00

Application
SXS1000S4
SXS1000S4D

Publication No.
MII 17142
Issue Date
August 2019

Honda Dealer: Please give a copy of these instructions to your customer.

PARTS LIST

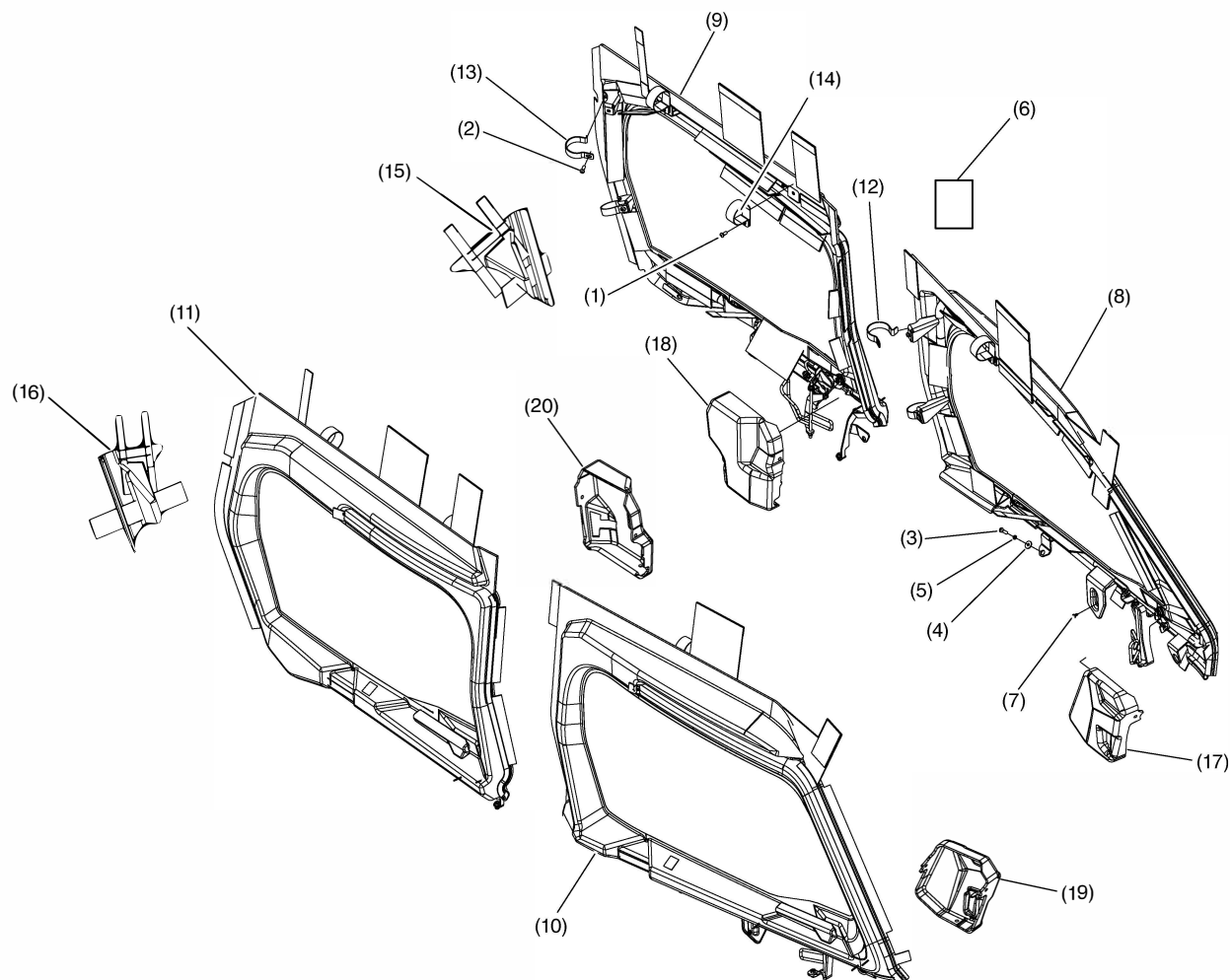

No.	Description	Qty
(1)	4 × 14 mm button head screw	4
(2)	4 × 16 mm button head screw	22
(3)	4 × 20 mm button head screw	4
(4)	Fender washer	4
(5)	Spring lock washer	4
(6)	Installation Instructions URL	1
(7)	Self-Tapping Phillips head screw	2
(8)	Driver side Front Upper Door	1
(9)	Driver side Rear Upper Door	1
(10)	Passenger side Front Upper Door	1

No.	Description	Qty
(11)	Passenger side Rear Upper Door	1
(12)	Front C-Clamp	4
(13)	Rear C-Clamp	4
(14)	P-Clamp	6
(15)	Driver side Rear corner	1
(16)	Passenger side Rear corner	1
(17)	Driver side Front Handle cover	1
(18)	Driver side Rear Handle cover	1
(19)	Passenger side Front Handle cover	1
(20)	Passenger side Rear Handle cover	1

TOOLS REQUIRED

4 mm Hex head socket
5 mm Hex head socket
6 mm Hex head socket
Phillips screwdriver
Two 7 mm open end wrenches
10 mm Socket
Torque wrench

TORQUE CHART

Tighten all screws, bolts, and nuts to their specified torque values. Refer to the Service Manual for the torque values of the removed parts.

Item	N·m	kgf·m	lbf·ft
4 × 14 mm button head screw	11	1.1	8.5
4 × 16 mm button head screw	11	1.1	8.5
4 × 20 mm button head screw	11	1.1	8.5
Self-Tapping Phillips head screw	1	0.1	0.8

INSTALLATION

⚠ CAUTION

1. Remove original bolts and original washers from roof.

ORIGINAL HARDWARE
Reuse at step 37.

ORIGINAL HARDWARE
Reuse at step 37.

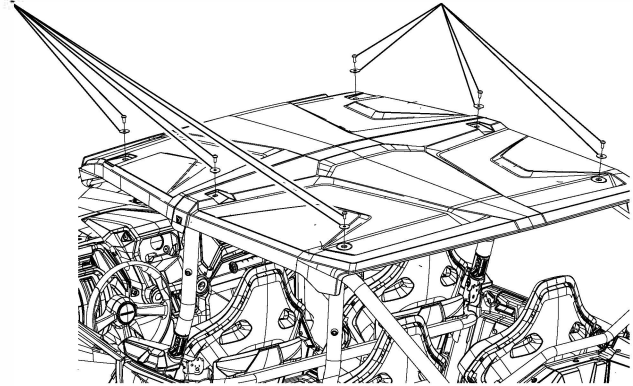

2. Remove original net attachment from front driver side door.

ORIGINAL NET
Reuse at step 11.

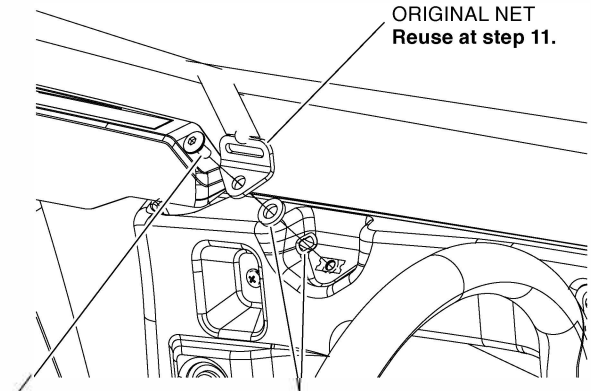

ORIGINAL HARDWARE
Save.

ORIGINAL HARDWARE
Reuse at step 11.

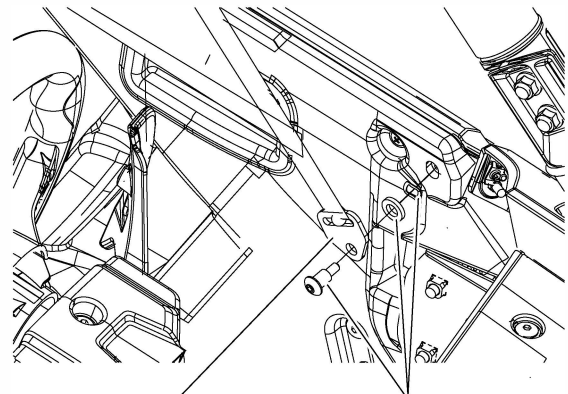

ORIGINAL NET
Reuse at step 12.

ORIGINAL HARDWARE
Reuse at step 12.

3. Remove original hardware from front driver side door.

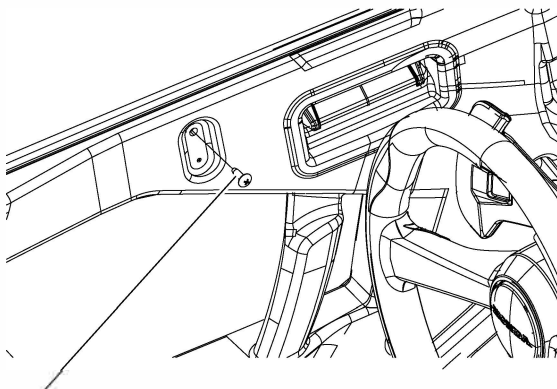

ORIGINAL HARDWARE
Reuse at step 7.

4. Install a P-Clamp on the top driver side OPS bar (as shown).

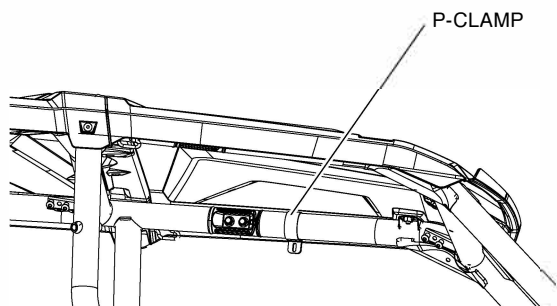

5. Install two Front C-Clamps on the vertical OPS tube (as shown).

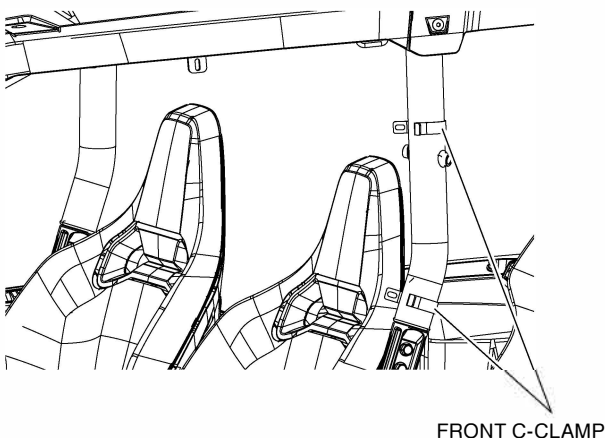

6. Place the front Fabric Upper Door on the original door making sure the top section is under the original roof.

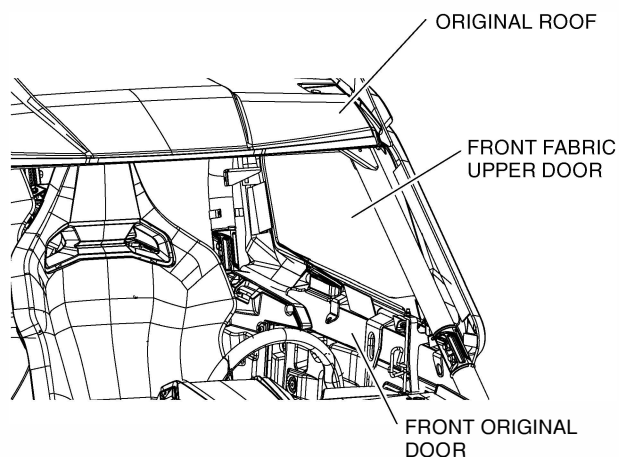

7. Wrap the upper strap on the Fabric Upper Door around the top ROPS bar (as shown).

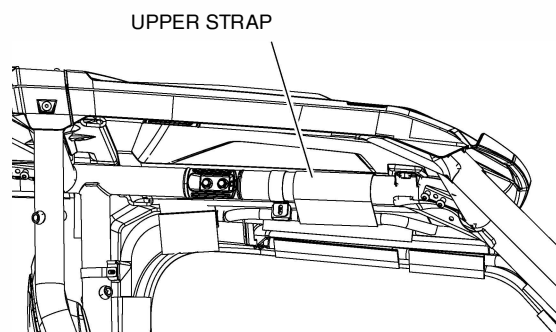

8. Use a Self-tapping Phillips head screw and the original bolt to secure the bracket on the Fabric Upper Door to the original door and tighten to the specification in the TORQUE CHART.

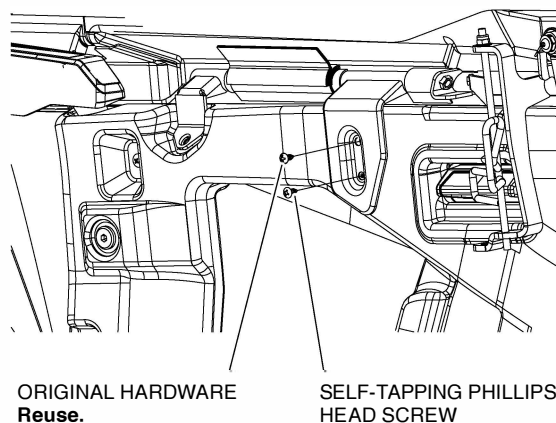

9. Unzip the window. Loosely install the driver side front Fabric Upper Door on the Front C-Clamp using two 4 x 16 mm button head screws.

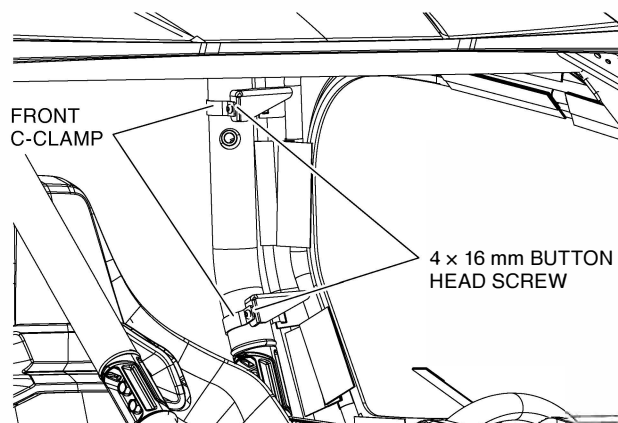

10. Install the Fabric Upper Door on the P-Clamp at the highest position possible then tighten.

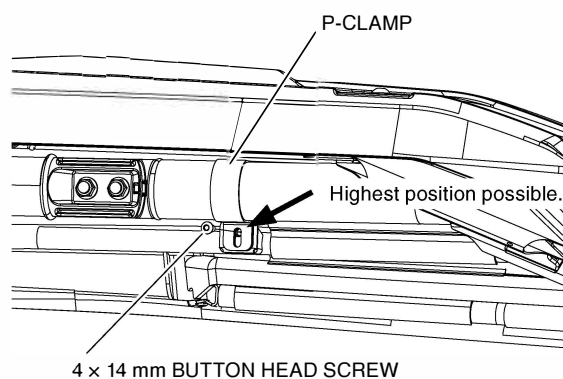

11. Install the original net on the door using the original hardware and a 4 x 20 mm button head screw, Spring Lock Washer and Fender Washer (as shown).

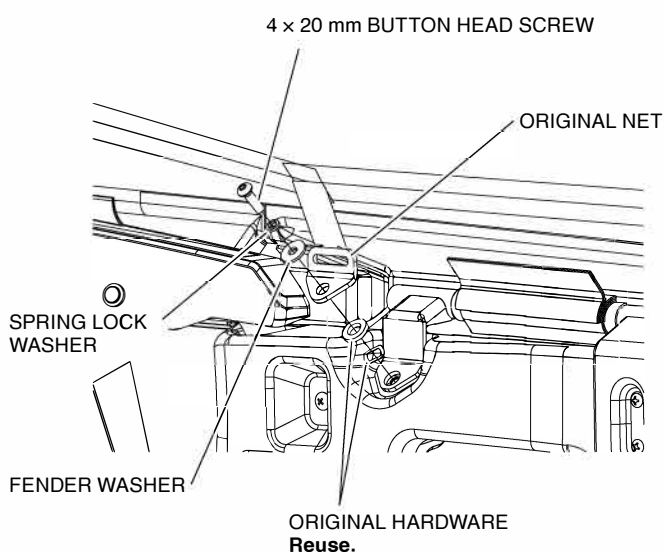

12. Install the original net on the door using the original hardware (as shown).

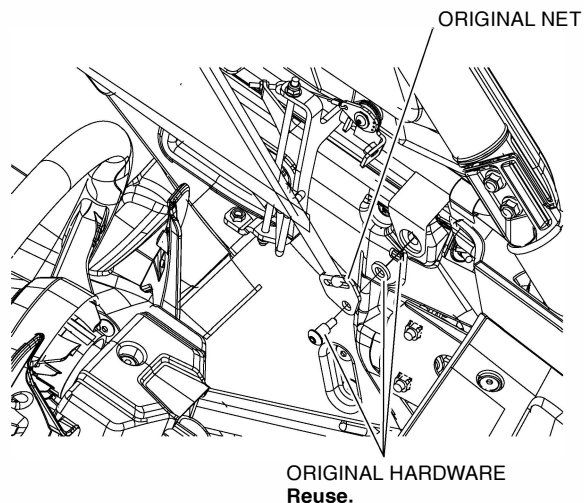

13. Tighten the previously installed hardware to the specification in the TORQUE CHART.

14. Wrap the front strap on the Fabric Upper Door around the front OPS tube then tighten as possible.

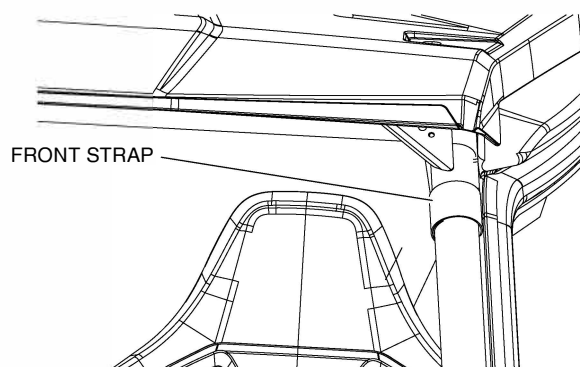

15. Position the handle so it fits in the hole. Adjust the pin up and down using the two flange nylon nuts to achieve the best fit.

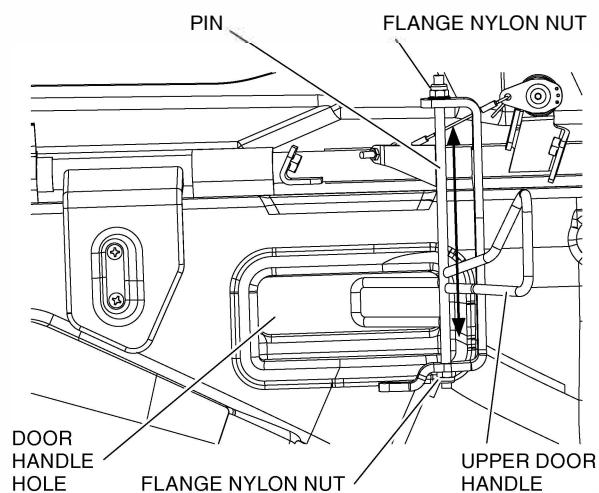

16. Set the tension on the Fabric Upper Door by adjusting the 4 mm nuts on the eyebolt (as shown). Make sure the outside handle works properly.

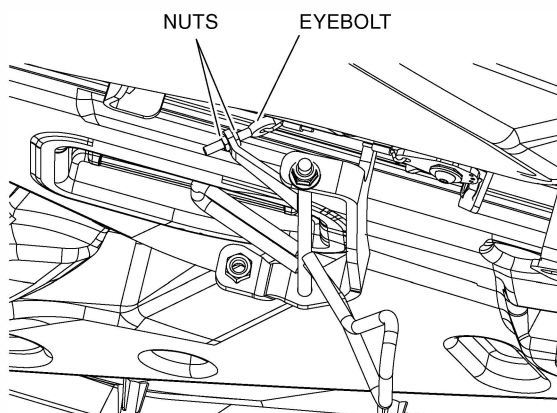

17. Install the Driver Side Front Handle Cover using three 4 × 16 mm button head screws (as shown).

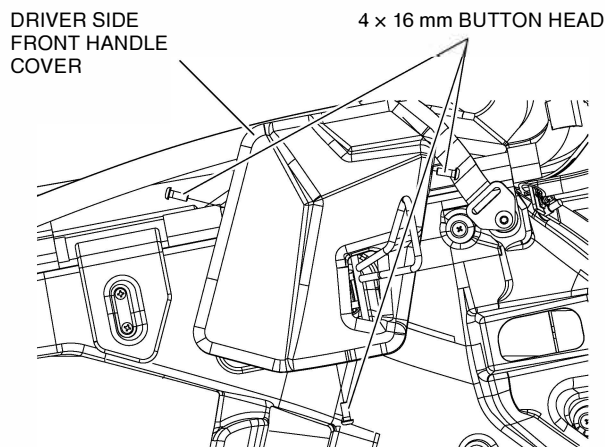

18. Remove original net attachment from rear driver side door.

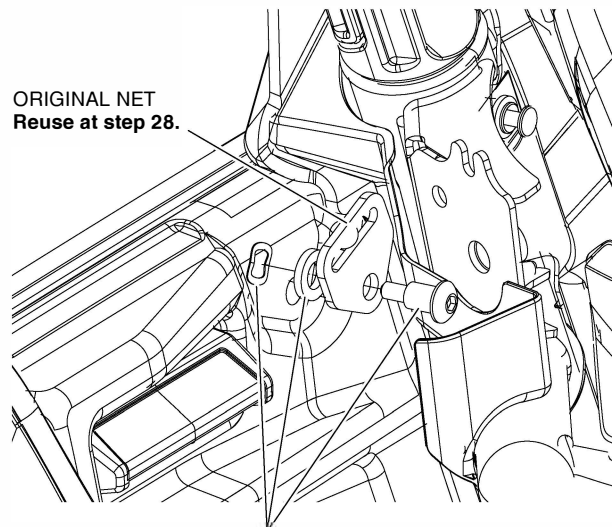
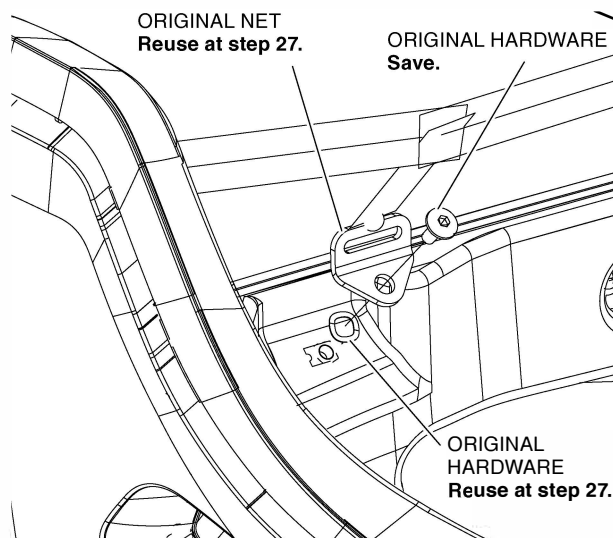

ORIGINAL HARDWARE
Reuse at step 28.

19. Remove the original hardware from external panel (as shown).

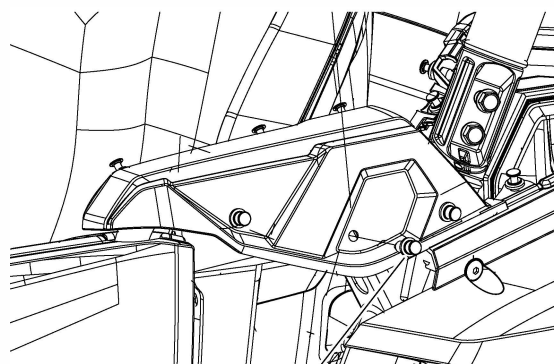

ORIGINAL HARDWARE
Reuse at step 26.

20. Install two P-Clamps on the top rear driver side OPS bar (as shown).

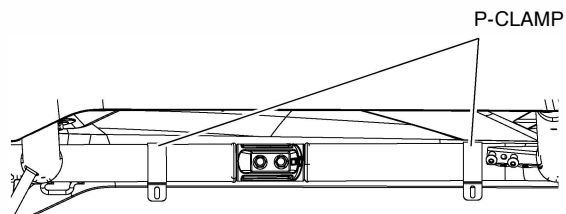

21. Install two Rear C-Clamps on the rear vertical OPS tube (as shown).

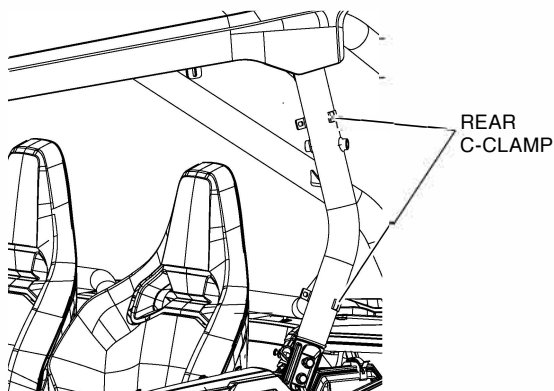

22. Place the rear Fabric Upper Door on the original door making sure the top section is under the original roof.

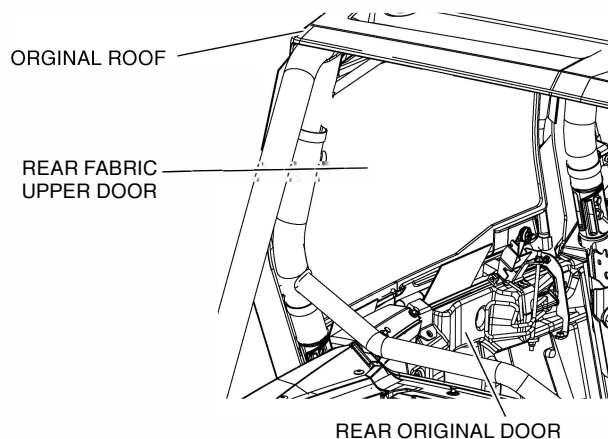

23. Wrap the two upper straps on the Fabric Upper Door around the rear top OPS bar (as shown).

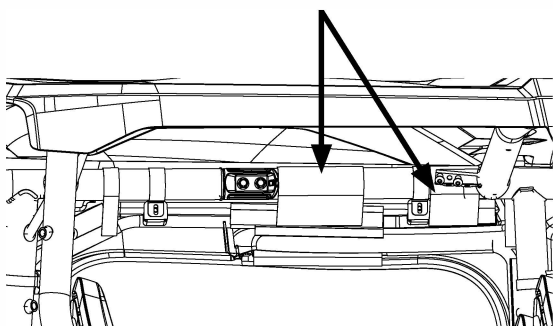

24. Install the original hardware on the external panel.

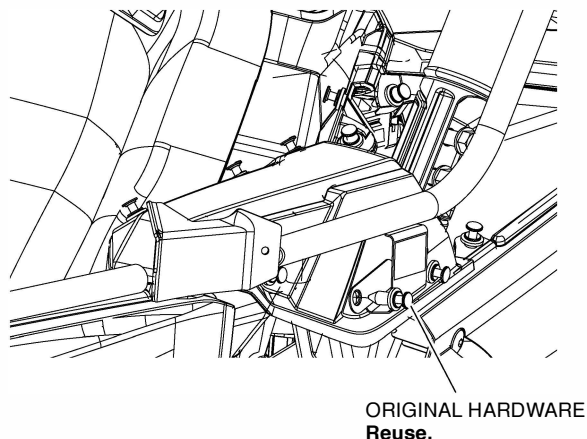

25. Unzip the window. Loosely install the driver side front Fabric Upper Door on the Rear C-Clamp using two 4 x 16 mm button head screw.

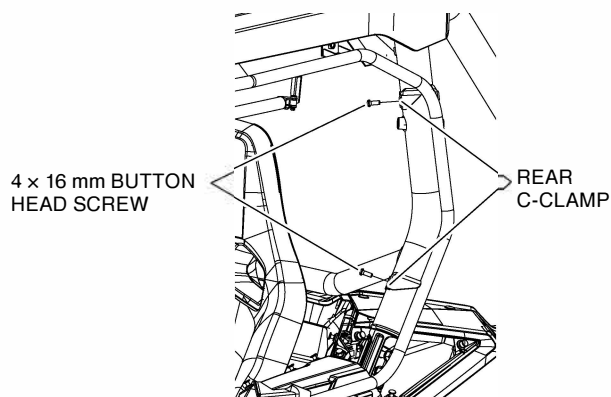

26. Install the Fabric Upper Door on the P-Clamp at the highest position possible using one 4 x 14 mm button head screw on the front clamp and one 4 x 16 mm button head screw on the rear clamp.

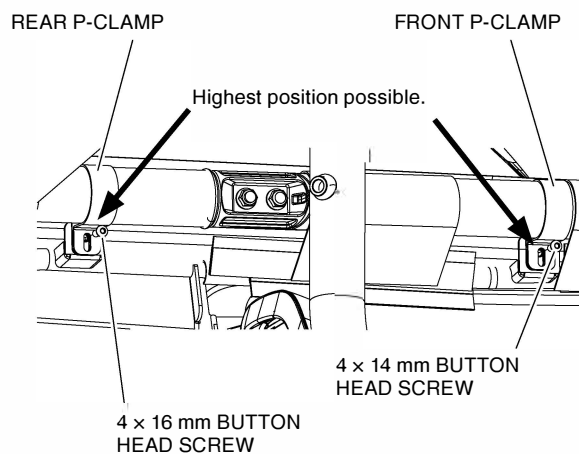

27. Install the original net on the door using the original hardware and a 4 × 20 mm button head screw, Spring Lock Washer and Fender Washer (as shown).

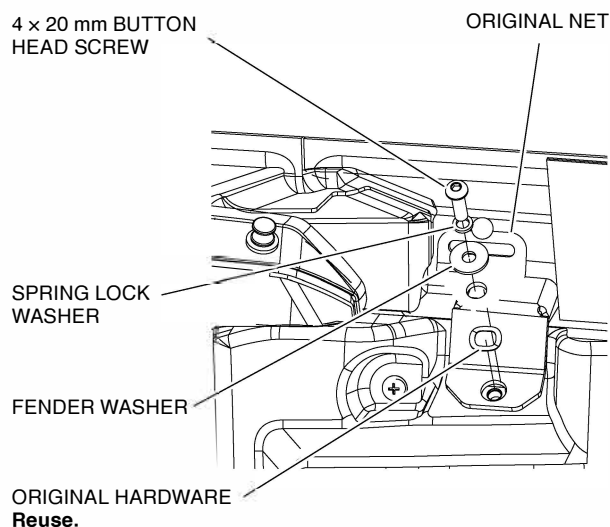

28. Install the original net on the door using the original hardware (as shown).

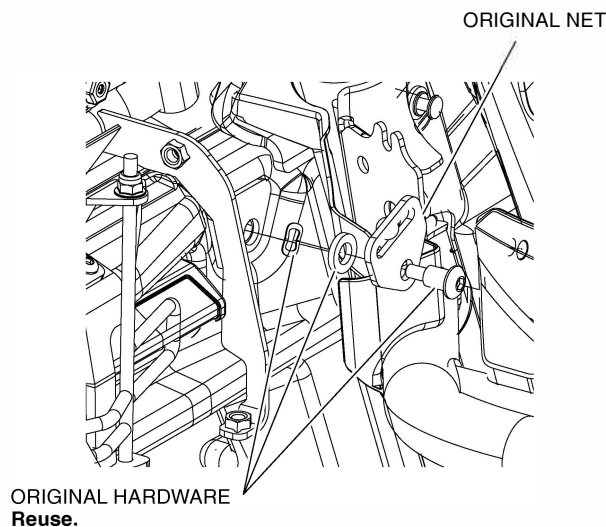

29. Tighten the previously installed hardware to the specification in the TORQUE CHART.

30. Position the handle so it fits in the hole. Adjust the pin up and down using the two flange nylon nuts to achieve the best fit.

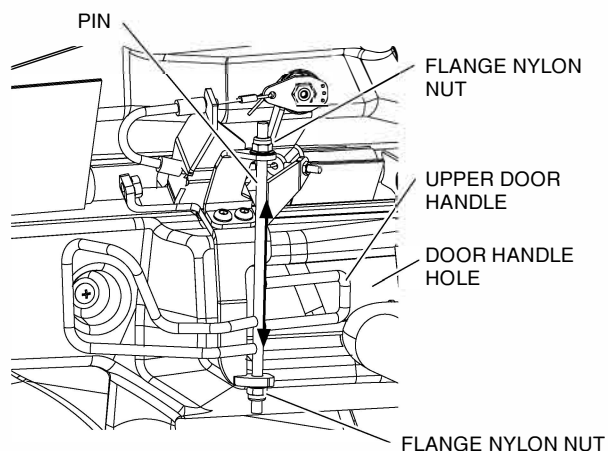

31. Set the tension on the Fabric Upper Door by adjusting the 4 mm nuts on the eyebolt (as shown). Make sure the outside handle works properly.

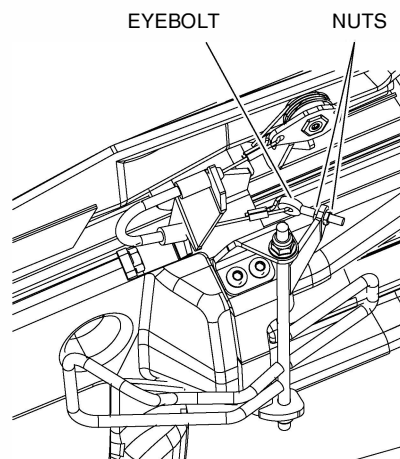

32. Install the Driver Side Rear Handle Cover using three 4 × 16 mm button head screws (as shown).

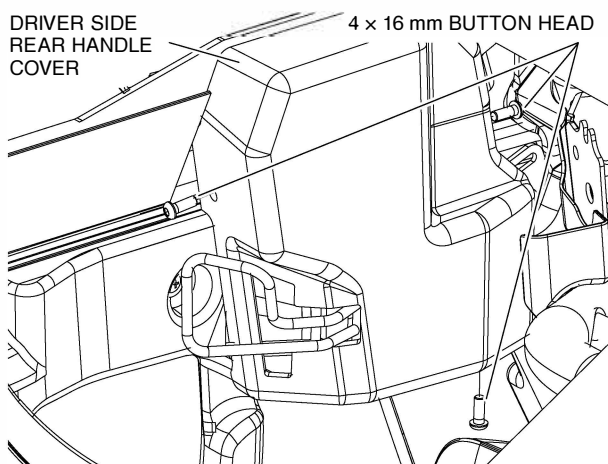

33. Attach the Driver Side Rear Corner to the Fabric Upper Door using the attachment strap (as shown).

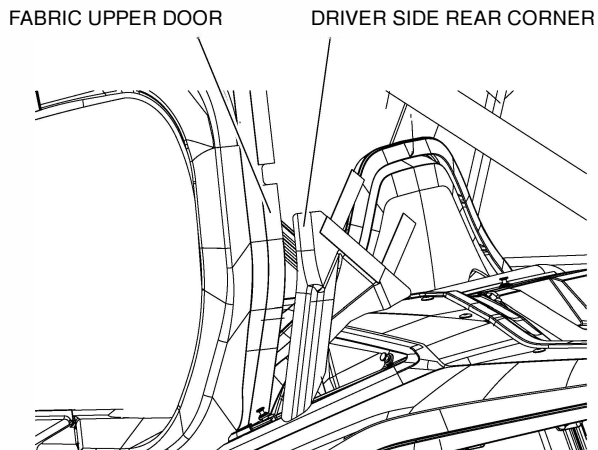

34. Attach the Fabric Upper Door, the Driver Side Rear Corner, and the Rear Panel (if installed) using the attachment strap (as shown).

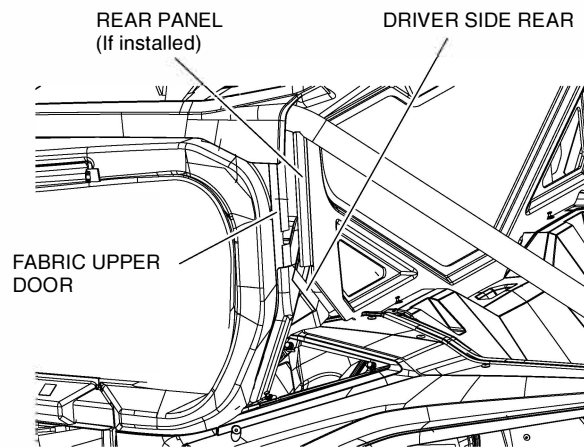

35. Adjust all the straps on the OPS bars and those on the Fabric Upper Door steel frame as needed to achieve the best fit.
36. Repeat step 2 through 35 on the passenger side doors.

37. Reinstall the roof using the original hardware.

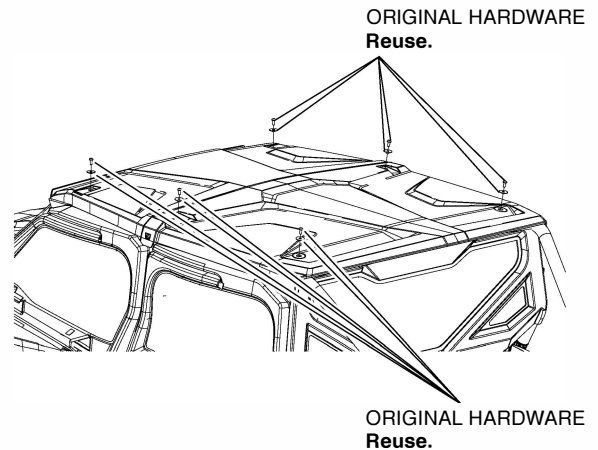

Replacement Parts List

FRONT DOORS / 4 DOORS

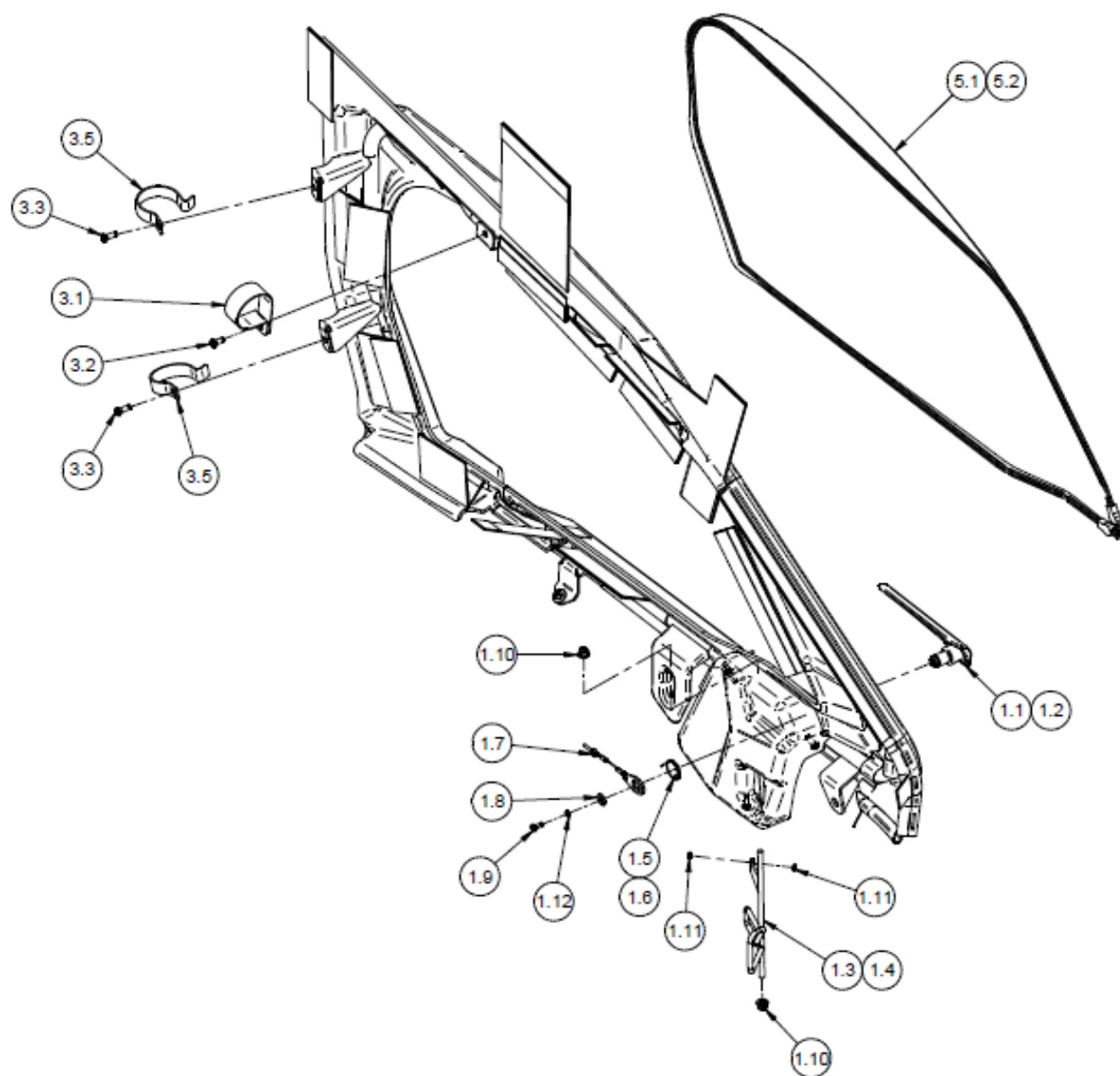

REAR DOORS / 4 DOORS

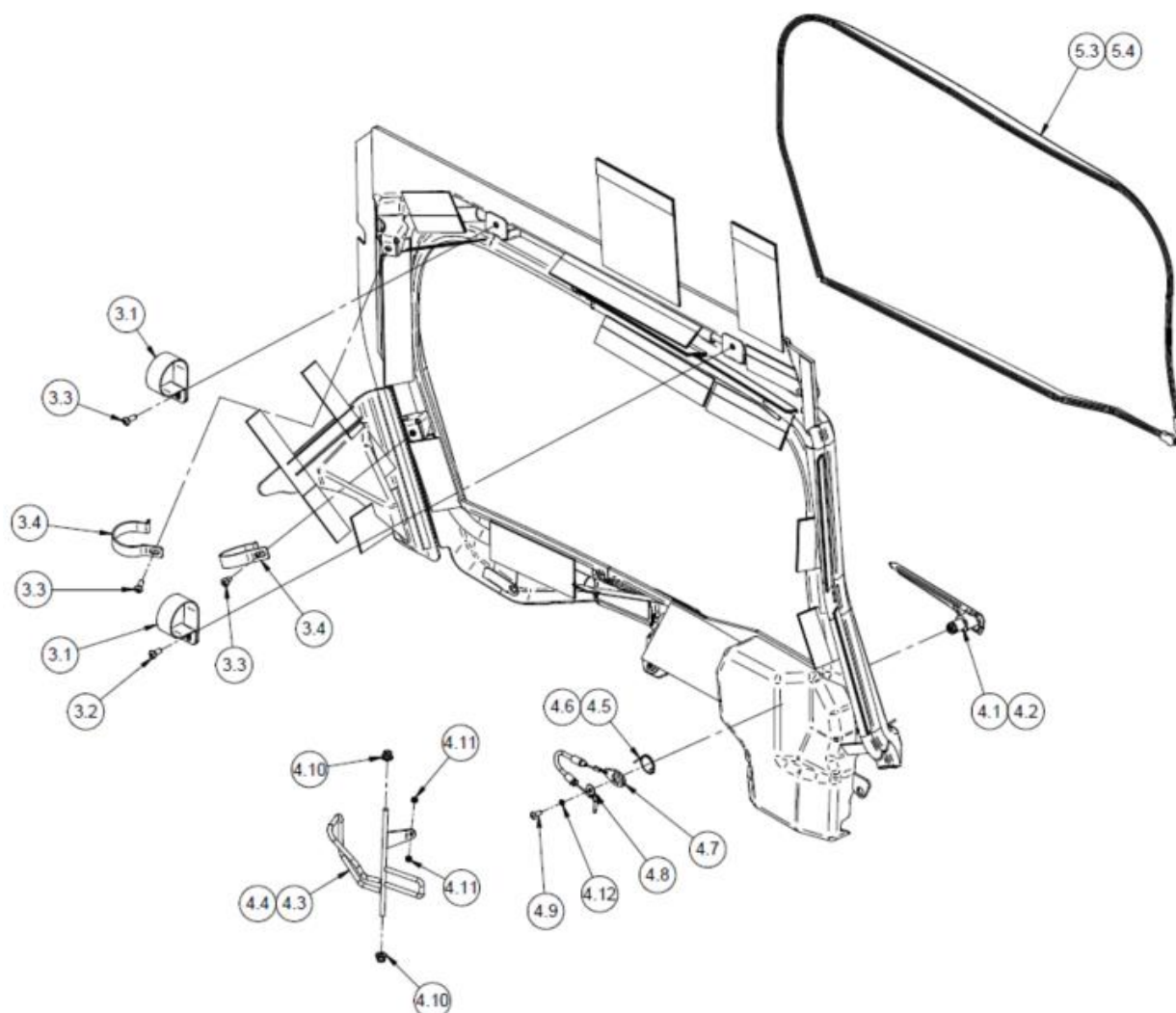

NO	DESCRIPTION	PART NUMBER	QTY
1	FRONT HANDLE SERVICE KIT (L/R) (4P)	OSR90-HL6-A0K1	1
1.1	OUTSIDE DRIVER SIDE HANDLE		1
1.2	OUTSIDE PASSENGER SIDE HANDLE		1
1.3	INSIDE DRIVER SIDE HANDLE		1
1.4	INSIDE PASSENGER SIDE HANDLE		1
1.5	DRIVER SIDE TORSION SPRING		1
1.6	PASSENGER SIDE TORSION SPRING		1
1.7	FRONT WIRE ASSEMBLY		2
1.8	FENDER WASHER M5		2
1.9	BUTTON HEAD M5-0.8 X 8MM		2
1.10	HEX NYLON NUT M6-1		4
1.11	HEX THIN NUT M4-0.7		4
1.12	SPRING LOCK WASHER M5		2

3	HARDWARE SERVICE KIT (2P/4P)	OSR90-HL6-A0K3	1
3.1	P-CLAMP 2" TUBE		6
3.2	BUTTON HEAD M6-1 X 14MM (4P P-CLAMP FRONT DOOR)		4
3.3	BUTTON HEAD M6-1 X 16MM		10
3.4	CLAMP HOOK		4
3.5	CLAMP HOOK FRONT DOOR (4P ONLY)		4
4	REAR HANDLE SERVICE KIT (L/R) (4P)	OSR90-HL7-A0K1	1
4.1	OUTSIDE DRIVER SIDE HANDLE		1
4.2	OUTSIDE PASSENGER SIDE HANDLE		1
4.3	INSIDE DRIVER SIDE HANDLE		1
4.4	INSIDE PASSENGER SIDE HANDLE		1
4.5	DRIVER SIDE TORSION SPRING		1
4.6	PASSENGER SIDE TORSION SPRING		1
4.7	REAR WIRE ASSEMBLY		2
4.8	FENDER WASHER M5		2
4.9	BUTTON HEAD M5-0.8 X 8MM		2
4.10	HEX NYLON NUT M6-1		4
4.11	HEX THIN NUT M4-0.7		4
4.12	SPRING LOCK WASHER M5		2
5	VINYL WINDOW SERVICE KIT (4P)	OSR90-HL7-A0K2	1
5.1	FRONT DRIVER SIDE VINYL WINDOW		1
5.2	FRONT PASSENGER SIDE VINYL WINDOW		1
5.3	REAR DRIVER SIDE VINYL WINDOW		1
5.4	REAR PASSENGER SIDE VINYL WINDOW		1